



BID TALK

Madison Municipal Building Flagpole Replacement

City of Madison Engineering Division
July 30, 2025

Thank you for attending. We will begin shortly...

CITY OF **MADISON**



Meeting Technical Housekeeping

- This meeting will be **recorded** and posted to the project page.
- All attendees should be **muted** to keep background noise to a minimum.
- Use the **“chat”** button for technical issues with meeting to troubleshoot with staff to assist.
- Use the **“Q and A”** button to type questions about presentation. Questions will be answered live after the presentation.
- Inappropriate questions may be dismissed.
- Use the **“raise your hand”** button to verbally ask your question. You will be prompted to unmute when it is your turn.

This meeting is being recorded.

It is a public record subject to disclosure.

By continuing to be in the meeting, you are consenting to being recorded and consenting to this record being released to public record requestors.

CITY OF **MADISON**



Project Location

Madison Municipal Building
215 Martin Luther King Jr Blvd.

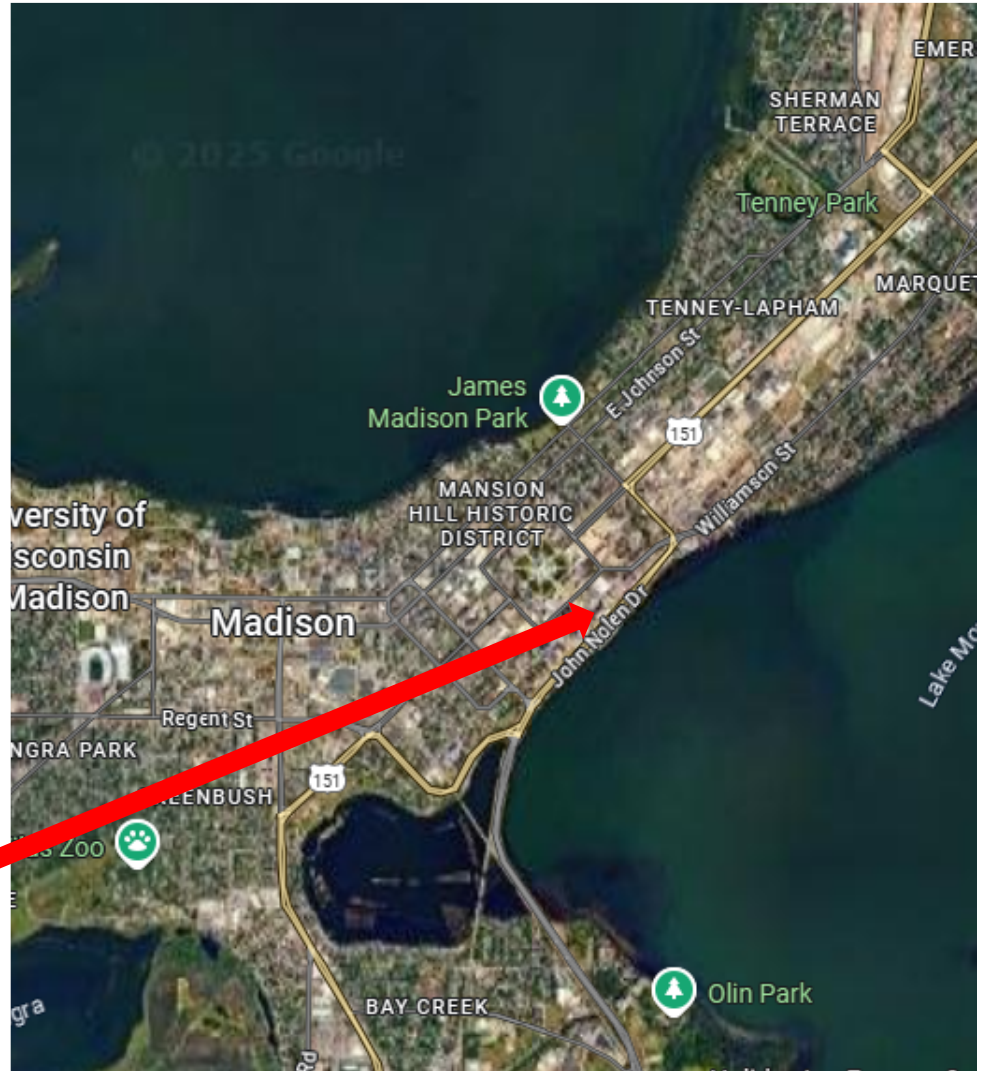

Project Location

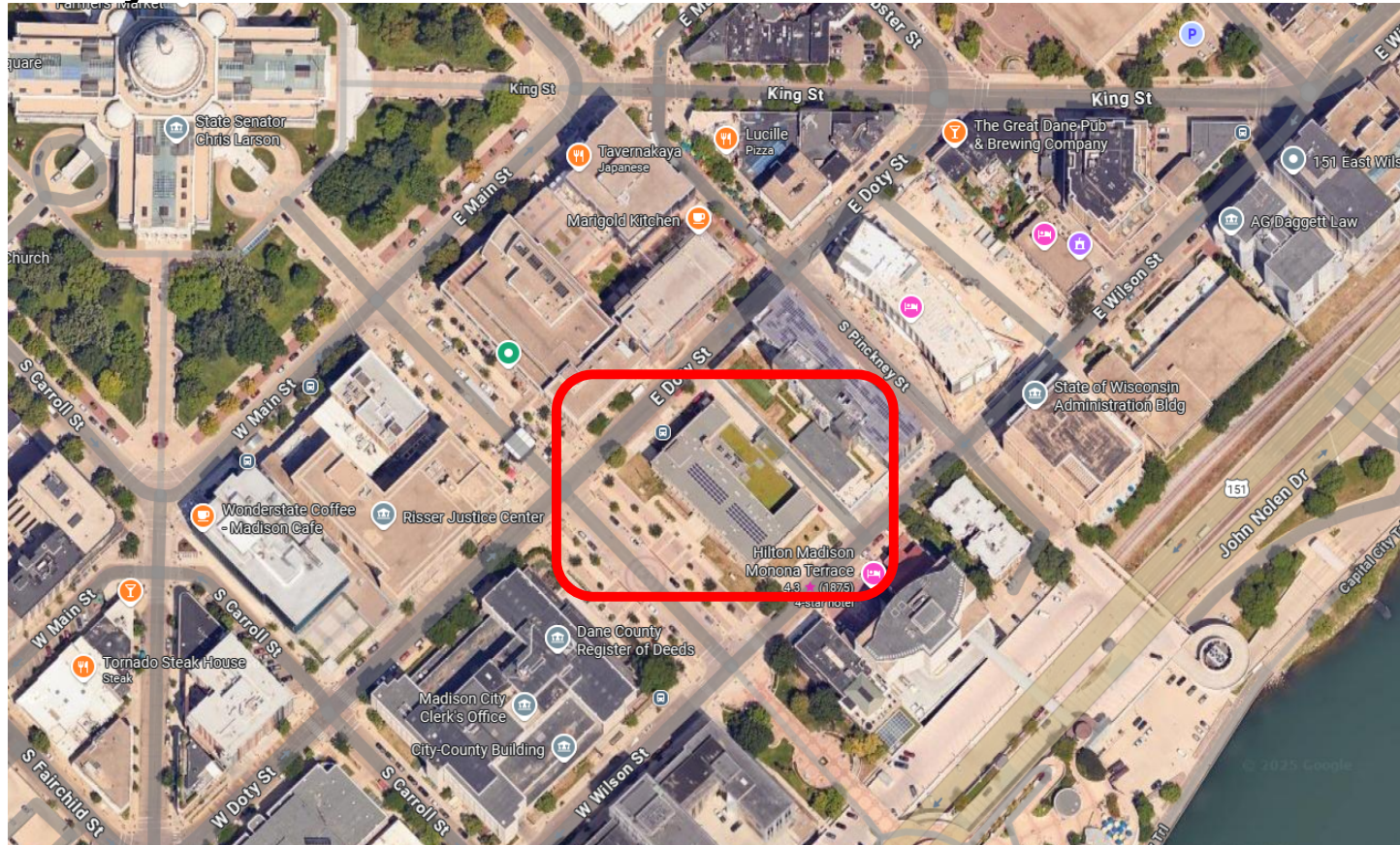

CITY OF **MADISON**



Project Location



CITY OF **MADISON**



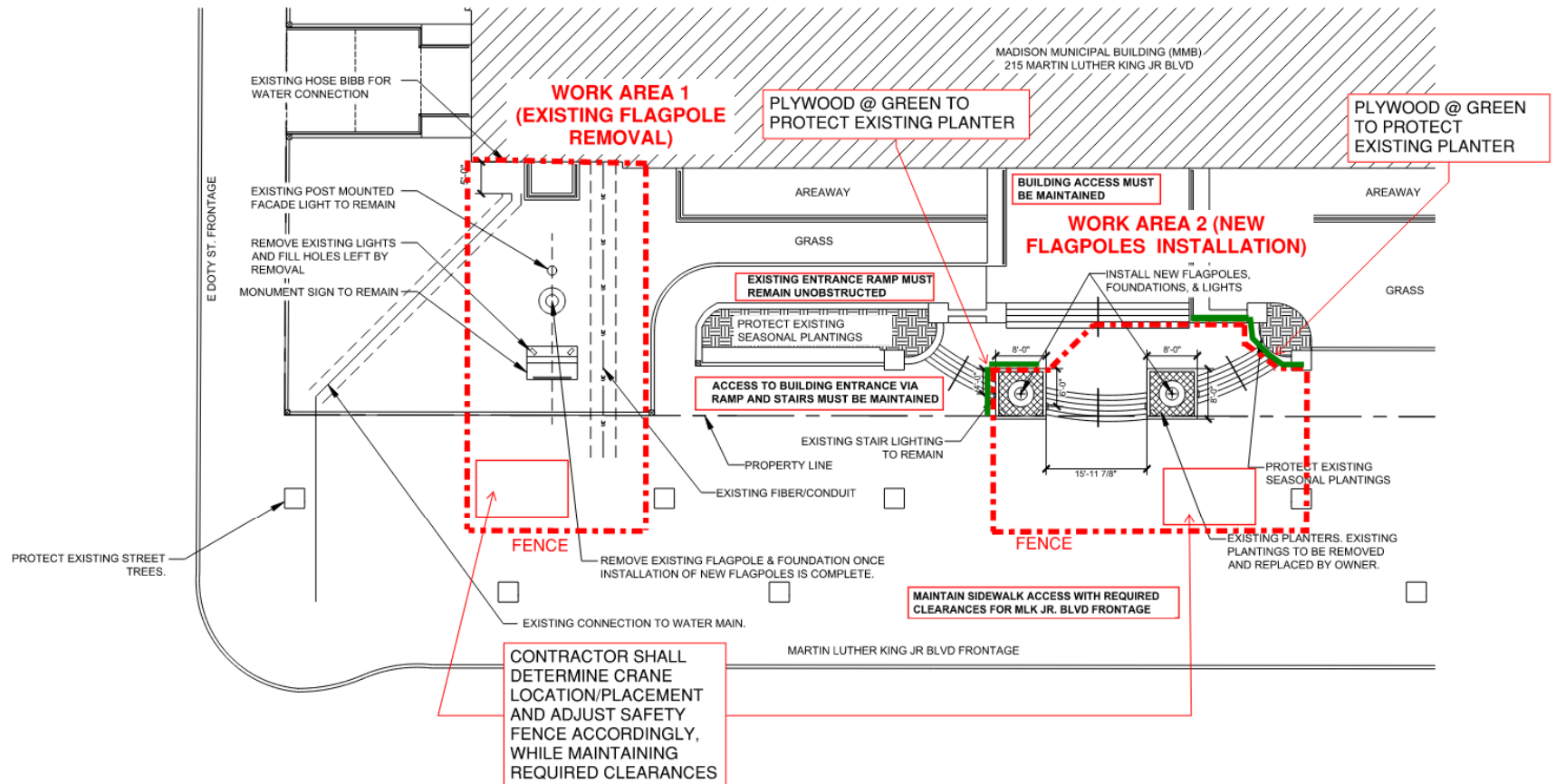

REF DOC 1 - LANDS FOR WORK JULY 10, 2025



LANDS FOR WORK
SCALE: 3/16" = 1'-0"

LANDS FOR WORK

1. NO TOBACCO PRODUCT USE IS ALLOWED ON THE PROPERTY.
2. WORK SHALL BE PERFORMED MONDAY-FRIDAY BETWEEN THE HOURS OF 7:00 A.M. TO 5:00 P.M. UNLESS OTHERWISE APPROVED BY THE CITY PROJECT MANAGER.
3. CONTRACTOR MAY PARK CONSTRUCTION RELATED VEHICLES TO THE LEFT/WEST IN BUILDING DRIVEWAY OFF E. WILSON ST. DO NOT BLOCK ACCESS TO EXTERIOR DOORS.
4. VEHICLES MAY NOT BE PARKED IN THE GRASS.
5. PROTECT EXISTING PAVING FROM HEAVY VEHICLES AND OIL OR CHEMICAL LEAKS.
6. PROTECT EXISTING PAVING FROM HEAVY VEHICLES AND OIL OR CHEMICAL LEAKS.
7. WATER IS AVAILABLE ON SITE VIA HOSE BIBB SHOWN ON PLAN, ELECTRICAL SERVICE IS AVAILABLE VIA INTERIOR ELECTRICAL OUTLETS.

GENERAL NOTES

1. CONTRACTOR SHALL DETERMINE CRANE LOCATION/PLACEMENT & ADJUST SAFETY FENCE ACCORDINGLY WHILE MAINTAINING REQUIRED SIDEWALK CLEARANCES. SEE LANDS FOR WORK DIAGRAM FOR CLEARANCES.
2. REPAIR/REPLACE IN KIND THOSE CONCRETE ELEMENTS THAT WERE MODIFIED FOR THE WORK OF THE CONTRACT.
3. ALL DIMENSIONS AND SITE CONDITIONS TO BE VERIFIED BY CONTRACTOR BEFORE COMMENCEMENT OF WORK.
4. FIBER CONDUIT AND WATER MAIN SHALL BE PROTECTED DURING ALL ASPECTS OF WORK.
5. FLAGPOLE BASIS OF DESIGN: EDER FLAG COMPANY, 6063T6 ALUMINUM FLAGPOLE 55' LONG WITH 10" BUTT DIAM, 4" TOP DIAM, AND 0.188" THICK.
6. APPLY COATING TO BOTTOM 7'-0" OF FLAGPOLE. FOLLOW MFR. INSTRUCTIONS FOR SURFACE PREP AND APPLICATION. BASIS OF DESIGN: KARNAK 118 BLACK ASPHALTUM



Project Images



CITY OF **MADISON**



Project Images



CITY OF **MADISON**



Project Images



CITY OF **MADISON**





CITY OF MADISON
DEPT OF PUBLIC WORKS
ENGINEERING DIVISION
1215 MARTIN LUTHER KING JR BLVD
MADISON, WI 53703
PHONE: 608/264-4333

MADISON MUNICIPAL BUILDING
FLAGPOLE REPLACEMENT
215 MARTIN LUTHER KING JR. BLVD 53703

CONTRACT
#9670
MUNIS
#15642
DRAWN BY: JRE
DATE: 07/10/2025
REV: 07/10/2025

SHT
A1

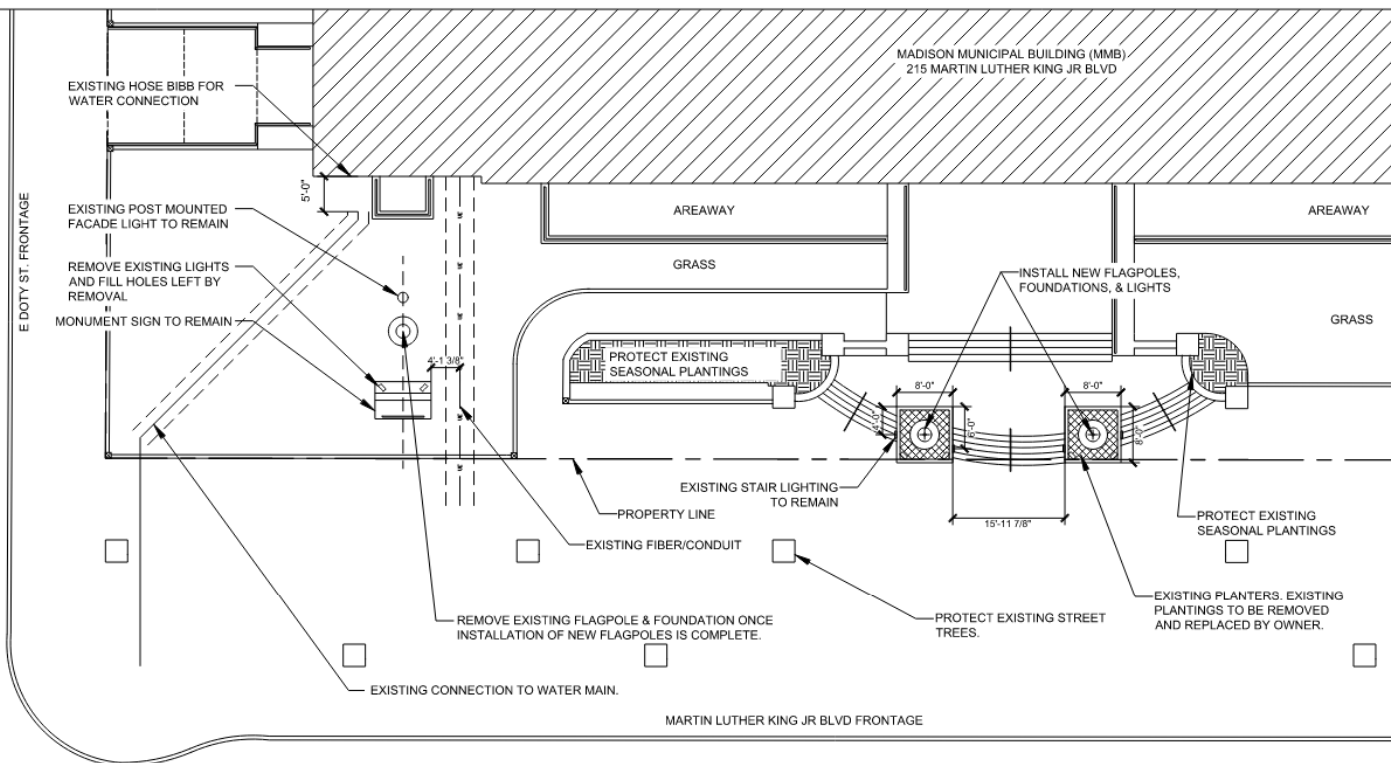

PROPOSED

1. CONTRACTOR SHALL DETERMINE CRANE LOCATION/PLACEMENT & ADJUST SAFETY FENCE ACCORDINGLY WHILE MAINTAINING REQUIRED CLEARANCES. SEE LANDS FOR WORK DIAGRAM FOR CLEARANCES.
2. REPAIR/REPLACE IN KIND THOSE CONCRETE ELEMENTS THAT WERE MODIFIED FOR THE WORK OF THE CONTRACT.
3. ALL DIMENSIONS AND SITE CONDITIONS TO BE VERIFIED BY CONTRACTOR BEFORE COMMENCEMENT OF WORK.
4. FIBER CONDUIT AND WATER MAIN SHALL BE PROTECTED DURING ALL ASPECTS OF WORK.
5. FLAGPOLE BASIS OF DESIGN: EDER FLAG COMPANY, 6063T6 ALUMINUM FLAGPOLE 55' LONG WITH 10" BUTT DIAM, 4" TOP DIAM, AND 0.188" THICK.
6. APPLY COATING TO BOTTOM 7'-0" OF FLAGPOLE. FOLLOW MFR. INSTRUCTIONS FOR SURFACE PREP AND APPLICATION. BASIS OF DESIGN: KARNAK 118 BLACK ASPHALTUM

DEMO

1. REMOVE EXISTING FLAGPOLE, FOUNDATION, AND LIGHTING AFTER NEW FLAGPOLES ARE INSTALLED AND OPERATIONAL.
2. PATCH/FILL HOLES LEFT BY LIGHT REMOVAL ON MONUMENT SIGN WITH CONCRETE. CLEAN OFF ANY EXCESS CONCRETE SO THAT POROUS STONE SURFACE REMAINS.
3. ENSURE PROTECTION OF EXISTING UTILITIES IN THE WORK AREA.
4. PROVIDE FILL AND REINSTATE LEVEL GRADE CONDITION IN AREA OF EXCAVATION. COMPACT FILL TO ENSURE AREA WILL PROVIDE STABLE SUBSURFACE THAT WILL NOT SETTLE.
5. SEED OVER ALL DISTURBED AREAS. PROVIDE 6" (MIN.) TOPSOIL PRIOR TO SEEDING WHERE DISTURBANCE HAS REMOVED EXISTING TOPSOIL. OVERSEED EXISTING, UNDISTURBED LAWN AREAS AS NECESSARY. APPLY EROSION CONTROL MAT, CLASS 1- TYPE A URBAN OVER ALL AREAS TO BE SEED.
6. PROVIDE APPROPRIATE EROSION CONTROL PROTECTIONS IN WORK AREAS.



DEMOLITION & PROPOSED SITE PLAN

SCALE: 1/16" = 1'-0"



2. THE EXCAVATION WILL FURTHER PROCEED DOWN TO THE FINAL BEARING ELEVATION BY MEANS/METHOD AS PROPOSED BY THE SELECTED CONTRACTOR. A STEEL/ CONCRETE SLEEVE SHALL BE USED AT THE DIAMETER OF THE FOUNDATION REQUIRED TO RESIST ANY CAVING FORCES BY SOILS BENEATH THE EXISTING FOUNDATION. THE DESIGN OF THIS SLEEVE (SHORING) IS A DELEGATED DESIGN TO BE PROVIDED FOR REVIEW TO THE ENGINEERING TEAM BY THE SELECTED CONTRACTOR.



CLASS B TENSION LAP SPLICE LENGTHS



- TYPICAL TIE OR STIRRUP NOTES**
- D = 6d FOR #3 THRU #8
D = 8d FOR #9 AND #10
D = 12d FOR #11 AND #14

- ## 5 STANDARD HOOK AND TIE DIMENSIONS



1

FLAG POLE PLAN - ELECTRICAL

3/32" = 1'-0"

EXISTING EGRESS
BOLLARD

EXISTING WALL MOUNTED FLOOD
LIGHT FIXTURE (TYP)

EXISTING EGRESS
BOLLARD

EXISTING WALL MOUNTED FLOOD
LIGHT FIXTURE (TYP)

PLANTER BED

EGRESS STEP LIGHT
FIXTURE (TYP)

NEW FLAG POLE BY OTHERS

NEW FLAG POLE BY OTHERS

PLANTER BED

SHEET NOTES:

1. ALL HALF SHADED EGRESS FIXTURES SHOWN ON THIS SHEET ARE CIRCUITED TO LIGHTING INVERTED IN BASEMENT ELECTRICAL ROOM 002. FIXTURES ARE CONTROLLED VIA ASTRONOMICAL TIME CLOCK AND UL924 RELAY FOR DUSK TO DAWN OPERATION AND EMERGENCY ON OPERATION.
2. ALL UNSHADED FIXTURES SHOWN ON THIS SHEET ARE CIRCUITED TO A 277V 20A/1P BREAKER IN PANEL HPO IN BASEMENT ELECTRICAL ROOM 002. FIXTURES ARE CONTROLLED VIA ASTRONOMICAL TIME CLOCK FOR DUSK TO DAWN OPERATION.

KEYNOTES:

1. REMOVE EXISTING FLOOD LIGHTS. REMOVE UNUSED WIRING BACK TO NEAREST ACTIVE FIXTURE. OR SPLICE WIRES AS NEEDED IN EXISTING BOXES TO KEEP EXISTING MONUMENT FIXTURE ACTIVE. PROVIDE WET LOCATION JUNCTION BOX COVER FOR EXISTING JUNCTION BOXES THAT REMAIN IN CONCRETE BASE.



CITY OF MADISON
DEPT OF PUBLIC WORKS
ENGINEERING DIVISION



MADISON MUNICIPAL BUILDING
FLAGPOLE REPLACEMENT
215 MARTIN LUTHER KING JR. BLVD 53703

CONTRACT
#9670
MUNIS
#15642
DRWN BY: JRE
DATE: 07/10/2025
REV: 07/10/2025

SHT
E2



Project Schedule

- July 2025 Advertise for Bids
- July 30, 2025 Bid Talk Presentation
- July 31, 2025 SBE Meeting – advance registration required – 8% goal
- August 5, 2025 On-site Tour @ 3:00 PM
- August 12, 2025 Bidder Questions due
- August 14, 2025 Prequalification Application due by 2:00 PM
- August 19, 2025 Questions answered via Addendum
- **August 21, 2025 Bids due by 2:00 PM**
- Sept 2025 Award bid and route contract
- Oct 7, 2025 Site mobilization
- Oct – Dec 2025 Demolition and Construction



Bidding Process

- Access Bid Documents through Bid Express
- Review all Bid Documents including all exhibits and reference documents
- Send questions via email to ascanlon@cityofmadison.com with **MMB Flagpole 9670** in the subject line
- Register for SBE meeting
- Apply to be Prequalified with the City of Madison
- Submit required Bid forms

Contact Information & Resources

- Bidding Questions: Amy Scanlon
Engineering Division
ascanlon@cityofmadison.com
- Bid Distribution Networks: Bid Express
<https://www.infotechinc.com/bidexpress/>
- Project Website: <https://www.cityofmadison.com/engineering/projects/madison-municipal-building-flagpole-replacement>
 - Sign-up for project email updates on the website
 - Recording for this meeting will be posted on project webpage
- Facebook – City of Madison Engineering
- X/Twitter – @MadisonEngr
- Engineering Podcast: Everyday Engineering on iTunes, GooglePlay

CITY OF **MADISON**

