

# Changes to Parks and Recreation Areas

Publicly owned parks and recreation areas are provided extra legal protection during the design and construction of all federally-funded transportation projects. As part of the North-South Bus Rapid Transit (BRT) Project, the City has evaluated all nine parks and recreation areas in the study area. Of these nine parks the project will make small changes to Brittingham

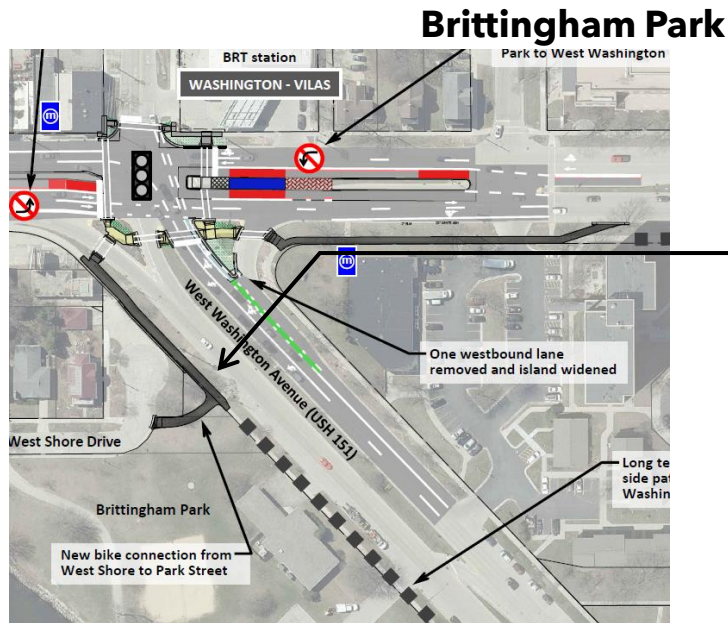

- Adjacent to the Washington - Vilas Station
- Permanent acquisition of about 1,400 square feet of parkland on the south side of Washington Avenue
- Widening of existing sidewalk into new shared-use path called the West Shore Bicycle Connection, which fills a bike network gap
- **No negative impact to the usage and access of the park**

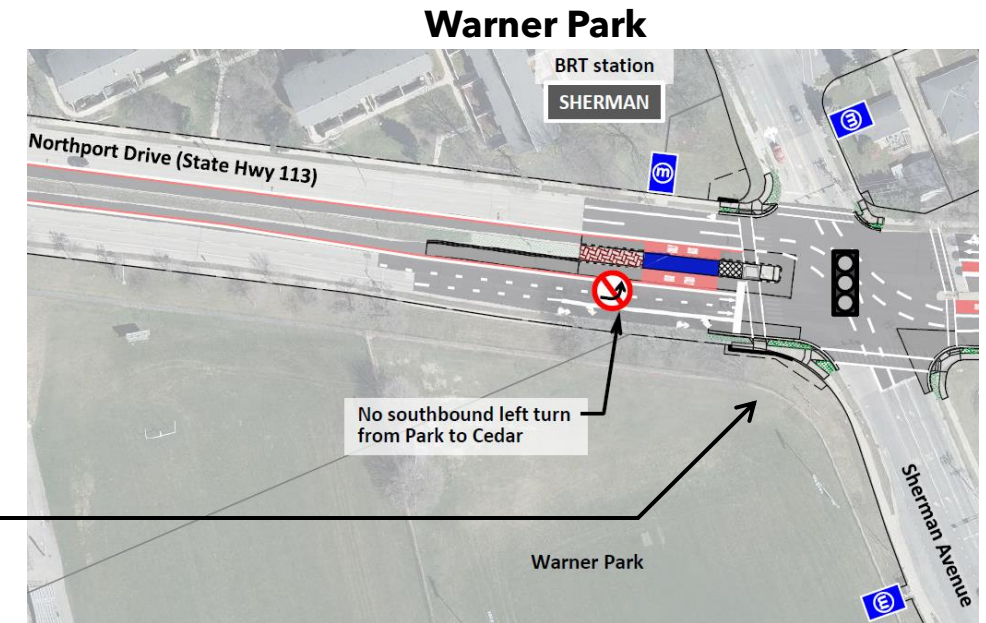

- Adjacent to the Sherman Avenue Station
- Permanent acquisition of about 120 square feet of parkland on the southwest corner of Northport Drive and Sherman Avenue
- Improvements to pedestrian infrastructure, like new curb cuts and accessible pathways to facilitate crossing to the median BRT station
- **No negative impact to the usage and access of the park**

# Potential Effects on Historic Properties

A review of the Wisconsin Historic Preservation Database identified several potential and registered historic properties located on parcels within the study area:

## Individual Potentially Historic Properties

- Vilas Hall
- East Bluff Condominiums
- Cronin Brothers Saloon Building
- Barnard Hall
- Unit Well No. 2

## Historic Districts

- Bascom Hill Historic District (National Register)
  - State Street Historic District (State Register)
- 
- Based on the current project design, formal National Register evaluations are not recommended for the individual potentially eligible properties at this time.
  - However, some contributing resources in the Bascom Hill Historic District were identified for assessment and consideration.

## Bascom Hill Historic District

### East Campus Station



- North-South BRT would add station infrastructure on the existing platform near the Chazen Museum of Art which is part of the Bascom Hill Historic District.
- The BRT project will be evaluated for any potential effects on the museum and its sculpture garden.