

Madison LakeWay Phase 1

Public Information Meeting

Madison, WI





Disclaimer

This meeting is being recorded. It is a public record subject to disclosure.

By continuing to be in the meeting, you are consenting to being recorded and consenting to the record being released to public record requestors.



Agenda

The Vision

Madison LakeWay Phase 1

- ☐ Scope
- ☐ Schedule
- ☐ Design Process

Design Updates

- ☐ Key Node: Pathways and Boardwalks
- ☐ Key Node: SkyLine Pier
- ☐ Story Walk
- ☐ Branding and Wayfinding

Next Steps

Q & A



**A once-in-a-generation
opportunity to shape
the future of Madison's
urban waterfront.**



Lake Monona Design Challenge



Madison Design Professionals
Workshop and UW Madison Civil
and Environmental Engineering

Key 1: Celebrate the
Lakes!

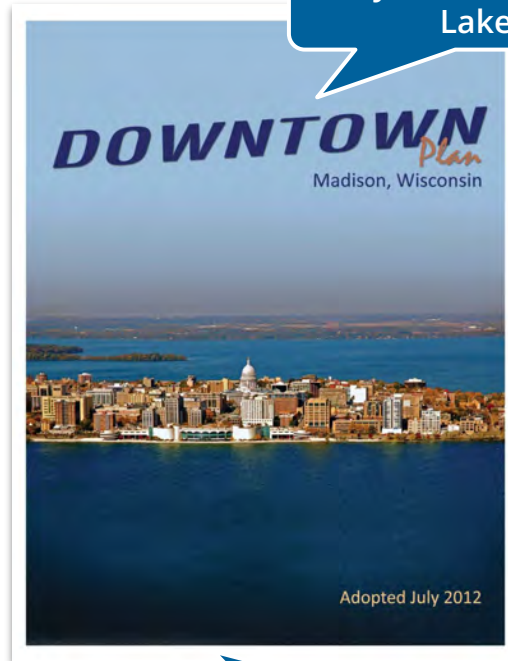

Transform Law Park to make it a
Signature Park for the City...

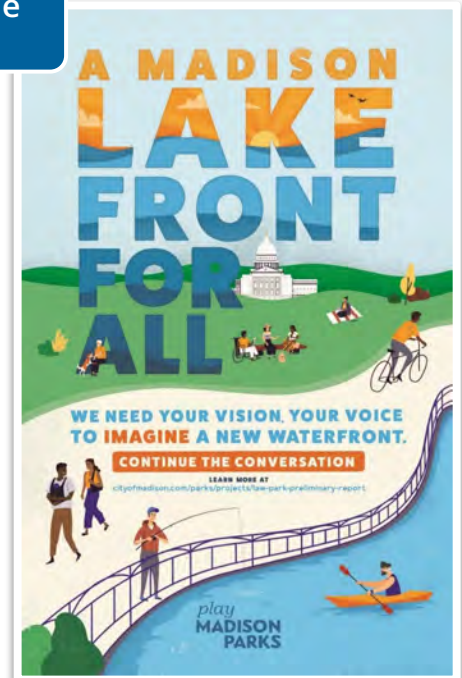

We are grateful to be selected to envision the future of Madison's waterfront...

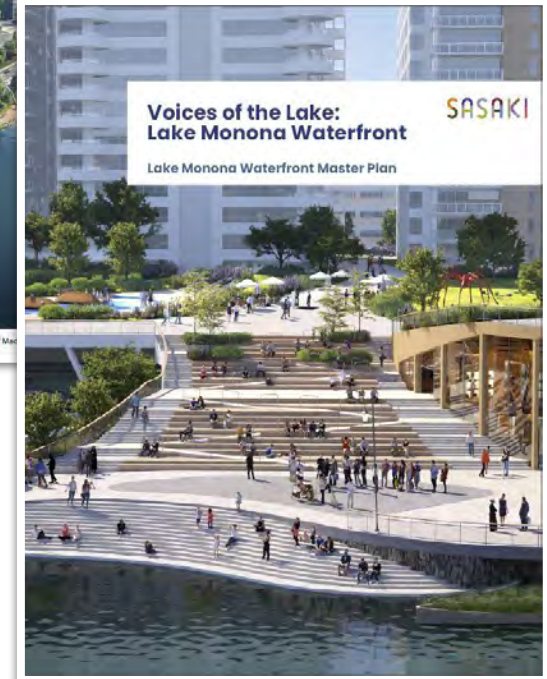

Design Challenge

	Max points	Sasaki	James Corner Field Operations	Agency Landscapes + Planning
Design Challenge Guiding Principles	30	25.77	22.54	23.31
Unity and cohesion	25	21.62	20.38	20.54
Master plan deliverables	15	12.54	12.15	11.69
Including the presence of a detailed implementation plan and technically feasible project components	10			
5 Response to and engagement with public input, specifically the Lake Monona Waterfront - Preliminary Report and the public review and engagement process	15	8.21	6.46	5.69
6 Local Vendor Preference	5	13.69	10.54	12.00
	100	82.85	72.08	73.23

With great attention, and support from the Madison community...

"It's an opportunity to create all sorts of connections, and to center equity and inclusion in the process."

Design Challenge Kick-off



"We want more destination attractions and lake access."

Design Challenge Check-in



"Thank you for providing our community with a safe place for all!"

Engagement Effort in June, July and August

"I am very impressed with the updated vision presented - it wasn't easy for the team to navigate this to find a thoughtful and balanced vision!"

Master Plan Design Update Presentation and Feedback

**ENGAGEMENT I
LAW PARK
Aug. 2019**
21 Events Attended
15 Meetings
200 Contacts
4 Area-Focused Workshops
946 Survey Responses

**LAKE MONONA
WATERFRONT
DESIGN CHALLENGE**
Oct. 2022
14 WEEKS

**LAKE MONONA WATERFRONT
MASTER PLAN REFINEMENT**
Jun. - Dec. 2023
7 MONTHS

**MASTER PLAN DESIGN
UPDATES AND REVISION**
Jul. - Aug. 2023
2 Public Events Attended
7 Topic-focused Workshops
17 Additional Written Responses
25 Consolidated Design Feedback
16 Stories and 119 Feedback via Engagement Boards

**MADISON LAKEWAY
PHASE 1
SCHEMATIC DESIGN**
Jul. - Dec. 2024
6 MONTHS

**MADISON LAKEWAY
PHASE 1
DESIGN DEVELOPMENT**
Mar. - Aug. 2025

PUBLIC INFORMATION MEETING #2
Jul. 2025

**FUTURE
ENGAGEMENT**

PUBLIC INFORMATION MEETING #1
Jan. 2025

**MADISON LAKEWAY
COMMON COUNCIL
APPROVAL**
Apr. 16, 2024

**DESIGN CHALLENGE SURVEY
ANALYSIS AND IMPROVEMENT AREA**
Jun. 2023
9 Topic-focused Workshops and Meetings
8000+ Responses Analyzed
3 Public Events
142 Additional Feedback via Engagement Boards and Online Survey

**LAKE MONONA
WATERFRONT
ONLINE SURVEY**
Jan. - Mar. 2023

Topic	Number of Responses	Key Findings
Public Space	1,234	High demand for public space, particularly for walking and biking paths.
Waterfront Access	987	Strong support for improving access to the lake waterfront.
Recreation	765	Interest in recreational facilities and programs along the waterfront.
Transportation	543	Need for improved transportation options, including bike lanes and pedestrian paths.
Community	432	Desire for community-oriented spaces and events.
Environment	321	Concern for environmental protection and sustainability.
Art and Culture	210	Support for art and cultural installations along the waterfront.
Historic Preservation	109	Interest in preserving historic buildings and structures.
Public Safety	98	Need for improved public safety measures, including lighting and security.
Other	87	Various other suggestions and feedback.

"This has been a lot of fun, but then we get to start talking about how we actually make these beautiful designs a reality."

Design Challenge Survey Results Analysis

"The isthmus of Madison is a very unique environment and I see Sasaki as the best way to honor this special area."

Design Challenge Final Presentation







Lake Lounge "The Lounge"

Law Park Ledge "The Ledge"

Phase 1

**Community
Causeway**
"The SkyLine"

Olin Overlook
"The OverLook"

A MADISON WAY TO LAKE

Madison LakeWay: Phase 1



Madison LakeWay: Guiding Principles



Water Dialogue
**Create a Living
Edge along
Lake Monona's
Shoreline**



Nature Dialogue
**Inspire
Generational
Stewards**



City Dialogue
**A Place for All
to Connect &
Be Connected**



Community Dialogue
**Enhance Equitable
Access to Parks**



Culture Dialogue
**Starting with
the Sacred
Voices**



Architecture Dialogue
**A Balanced
Perspective**



Water Dialogue

Create a Living Edge along Lake Monona's Shoreline

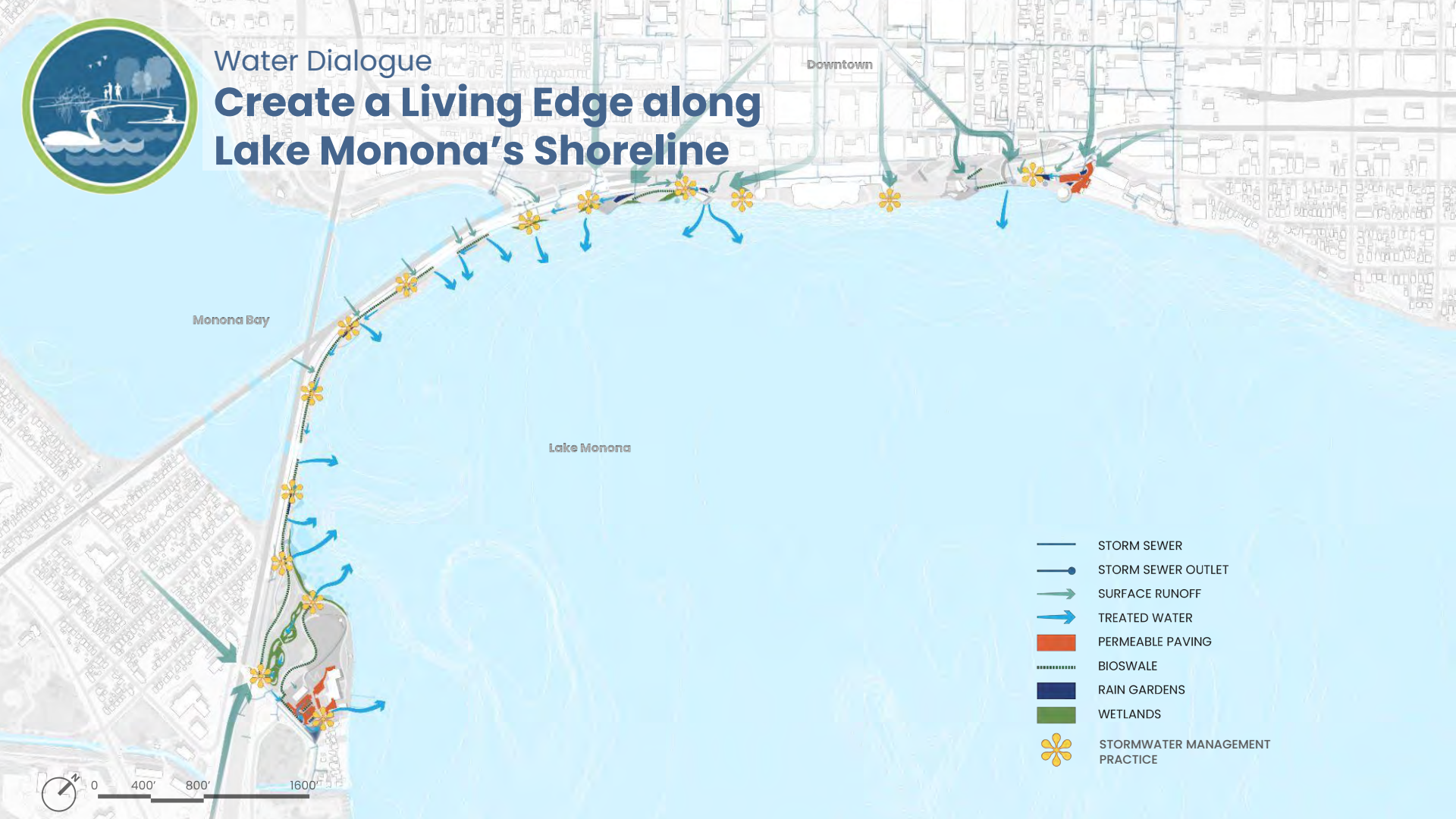

- STORM SEWER
- STORM SEWER OUTLET
- SURFACE RUNOFF
- TREATED WATER
- PERMEABLE PAVING
- BIOSWALE
- RAIN GARDENS
- WETLANDS
- ✿ STORMWATER MANAGEMENT PRACTICE

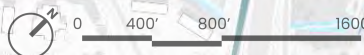

Phase 1 Scope

“ Following the Lake Monona Waterfront Design Master Plan Refinement (Master Plan), Sasaki will initiate the Lake Monona Phase 1 Improvements.

The primary goal is to take the approved Master Plan into schematic design, design development, and public engagement.”



 Scope:
Schematic Design -
Design Development

- | | |
|--|---|
| 1 The Capitol View Plaza | 8 Jogging Path |
| 2 Fishing Pier (North) | 9 Wave protected fringe wetlands |
| 3 Fishing Pier (South) | 10 Equipment storage |
| 4 Capitol Overlook Seating Area | 11 *Site landscape design
(street trees, bioswales, and rain gardens) |
| 5 Shoreline revetment design
(any modifications beyond the base
condition constructed with the John
Nolen Drive reconstruction projects) | 12 *Site accent lighting |
| 6 Bicycle Path | 13 *General amenities
(benches, bike racks, etc.) |
| 7 Pedestrian Path | *Not called out on the plan |

Phase 1 Implementation

Public realm design

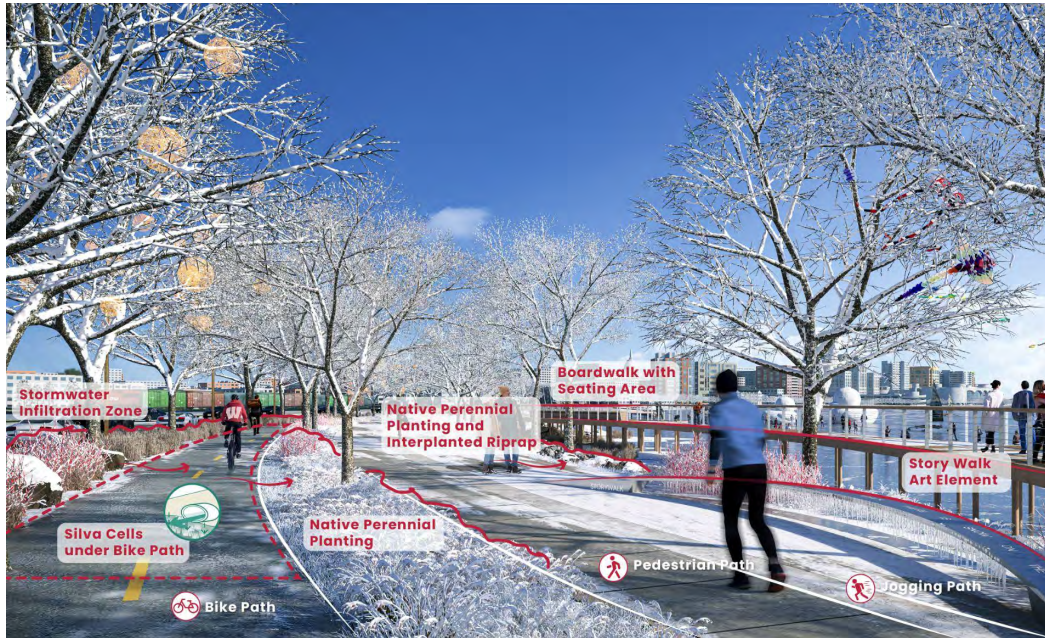

Coordinating with...

City of Madison Engineering Division

John Nolen Drive Reconstruction

Project Schedule

This project will be planned and designed in coordination with the ongoing with the [Monona Waterfront Design Challenge](#)

The process began in 2021 and is expected to run from through 2026. It will include analysis of existing conditions, feasibility studies, and a robust community engagement process to inform preliminary and final designs.

	NOTES	DETAILS
EXISTING (No Change)	72-ft Roadway Width No Trees in Median	
ALT 1	63-ft Roadway Width Wider Median Trees in Median Balance Green Space	
ALT 2	54-ft Roadway Width Narrower Median No Trees in Median Max Green Space to Park	

Phase 1 Design Milestones

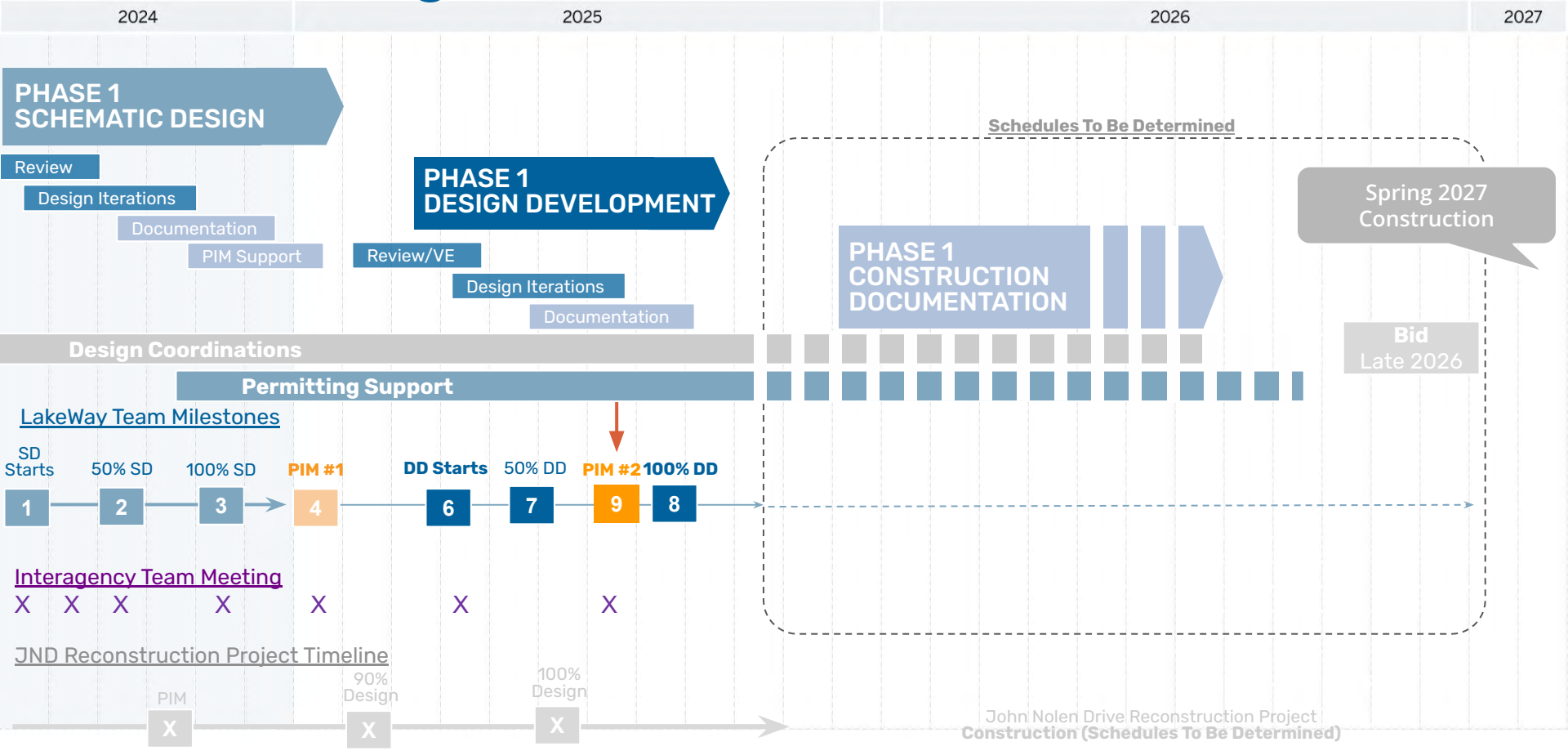

Phase 1 Teams

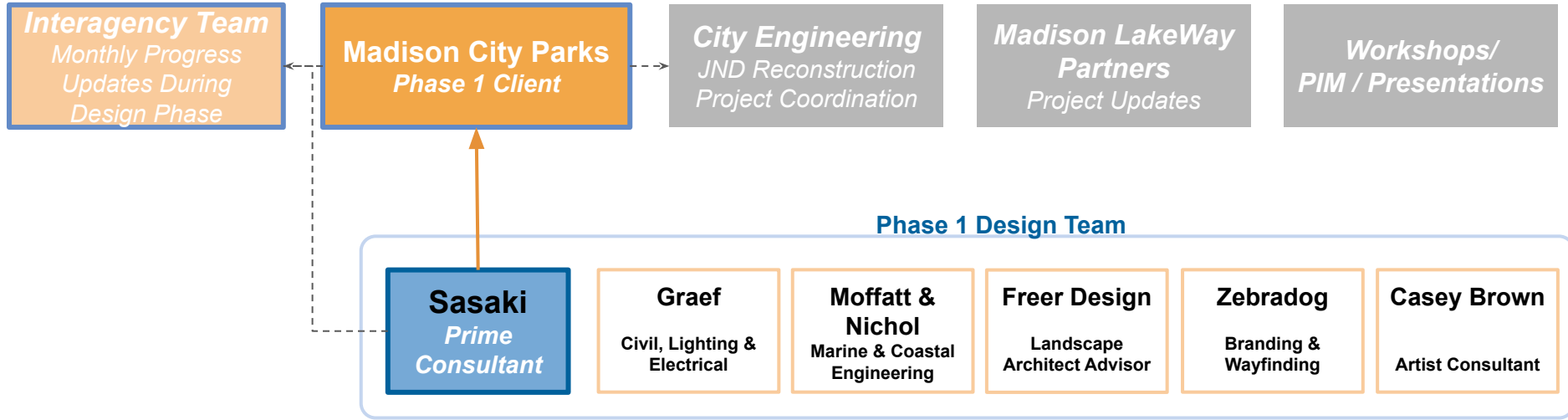

Design Study and Meetings

A collaborative process with JND Design Team, Parks, Forestry, City Engineering...



Tree allée Virtual Drive
Draft Design Options with Virtual Drive (35-40 mph)



Final Directions

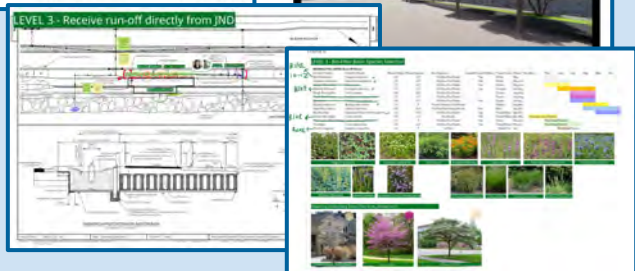

Planting Rhythm, and Stormwater Study

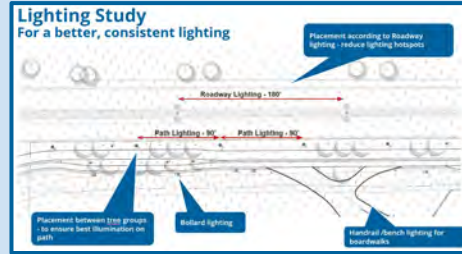

Path Alignment, Lighting, and Edge Condition Study



Way-finding, Structures design and Customized Furniture

TODAY,

10'-wide **Multi-use Trail**

sections of **0.5 -2' Jogging Path**

1.8 acres of **Open Space**,
without dedicated areas for fishing/resting

30 existing **Trees**
some of which are in stressed conditions

Stormwater Treatment Structures
within the John Nolen Drive roadway

TOMORROW,

Dedicated 10'-wide Bike Lane

6+'-wide Pedestrian Path,
or **'Story Walk'**

2' wide paved Jogging Path

2.8 acres of **Linear Park**, with
9450 ft² of Accessible **Boardwalk** and **Pier**,
for view/fishing/resting

50+ total proposed and preserved **Canopy Trees**,
20+ total proposed **Understory Trees**,
and **Native Groundcover Planting**

a new **stormwater treatment** approach that includes
Vegetated Swales/ Biofilter Basin
Passive Canopy Tree Irrigation, and
Sediment-reducing Inlet Structures.



An aerial photograph of a river with a bridge crossing it. The bridge has multiple lanes and is surrounded by greenery and infrastructure. The image is overlaid with a semi-transparent blue filter.

Design Updates



Curves are the natural and native forms in landscape, in waves, and in local culture



Balancing between the practical linear forms, and waves of paths with crest and trough





Phase 1 – Existing Condition

Land gained from JND Roadway Reconstruction Project:

~47,000 sf (~1 acres)

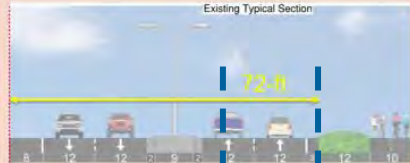

	NOTES	DETAILS
EXISTING (No Change)	72-ft Roadway Width No Trees in Median	 <p>Existing Typical Section</p> <p>72-ft</p>
ALT 2	54-ft Roadway Width Narrower Median No Trees in Median Max Green Space to Park	 <p>Proposed Section Alternative 2</p> <p>54-ft</p> <p>See Shared Use Path Alternatives</p>

Images from 2023_02_23 JND PIM 2 Presentation

Phase 1 - Illustrative Plan



1 Story Walk and Public Art Opportunities

2 SkyLine Pier & Plaza

3 Boardwalk with Seating

4 Shaded Seating Steps

5 Trail for All Speeds

6 Boardwalk / Fishing

7 Cut Stone Steps (Potential Seasonal Kayak Access)

8 Seating Area (Stormwater Management Observation Area)

9 Bike Rack (Potential Storage)

10 Native Street Trees - Preserving View Corridor towards Downtown

11 Wave Protected Vegetated Shoreline

12 Stormwater Demonstration / Infiltration Zone

Design Opportunities



Trails for All Speed



Native Planting and Swale



Resting Area



Paths Along Water



Boardwalk Seating

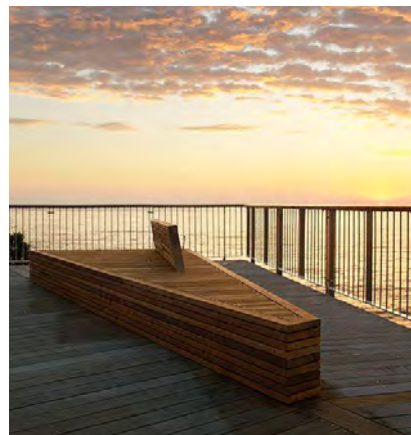

Deck with View



Boardwalks



A Place for All to Connect & Be Connected

City Dialogue

Distance: 4,300ft

Walking: 20min
continuous walk*
Jogging: 10min
Biking: 5min

John Nolen Drive

650 ft
4 min leisure walk

1300 ft - 0.25 mi
4 min jogging

Phase 1

N Shore Dr.

Primary Pedestrian Path

Universal ADA Access



6'

Boardwalk

Universal ADA Access



8'

Jogging Path



2'

Bike Path

Universal ADA Access



10'



Bike Parking



Potential Kayak Route



Maintenance Vehicle Access



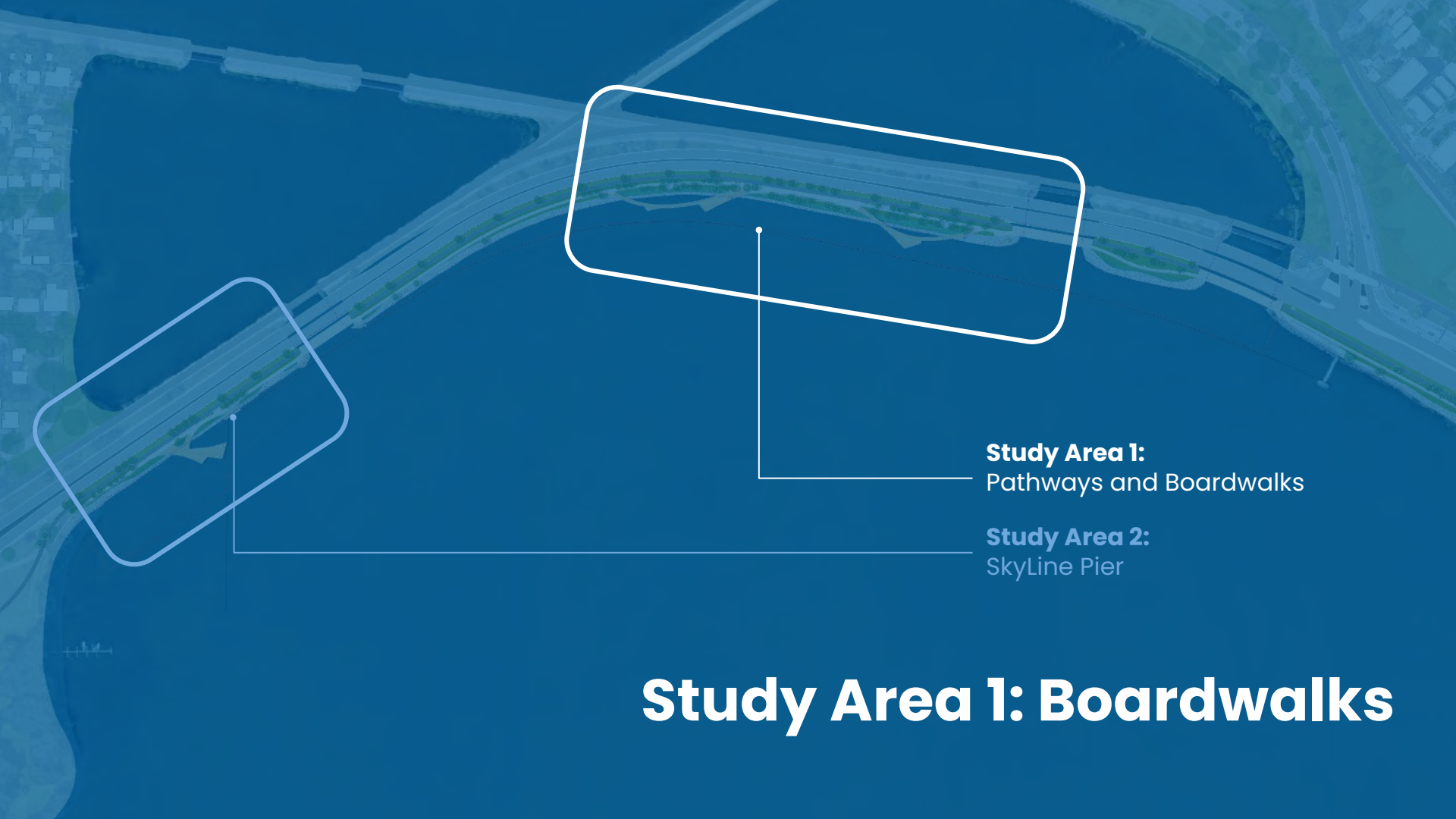

Study Area 1:
Pathways and Boardwalks

Study Area 2:
SkyLine Pier

Study Area 1: Boardwalks

What we've heard during PIM #1?

Boardwalk and Pathways

Boardwalks & plants to **protect shore ecosystem**.

Expands natural places & allows people to pass through while disturbing less than on a path through ecosystem.

Although there was confusion regarding how the paths would actually fit, **having additional bike/pedestrian paths** is a positive.

Separated path users and unique experiences afforded to users not currently present.

I like the **boardwalk and cozy pedestrian trails** that are separate from the bike lane. I like the **seating/resting places** to hang out.

It's not clear **how you're going to squeeze all of those paths onto the narrow strip** between the J. Nolen Drive and the lakeshore without either narrowing the road (great idea) or pushing the paths out over the lake.

(Like the) **separate pedestrians and bicyclists**. (However) This area is already very popular with bicyclists and pedestrians. I'm concerned the bikeway as designed may be too narrow.

Native plantings are excellent! Having separate cycling and walking paths is much needed. The **story walk is a nice idea** – definitely love it, however if funding is an issue, please prioritize separation of bikes and pedestrians and native plants/stormwater over anything else.

I like the **boardwalks to allow folks access to the lake**, but am concerned about their **access, maintenance and safety in winter with ice and packed snow**. Right now the piers are taken out seasonally.

I love the boardwalks and piers and spaces for people to explore and gather. I really am anxious to spend more time on lake Monona.

I LOVE that there are bike racks included!! This is so incredibly appreciated!

My only concern is **traffic speed because of the noise it will cause**. I know this is outside of your control.

Appreciate the nature demonstration areas -- I'd like to see us integrate nature into this manmade embankment as much as possible

Pathways and Boardwalks

Existing Condition

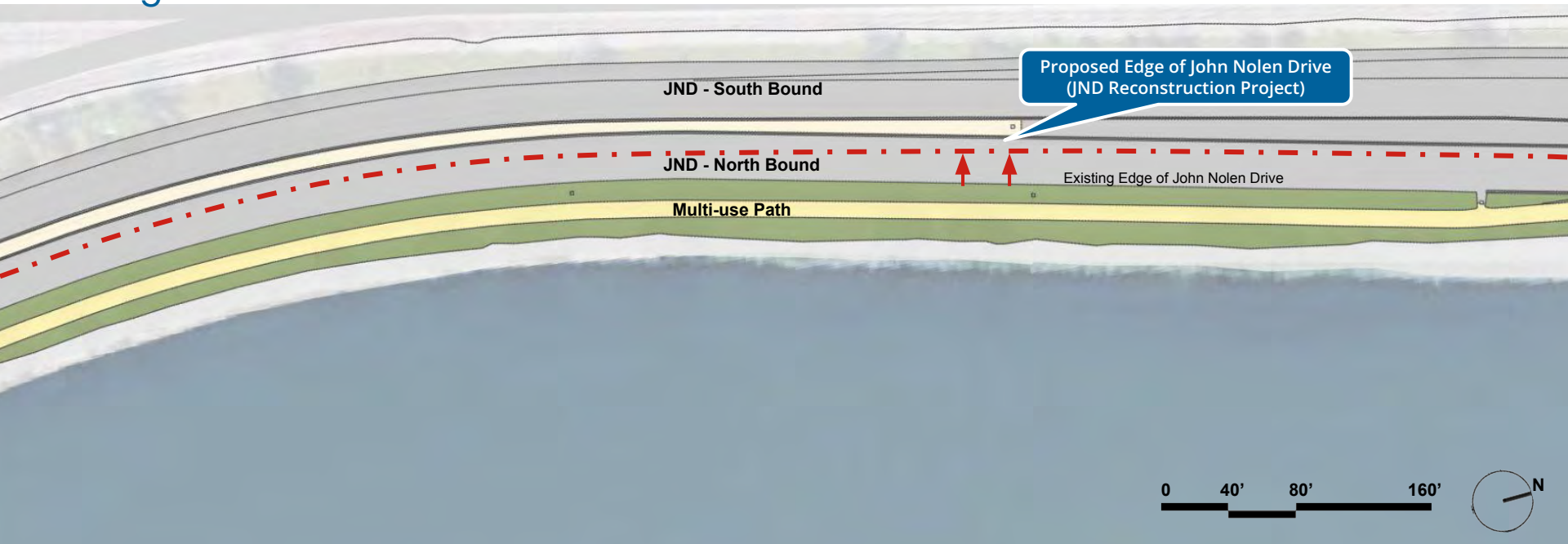

Pathways and Boardwalks

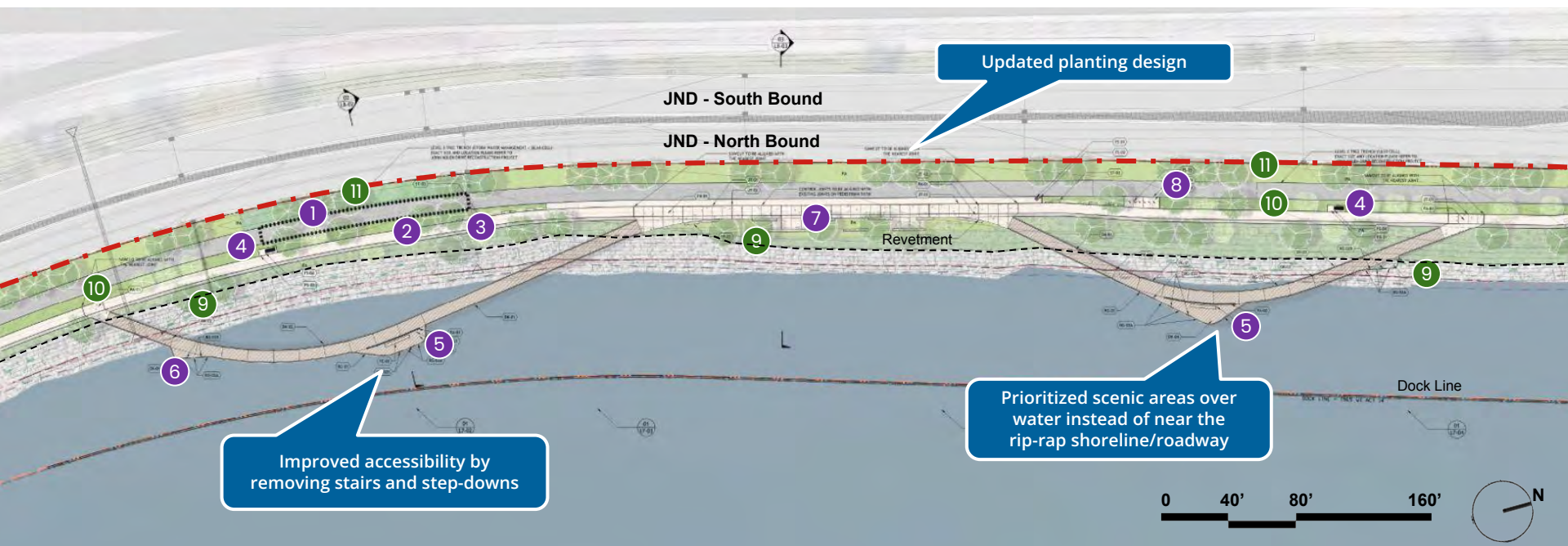

- 1 Bike Path
- 2 Pedestrian Path
- 3 Jogging Path
- 4 Seating Area

- 5 Boardwalk Seating Area
- 6 Boardwalk Fishing Nook
- 7 Seating under Trees
- 8 Bike Rack

- 9 Vegetated Shoreline / Interplanted Riprap in coordination with JND Re-construction Project
- 10 Native Species Planting and Swales
- 11 Stormwater Infiltration Zone - Coordination with JND Re-construction Project

Experience on Land

Existing Conditions



Experience on Land



Existing Curbline

Boardwalk with Seating Area

Native Perennial Planting and Interplanted Riprap

Story Walk Art Element

Native Perennial Planting

Silva Cells under Bike Path



Pedestrian Path



Jogging Path



Bike Path

Pathway and Seating Area Section

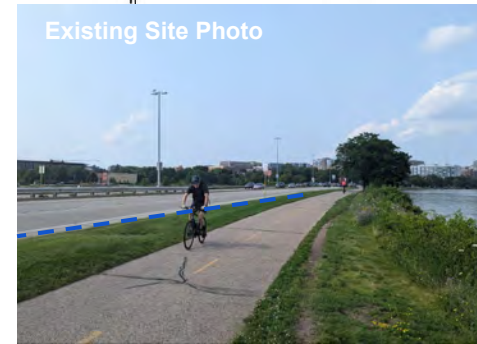
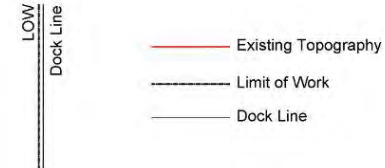
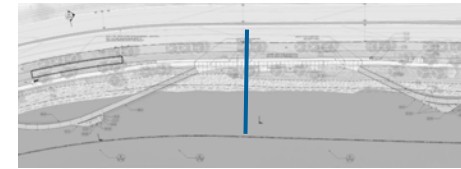
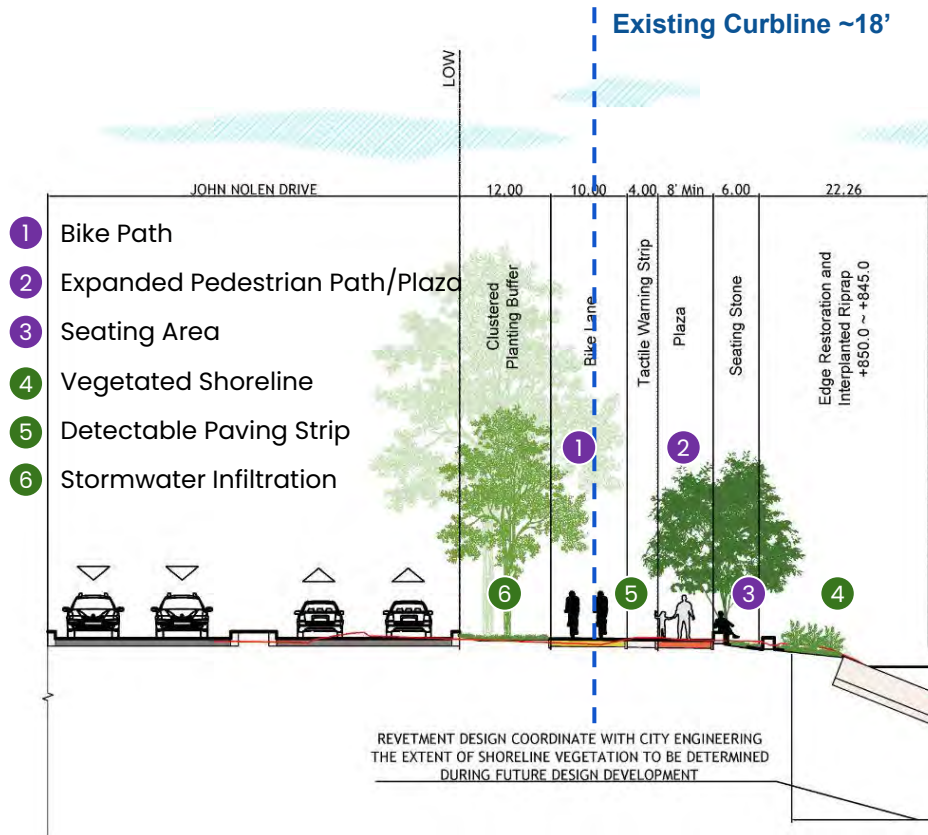

Existing Topography



Create a Living Edge along Lake Monona's Shoreline

Water Dialogue

- SILVA CELLS
- BIOSWALE
- INTERPLANTED RIP RAP
- NATIVE GROUND COVER
- INFILTRATION TRENCH
- DRAINAGE PIPE

John Nolen Drive

N Shore Dr.

Phase 1

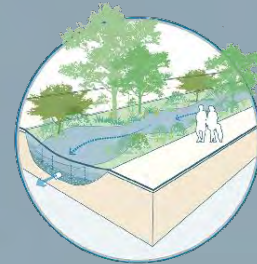

Infiltration Trench

Depressed areas in the landscape will collect rain water and recharge it into the ground. The native planting in these gardens will also help filter out pollutants.

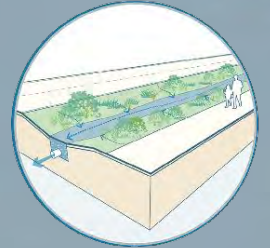

Bioswale

Bioswales planted with native flora and fauna will help filter pollutants and slow down rain water as it heads towards the lake.



0 100' 200' 400'

Stormwater Strategy

Collaboration with Forestry, JND Reconstruction

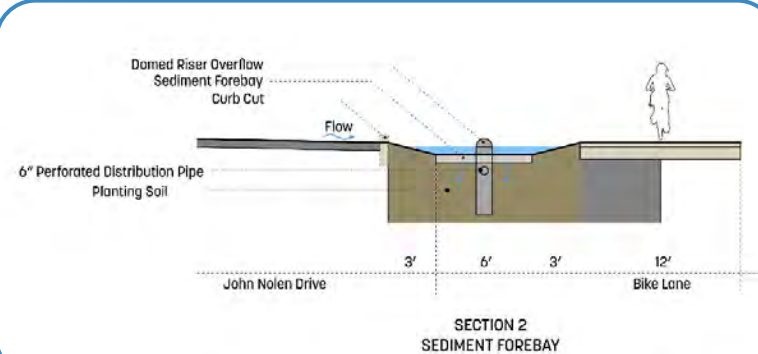
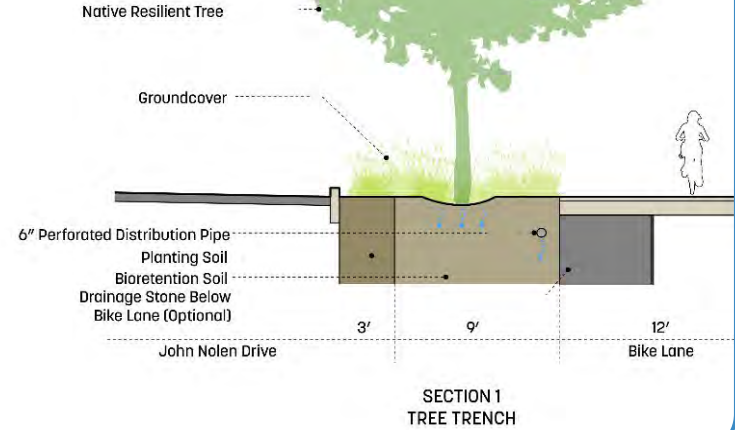
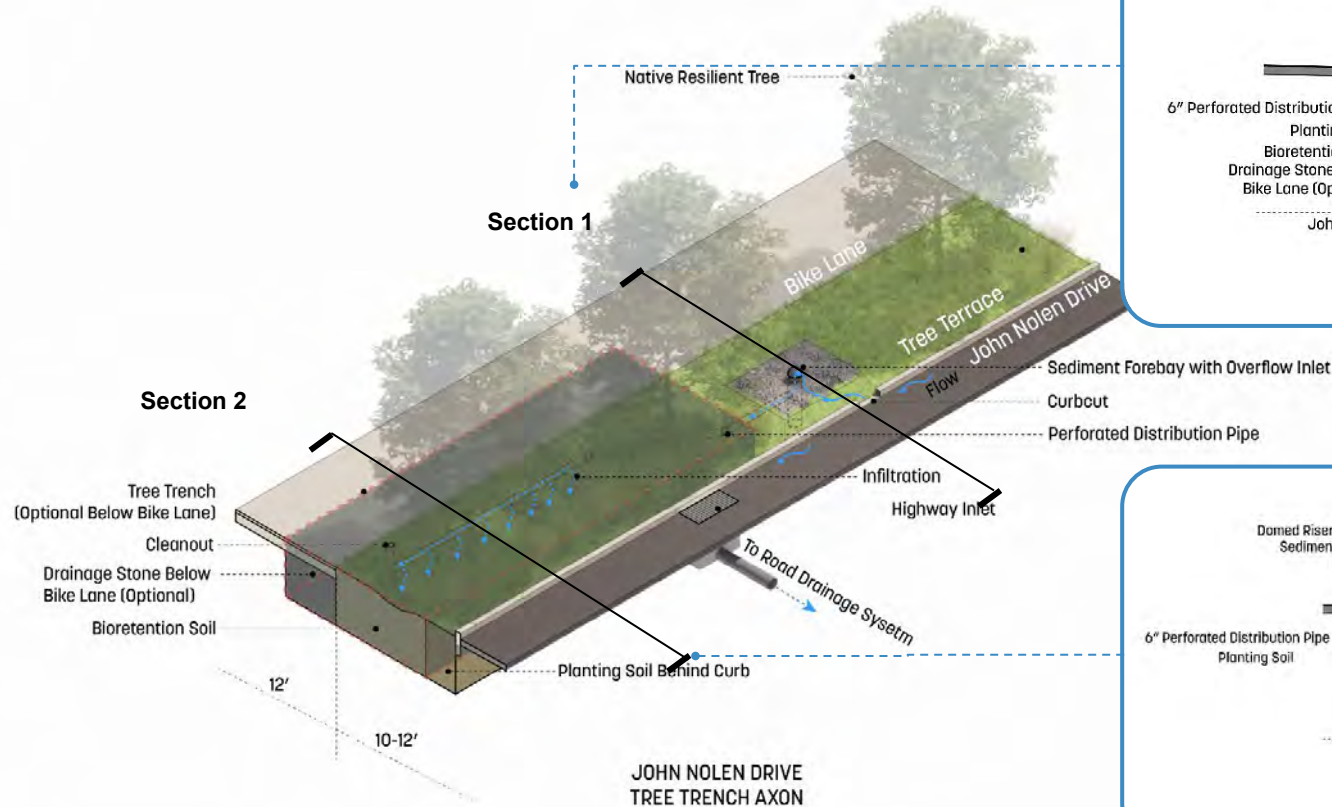

Stormwater Strategy

Bio-filter Basin Planting Layout

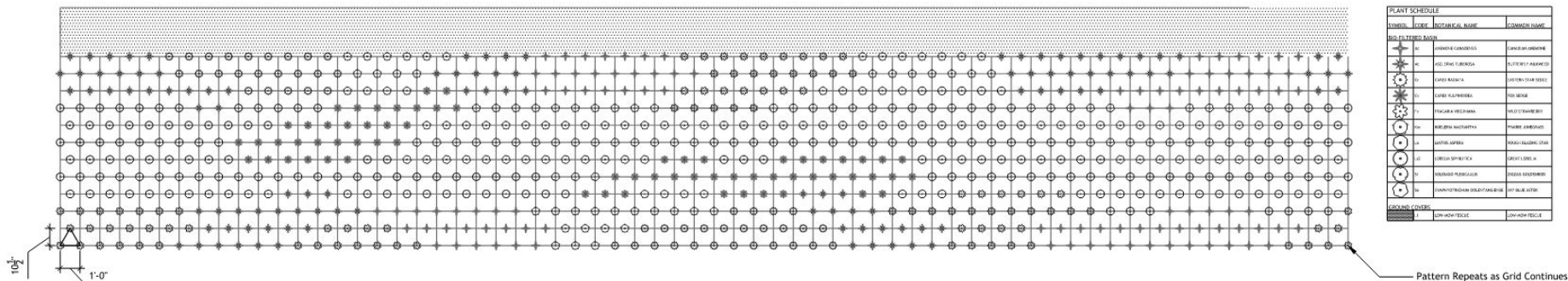

Fragaria virginiana



Anemone canadensis



Zizia aurea



Asclepias tuberosa



Liatis aspera



Petalostemum purpureum



Tradescantia ohiensis



Solidago flexicaulis



Lobelia siphilitica



Symphyotrichum coelentangiense



Carex muskingumensis



Carex radiata



Carex vulpinoidea



Koeleria macrantha

Design Opportunities

Ecology and Natural Art



Ecology Magnifying Glasses



Ecology Signage



Small Scale Exploratory Art

Experience near Water

Existing Conditions



Experience over water

Native Planting for
Visual Interest and
Ecological Benefit



• Native Perennial
Planting

Interplanted Riprap
for Enhanced
Shoreline Habitat



Accessible
Fishing Nook



Pedestrian Path

• Environmental
Education Signage

Environmental Education Signage
on Mon...

Handrails

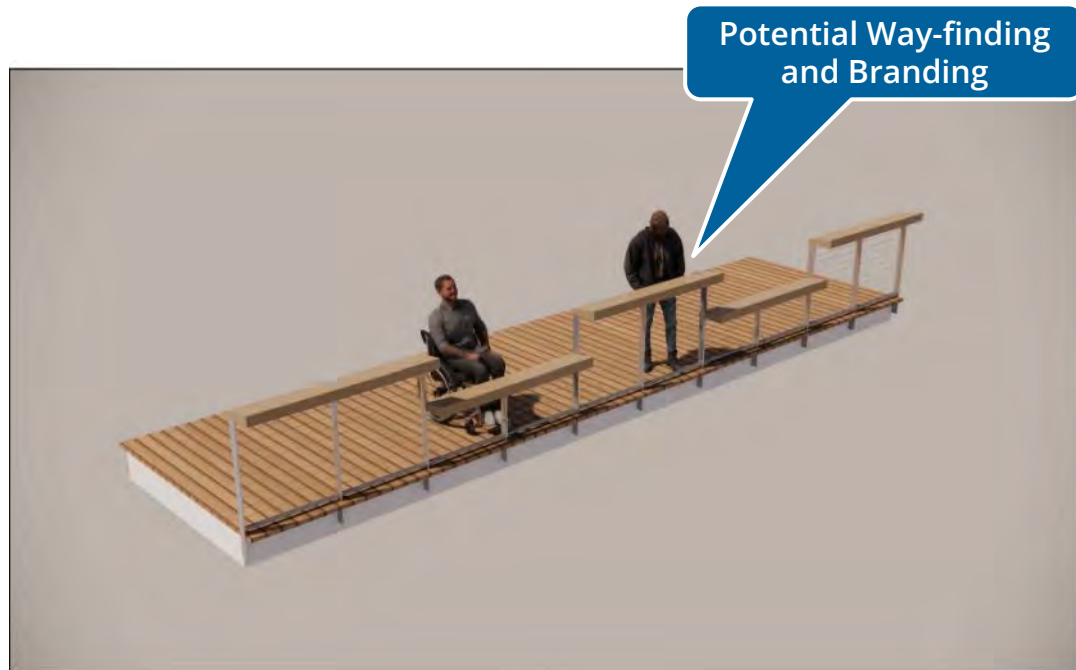
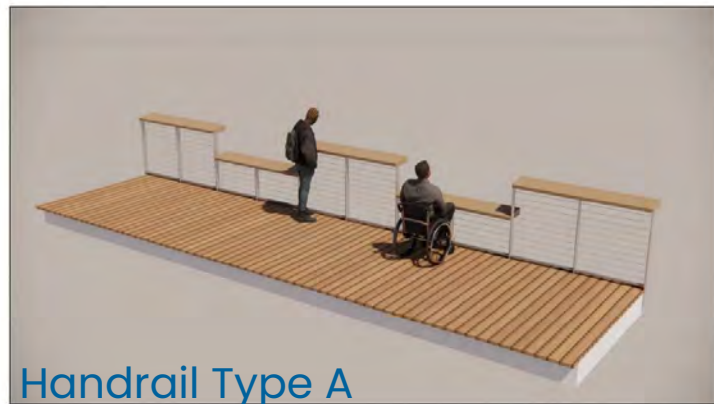

Boardwalk Section

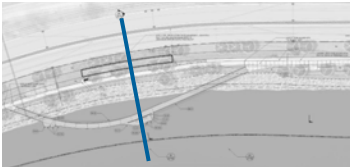
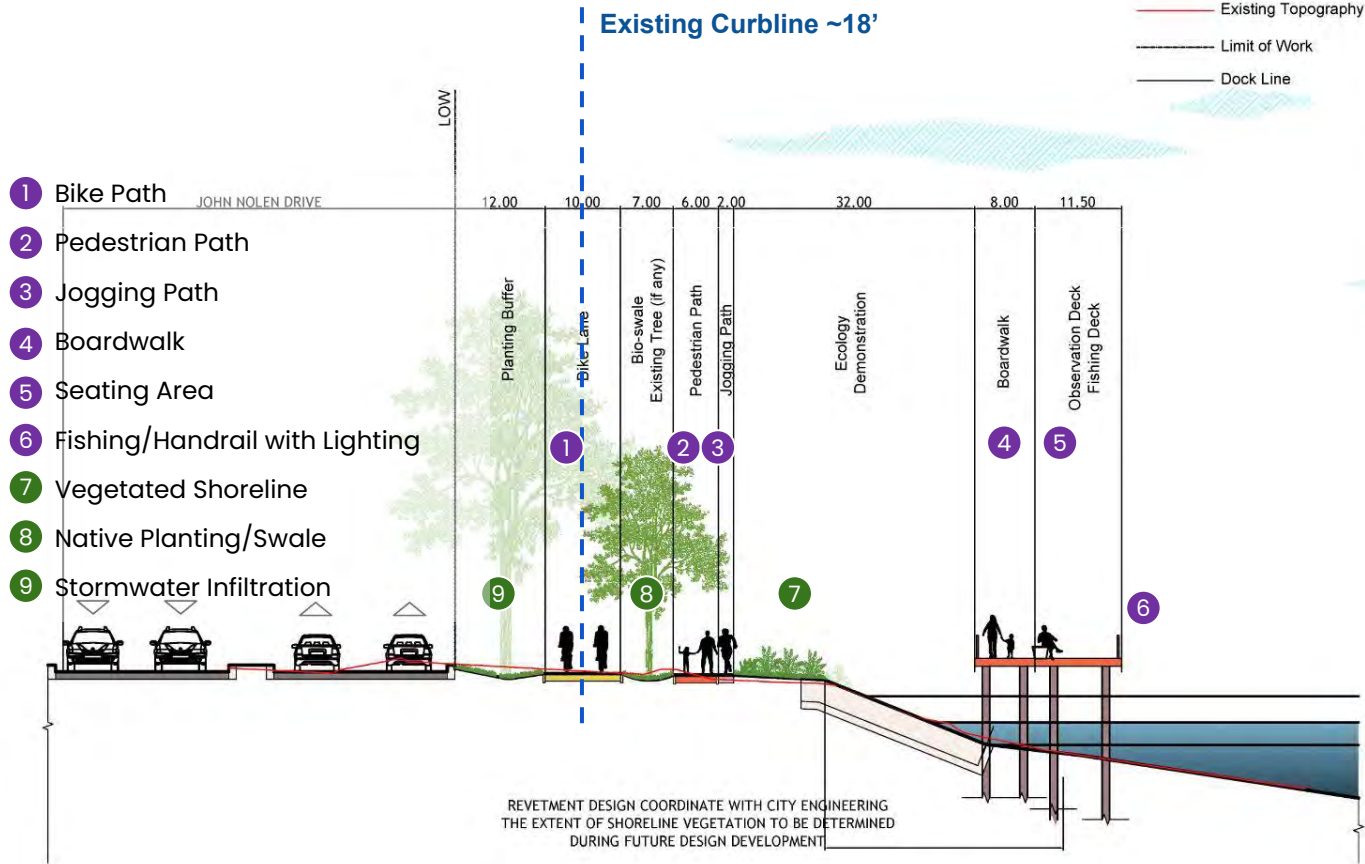

Existing Topography

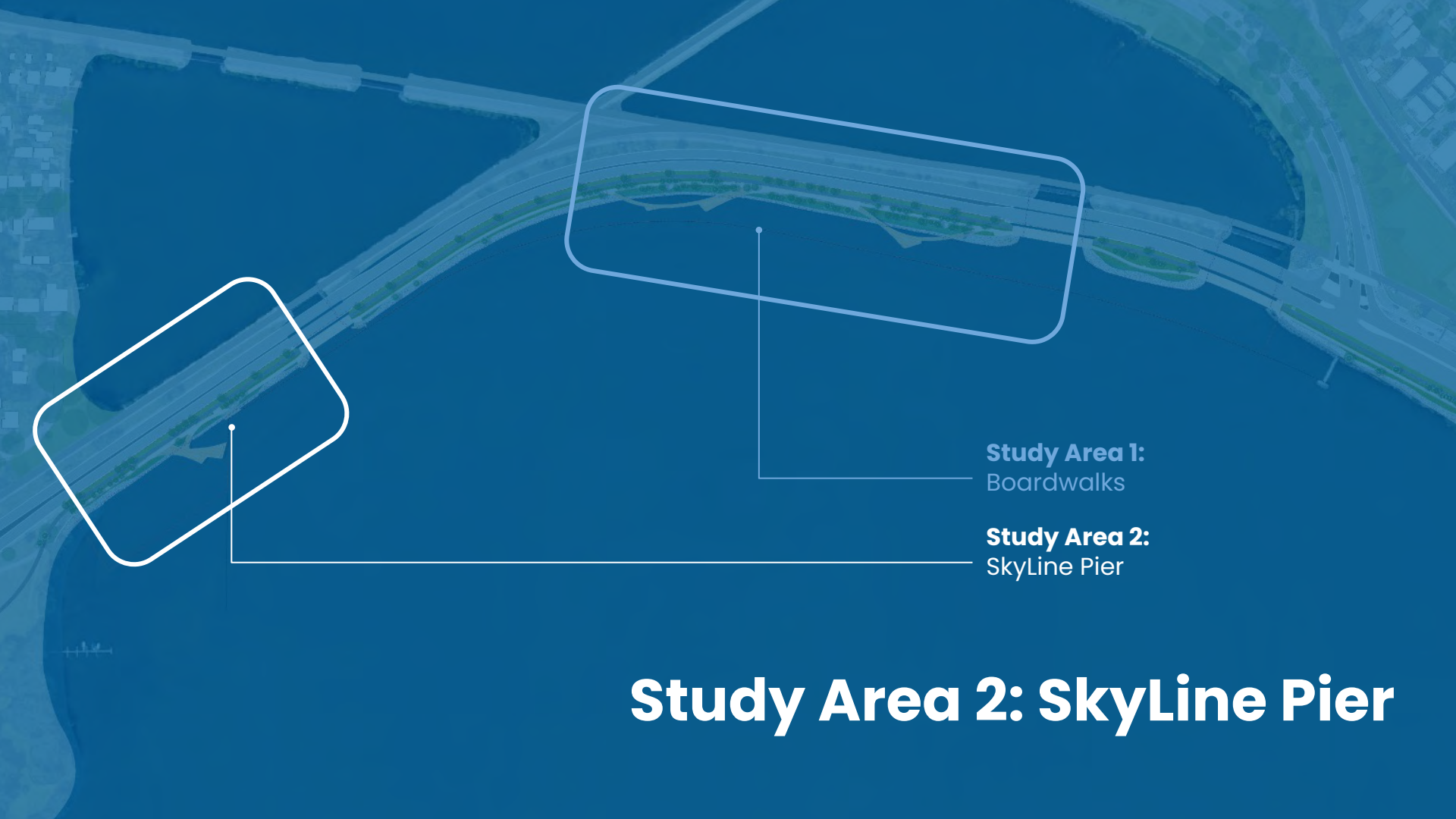

Study Area 1:
Boardwalks

Study Area 2:
SkyLine Pier

Study Area 2: SkyLine Pier

What we've heard during PIM #1?

SkyLine Pier (previously Capitol View Pier)

I think it's a great first step. If done well, it will be a fantastic resource for locals and visitors alike.

*The boardwalks and piers will be beautiful and encourage people to stop. Also **more tree canopy will be great**. Currently the sun can be harsh during the hotter months.*

*I like the **piers and other features designed** to bring users out onto and near the water. **I like the benches and resting areas**, and think that there need to be as many of those as possible, especially on the piers.*

*The **Capitol View Pier is a nice design element** that looks OUT from the park, instead of IN at the design.*

*The **Effigy Mound story is important**...both on Lake Monona and the view in the opposite direction that used to be dominated by the Dividing Ridge between Wingra and Monona Bay.*

*I appreciate color as wayfinding cues, but would like them to perhaps also **have patterns or similar for people who are red/green colorblind**.*

*Really like the design for the Capitol View pier, exciting to see **kayaker access** there.*

*Yes! Would be great to tell the **geological story of Lake Monona** in addition to the cultural history and present. And how people can help preserve this lake and lakeshore now and for future generations. **Collaboration with conservancy groups with easy QR donation opps?***

*All **trees should be carefully analyzed** to avoid blocking too many views.*

*Dedicated fishing piers to provide **dedicated fishing space** and offer alternatives to the narrow, high traffic space at the Monona terrace.*

*Seems like it will be a nice place to **take a walk and enjoy the area** if **free or inexpensive parking** can be found nearby*

*While I understand that a bathroom on the causeway is not feasible, [...] **make sure that clean and near bathrooms** in other areas of the lakeway should be prioritized.*

SkyLine Pier (Previously Capitol View Pier)

Existing Condition

JND - South Bound

JND - North Bound

Multi-use Path

Proposed Edge of John Nolen Drive
(JND Reconstruction Project)

Existing Edge of John Nolen Drive

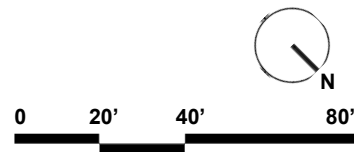

SkyLine Pier

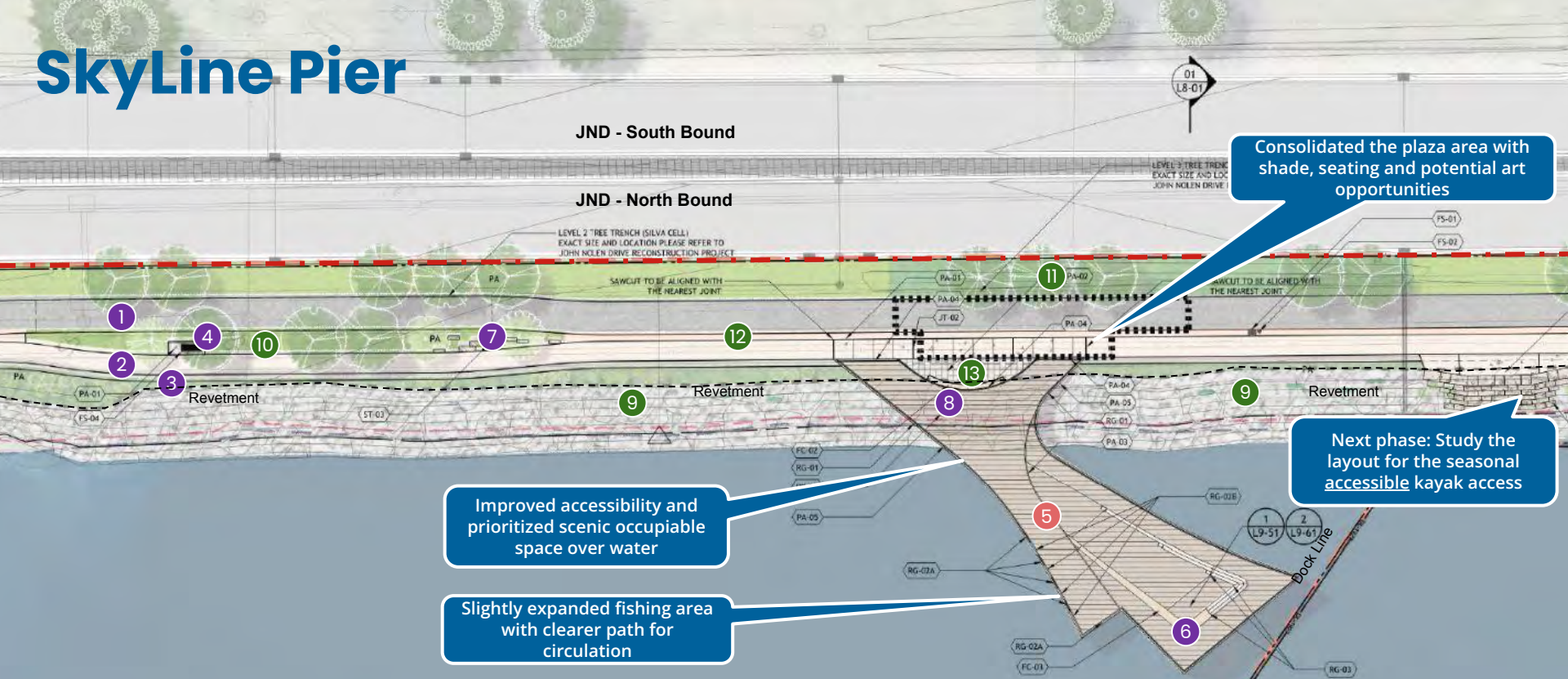

Consolidated the plaza area with shade, seating and potential art opportunities

Next phase: Study the layout for the seasonal accessible kayak access

Improved accessibility and prioritized scenic occupiable space over water

Slightly expanded fishing area with clearer path for circulation

- | | | | |
|----------------------------|-------------------------------|--|--|
| 1 Bike Path | 5 SkyLine Pier | 9 Vegetated Shoreline (<i>Interplanted Riprap</i>) - Coordination with JND Re-construction Project | 13 Specimen Tree/
Tree-inspired Art |
| 2 Pedestrian Path | 6 Seating Steps with Lighting | 10 Native Species Planting and Vegetated Swales | |
| 3 Jogging Path | 7 Stacked Stone Seating | 11 Stormwater Infiltration Zone - Coordination with JND Re-construction Project | |
| 4 Shaded Seating with View | 8 Seating | 12 Detectable Paving Strip | |
- N

0 20' 40' 80'

SkyLine Pier

Panoramic View of Madison and Lake Monona

View from John Nolen Drive

Story Walk Destination

Panoramic View to the past, present and future of Madison City at SkyLine Pier



View towards Olin Park



View towards Elmside Park

View towards Hudson Park



View towards the Capitol

Current Experience

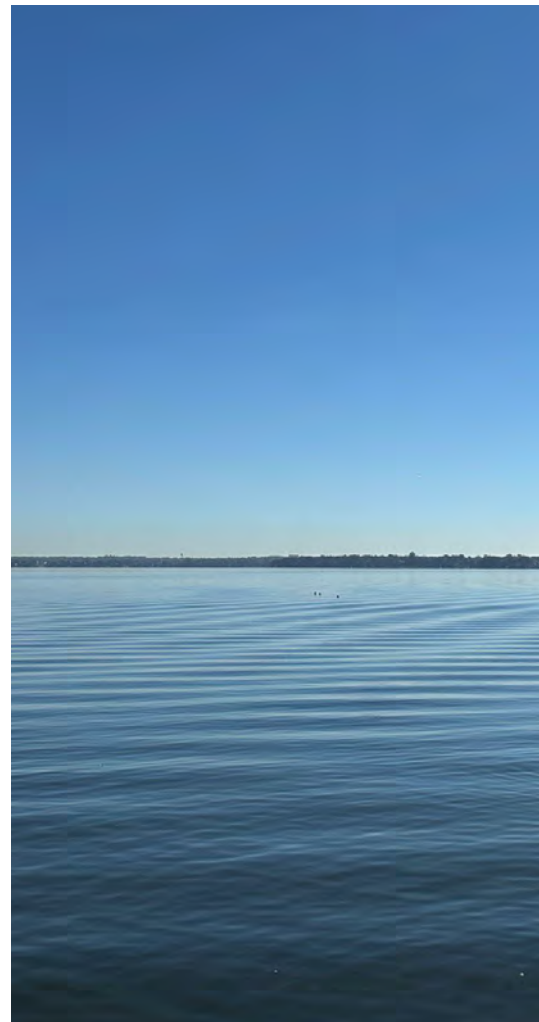

SkyLine Pier Design Intention

Tree, or Tree-inspired Public Art and Shade Installation

View to the Madison Skyline

• Wave-inspired Customized Bench

View to the Effigy Mound Sites across Lake Monona

• Interpretive Sign

• Interpretive Sign



Pedestrian Path



Bike Path

• Native Perennial Planting

• Lakeway Art Inlay



SkyLine Pier

Spatial Design

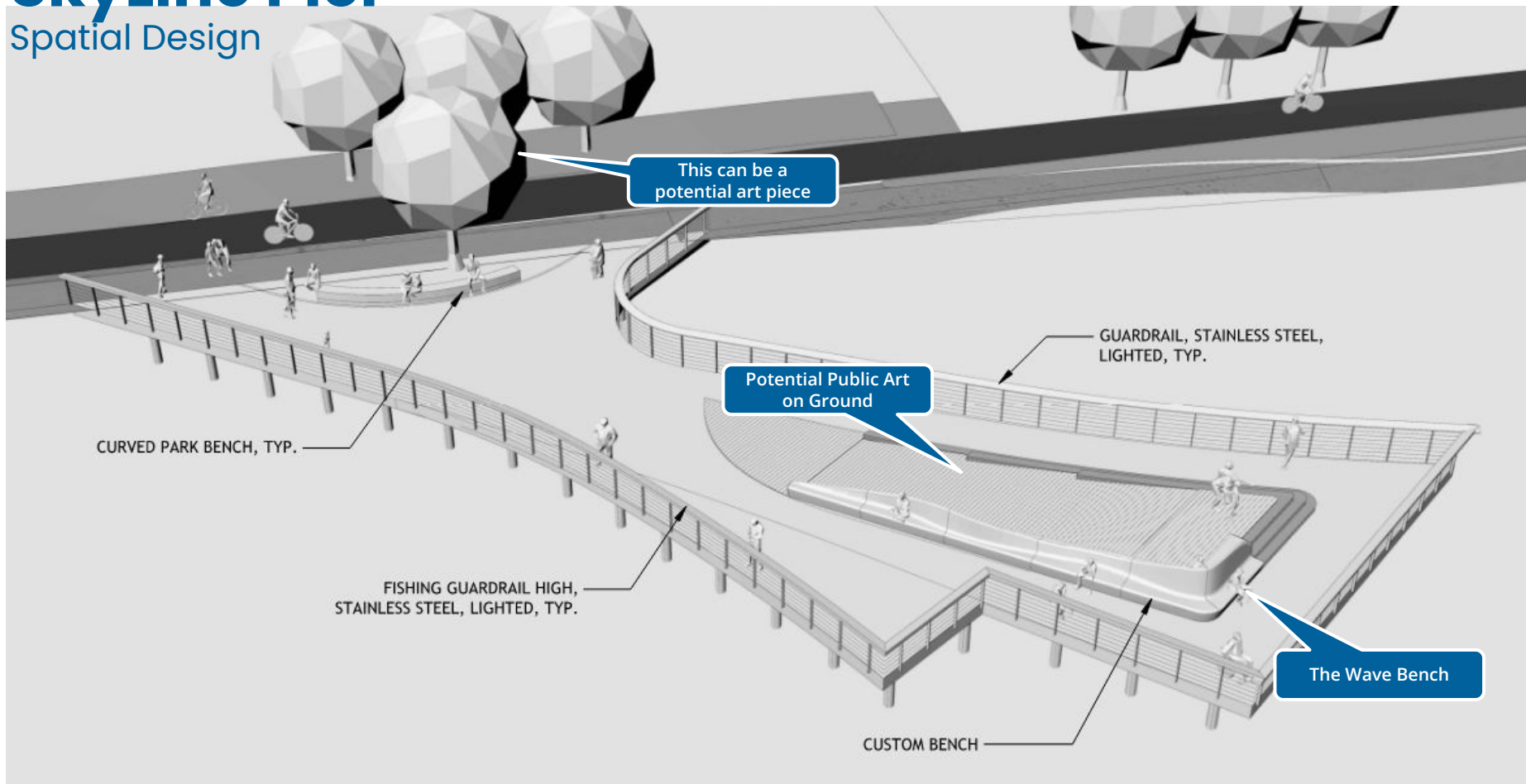

The 'Wave' Bench

Inspired by waves and water

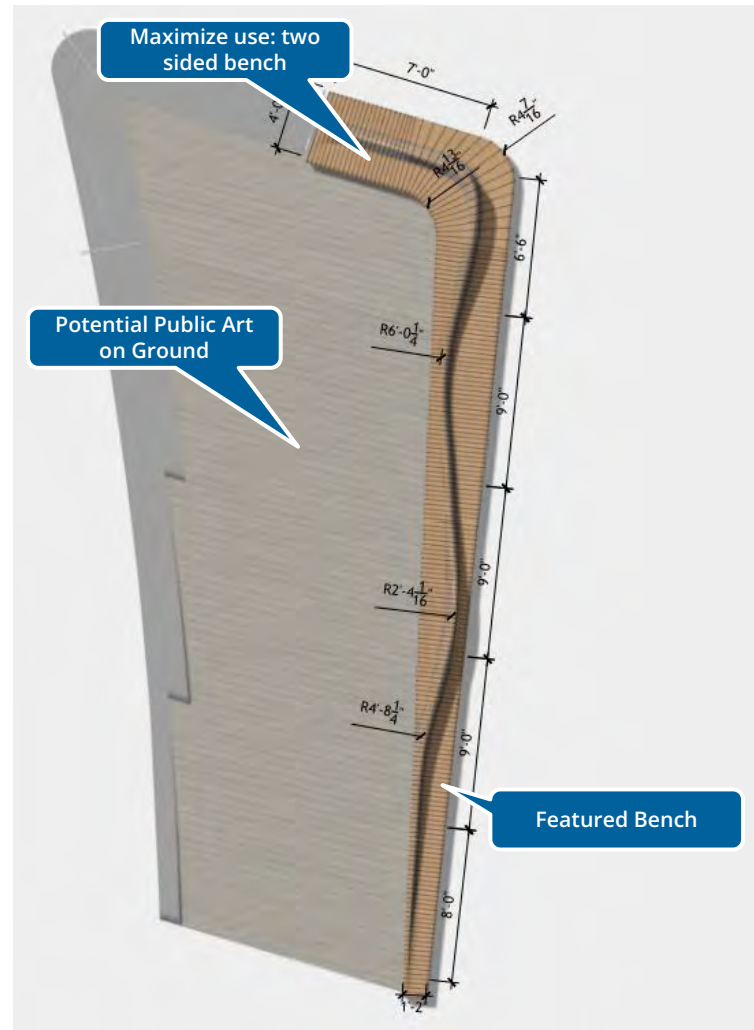
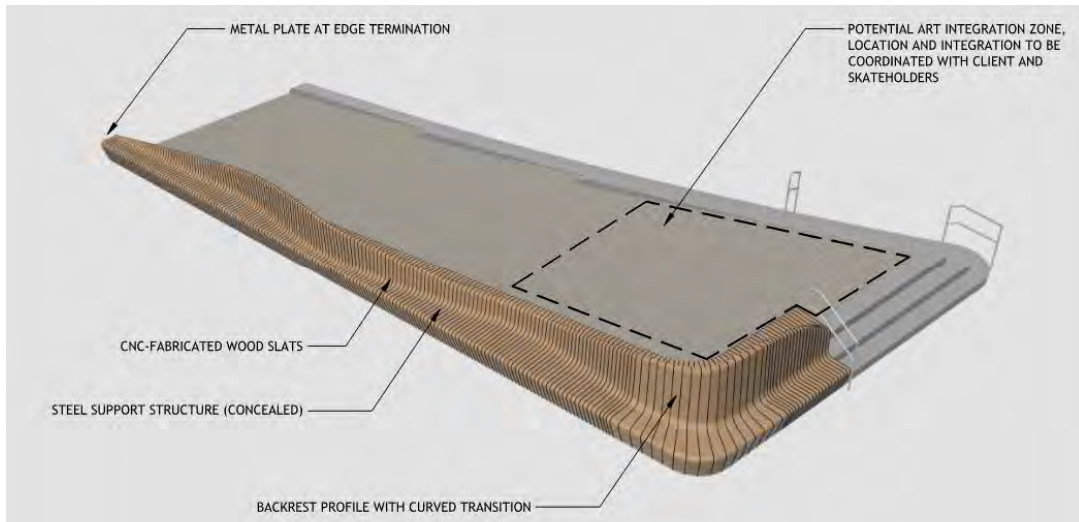
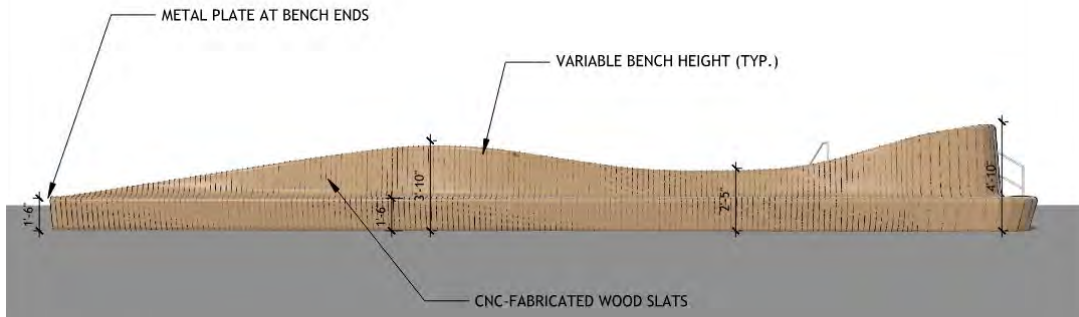

SkyLine Pier Section

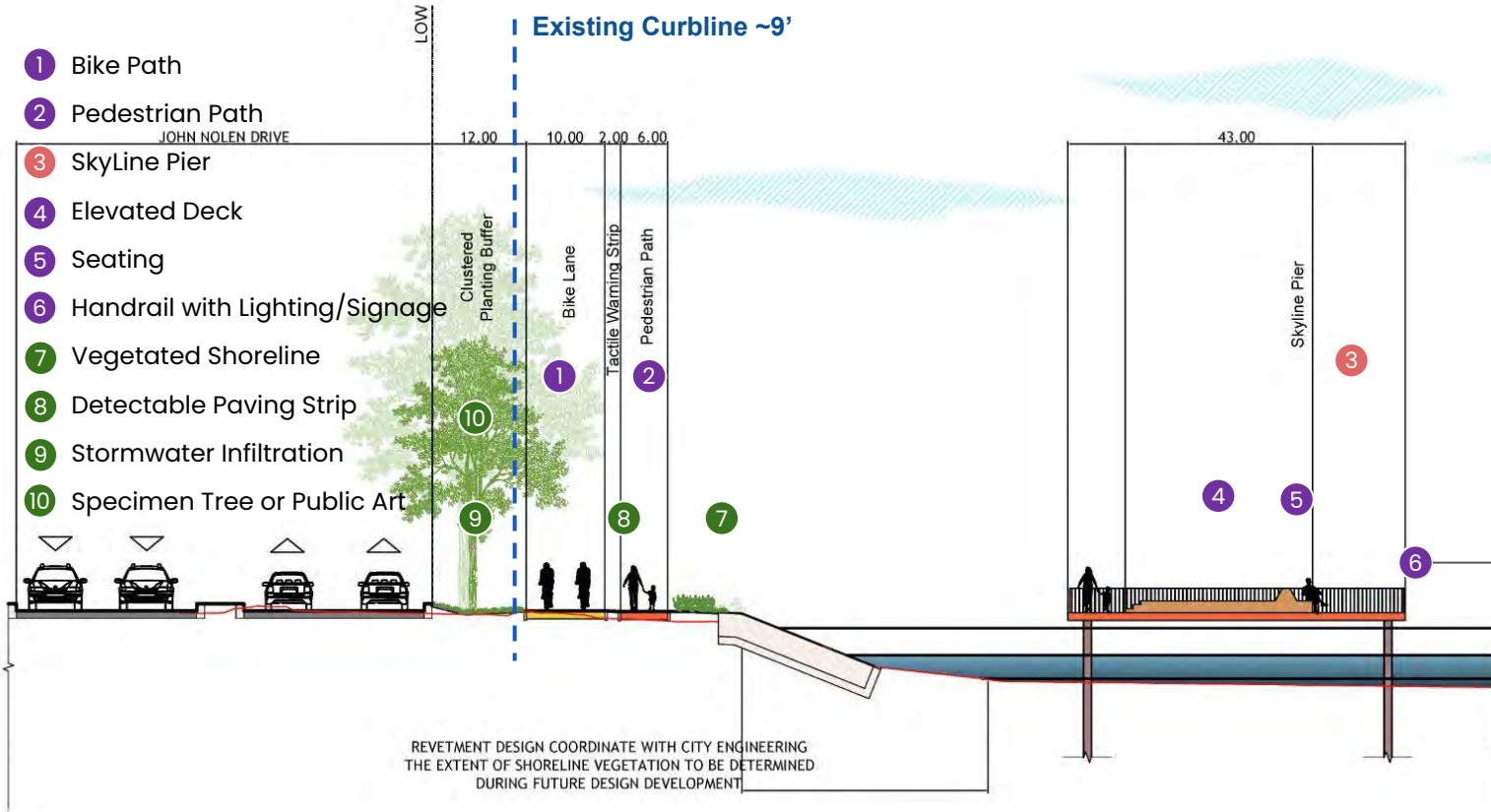
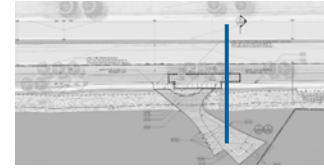

— Existing Topography
--- Limit of Work



Existing Topography

Design Opportunities

StoryWalk



Water-inspired Pavement Art at Special Locations



Paving and StoryWalk



Pavement Markings at Selective Locations

SkyLine Pier Experience



An aerial photograph of a river and surrounding urban areas, overlaid with a semi-transparent blue layer. A light blue path is highlighted along the riverbank, following the curve of the river. The path is bordered by green areas representing vegetation. The text 'Story Walk' is centered in the blue area, with a small blue rectangle below it.

Story Walk



Starting with the Sacred Voices

Culture Dialogue

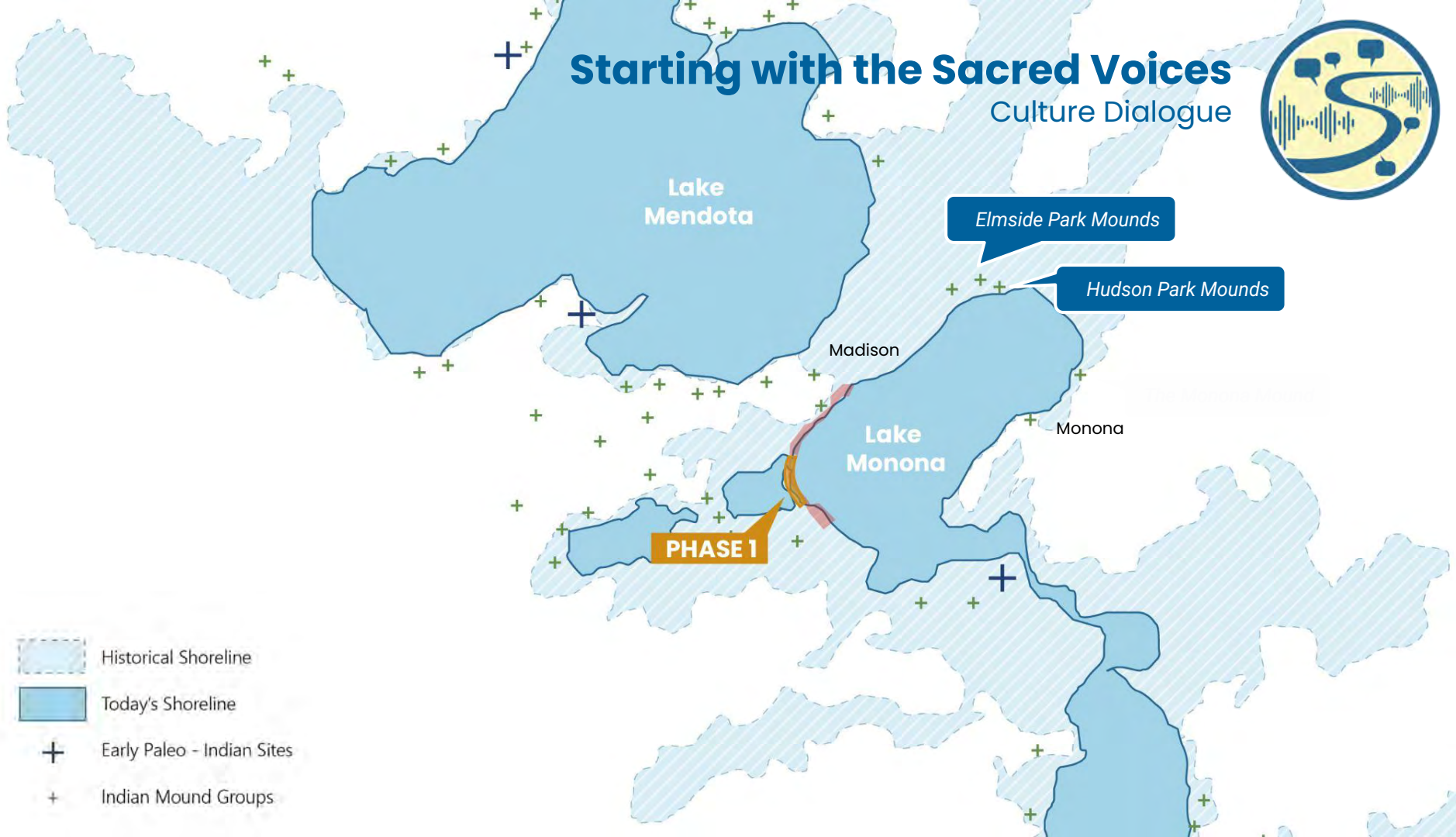

- A place for gift, prayer and offering to the water spirits. A quiet and meditative place.

Starting with the Sacred Voices

Culture Dialogue



- Harry Whitehorse came into this world in a wigwam near the Indian Mission in Black River Falls, Wisconsin, the traditional home of the Ho-Chunk people.

- The life of Harry Whitehorse from his website

“ This project is a touch point to incorporate thoughts on culture and history of people that came before us. ”

Chloris Lowe Jr.
Ho Chunk Nation

- Imagine what that timeless view would look like if the buildings were not there and the mounds remained.

- from an Interview with Samantha C. Skenandore,
Tribal Law Attorney

- If I have a religion, it must be canoeing...I canoe wherever there's water. It puts me in a totally different state of mind and provides all I need to exist.

- Truman Lowe

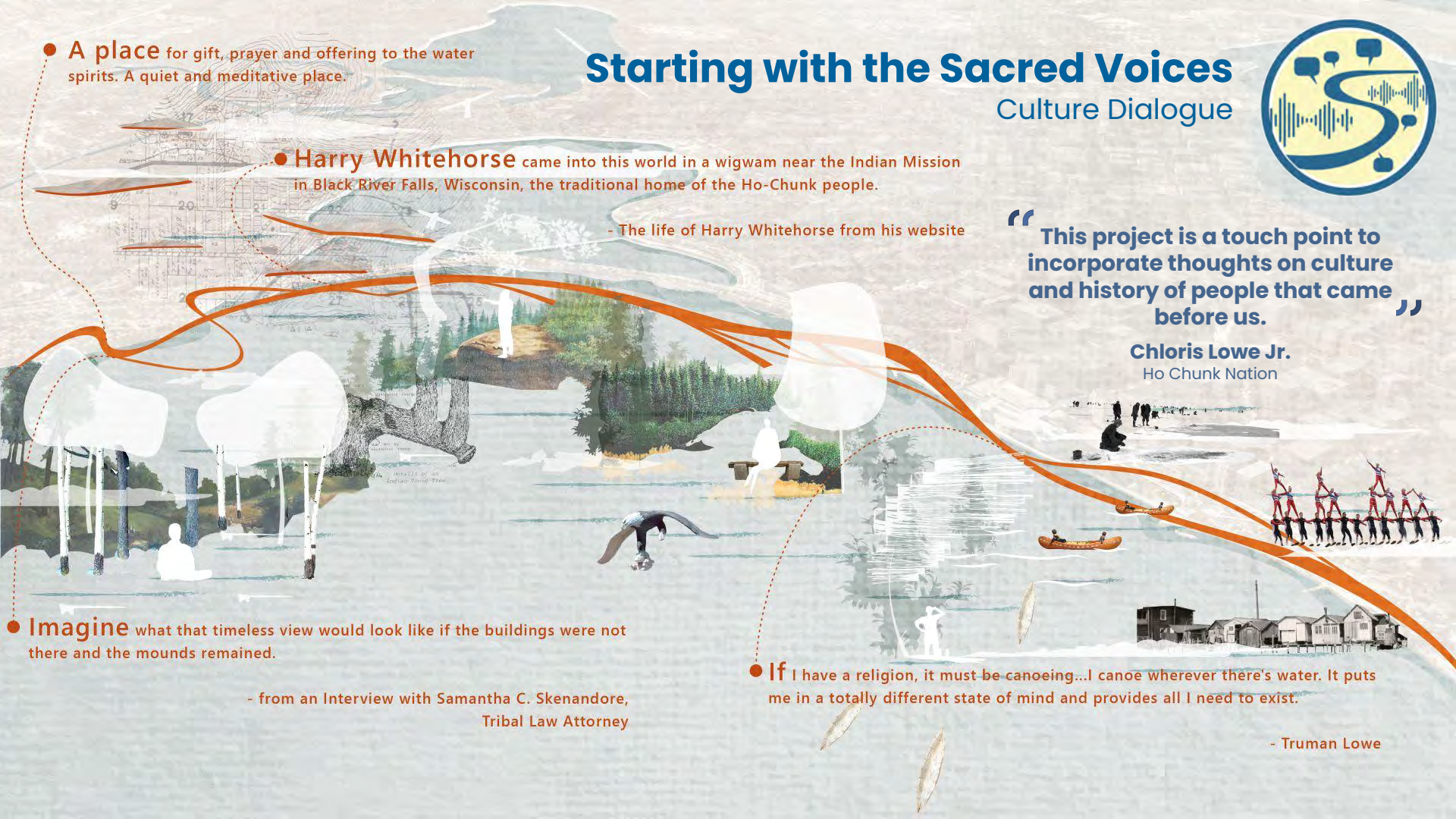



Enhance Equitable Access to Parks

Community Dialogue



Capitol Viewing

Fishing

Seasonal Lighting

Kayaking

Lake View



John Nolen Drive

Winter Art



Scenic Open Space

Fishing



Lake View

Ecological Education

Loop the Lake



Fishing



Lake View

Seasonal Lighting



Jogging



IRONMAN

Madison Marathon

N Shore Dr.

WARM
SEASON

YEAR-ROUND

COOL
SEASON





Winter Community Activities

Community Dialogue



Seasonal Lighting



Winter Capitol View



Winter Art

Capitol Viewing

Lake View

Seasonal Lighting

Winter Art

Lake View

Seasonal Lighting

Lake View



Lake View
Lake Art Viewing



Lake View
Ice Boating Viewing



Lake View
Winter Kiting Viewing





View towards the Capitol

View towards Hudson Park
Lizard Effigy Mound



0 100' 200' 400'

Nature Inspired

Tree Kinetic Wind
Art/Ecology/Science/
History Collaboration
Eco-art

Art on Paths/Surfaces

Art for Exploration

NATURE-INSPIRED

INTERACTIVE ART

ICONIC PIECE

ART IN BUILDING/ ON STRUCTURE

Design Opportunities



Ecology Magnifying Glasses



Railing Design with City's History



Dark-sky Lighting Design



Ecology Signage



Directional Signage



Paving and Story Walk



Special Paving Design at Key Destination

Public Art Opportunities

Ke-Chunk Ciiporoke sculpture
by Ho-Chunk artist Truman Lowe



Small Scale Art and Shade



Winter Art and Snow Art



Small Scale Light related Art



Local Art/Cultural Art/Communal Art



Small Scale Exploratory Art



Art on Paths



Eco/Natural Art



Kinetic Art

Madison LakeWay: Phase 1 Branding/Wayfinding



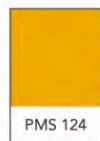

Opportunities



**BANNERS
ON LIGHT POLES**



**BANNERS
ON BANNER POLES**



TRAIL MARKER



**BIKE CORRAL
PAVEMENT PAINT**



LANE MARKER



**BIKE MADISON
MAP KIOSK**



DESTINATION ID



DIRECTIONAL POST

Vision for Wayfinding and Brand Integration

Inspiration from other districts

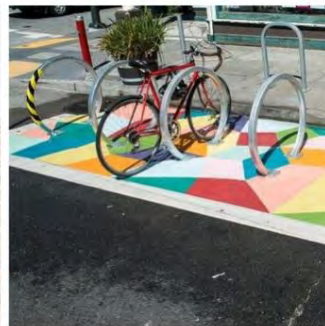

Wayfinding Signage System

Schematic Concepts

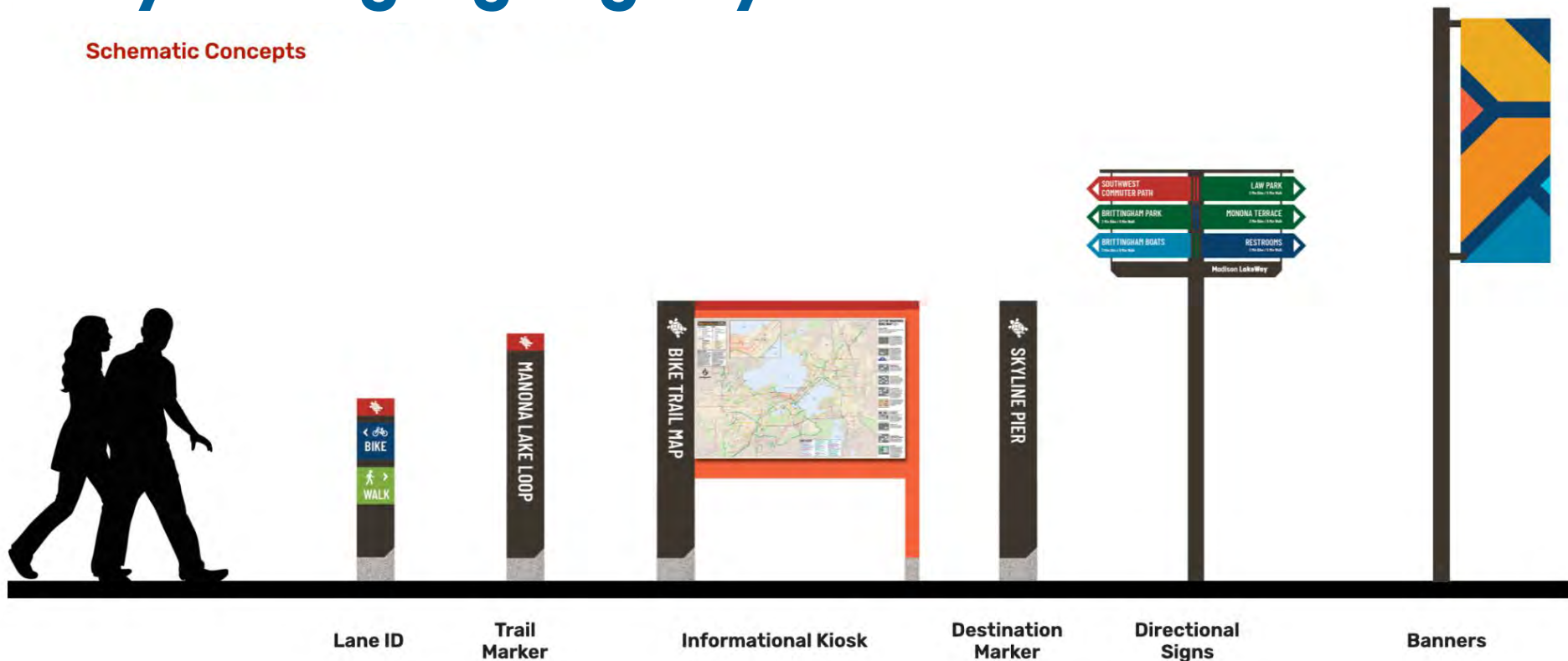

Branded Elements

Schematic Concepts



Sewer Cover



Tree Grate

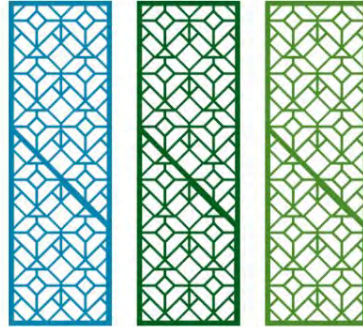

Trellis

(Sponsorship Donor
Recognition Opportunity)



Panel

(Sponsorship Donor
Recognition Opportunity)



**Concrete
Patterning**



Pavement Markings

Pavement Markings

- Provide tactile and visual interest throughout the district
- Use as a secondary wayfinding tool at primary destinations



Vision Images



Destination entrance

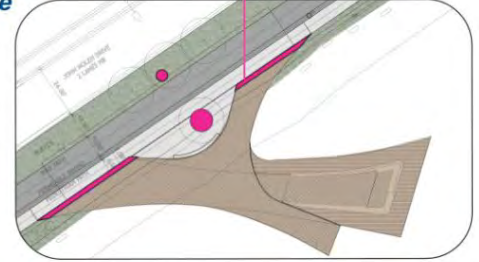

Bike corrals

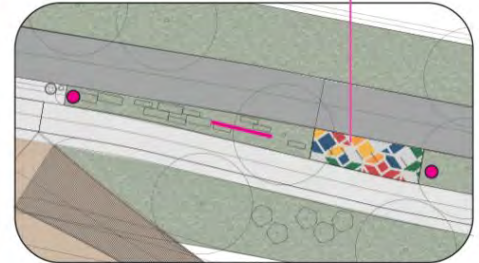



MadisonLakeWay.org





Next Steps

Please take our survey after this presentation

- ☐ Survey will open at the conclusion of the meeting
- ☐ Survey will close on [August 4, 2025](#)

Design Review

- ☐ Interagency Workshop
- ☐ Coordination with John Nolen Drive Re-construction Team
- ☐ Continuous collaboration with Madison LakeWay Partners

Construction Documentation

We would love to hear from you

Survey is now open, and will close on **August 4, 2025**.

Please take the survey here:

<https://www.surveymonkey.com/r/MadisonLakeWayPIM2>

Or use the QR Code below



Thank you for your participation!

For more information, please visit the project website:
cityofmadison.com/madisonlakeway



Thank you!

