

City of Madison
 Department of Public Works
PARKS DIVISION
 330 E Lakeside ST.
 Madison, WI 53715

**MADISON
 PARKS**

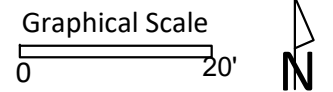

PROJECT:
**2026 PLAYGROUNDS -
 SET 2**

PROJECT ADDRESS:

Although every effort has been made in preparing these plans and checking them for accuracy, the contractor and subcontractors must check all details and dimensions of their trade and be responsible for the same.

ITEM	DATE
ADVERTISED TO BID	2026-xx-xx

PUBLIC WORKS PROJECT #:
#TBD

SHEET TITLE:

SHEET NUMBER:

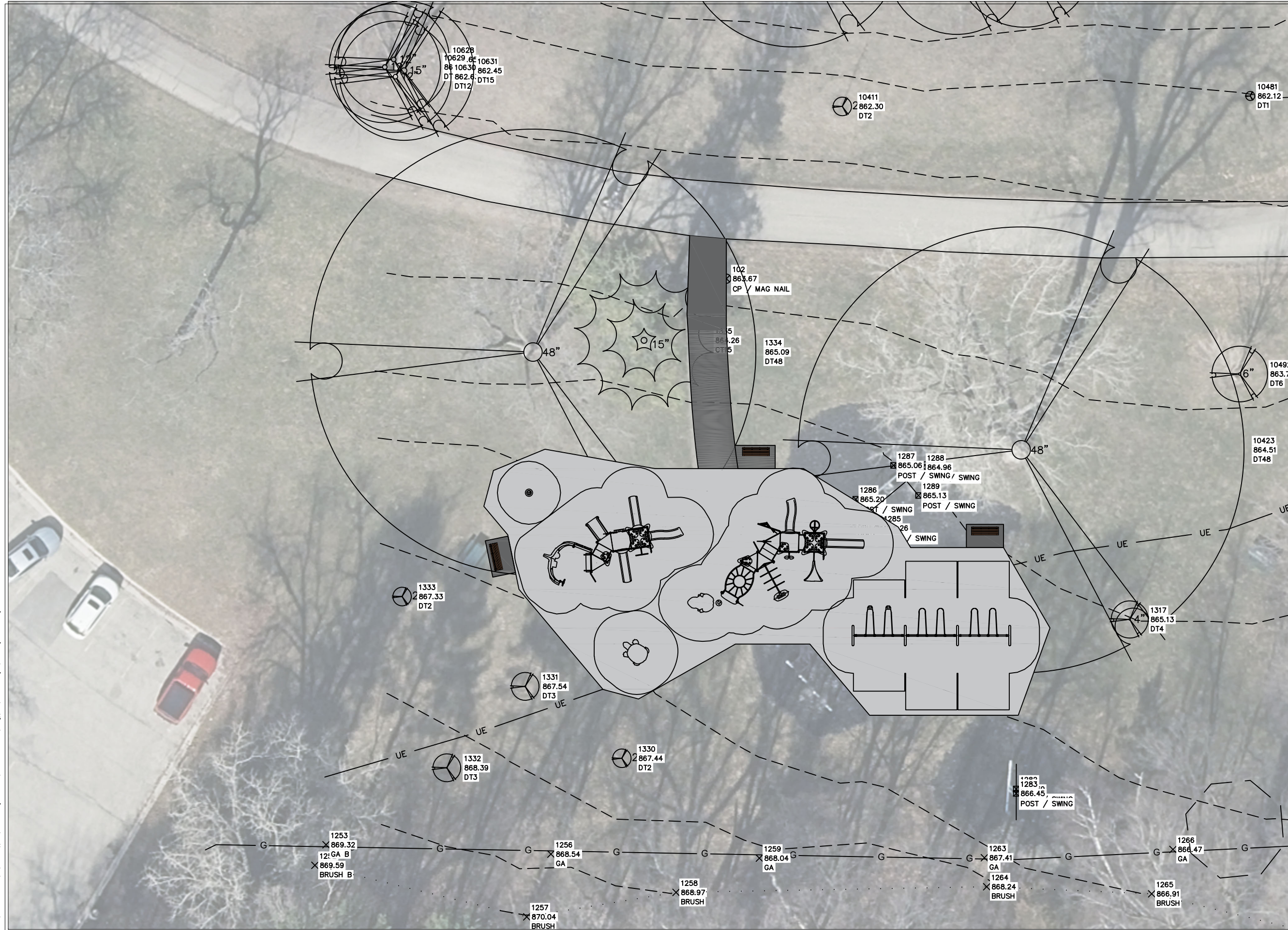

M:\Maps\parks\Marshall\Playground 2026\Marshall Park layouts.dwg



Parks Playground Equipment RFP #12087-0-2023-BG

Marshall Park Playground





5-12 Structure





2-5 Structure





2-5 Structure



5-12 Structure



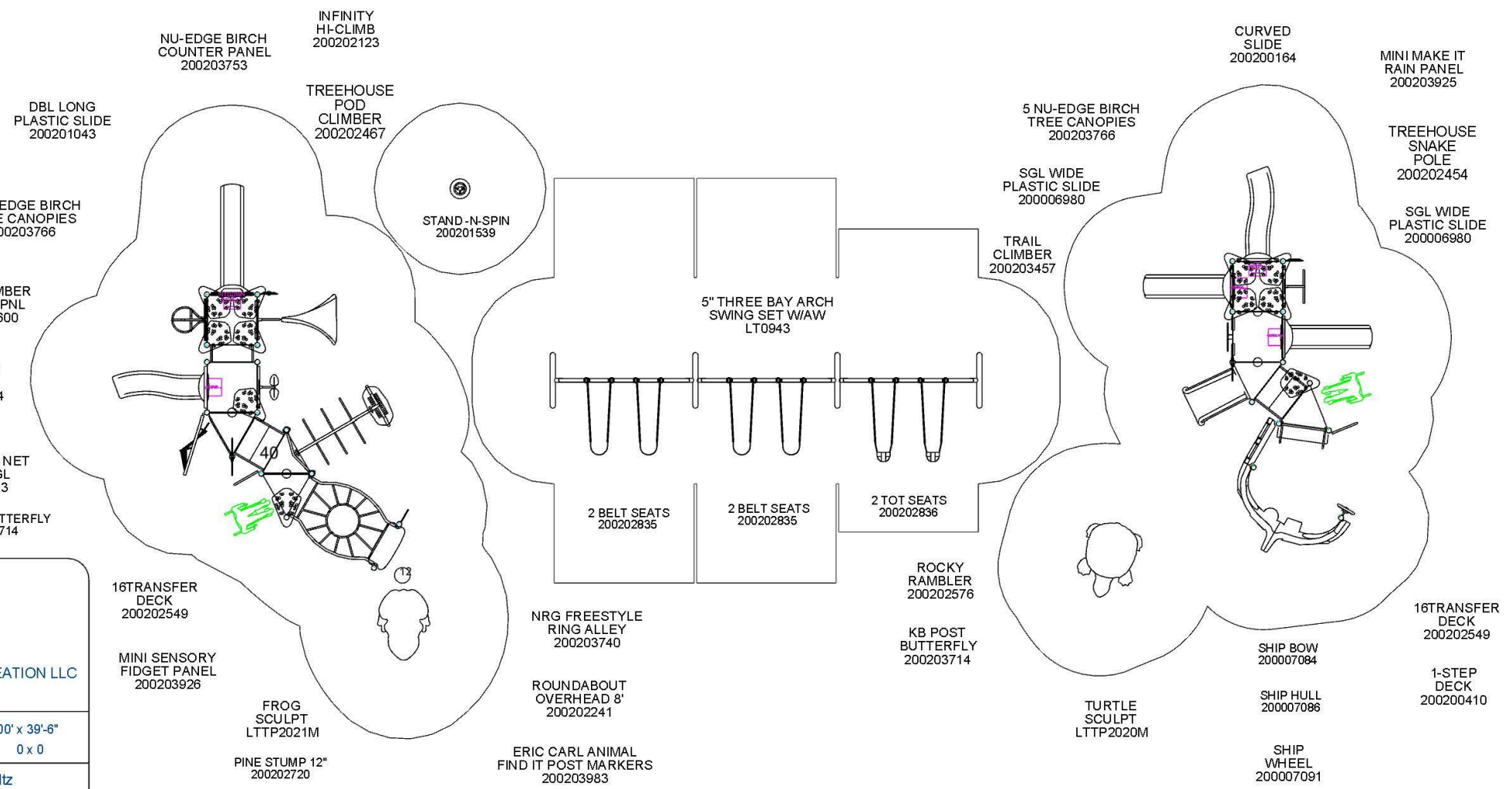

PROJECT:
MARSHALL PARK
LTCPS REP:
 Erica Steltz
 NORTHLAND RECREATION LLC
 Enter Phone No.

GROUND SPACE: 100' x 39'-6"
PROTECTIVE AREA: 0 x 0

DRAWN BY: Erica Steltz
DATE: 03/11/2026
PROJECT: 25019756

LTCPS - FARMINGTON
 878 EAST HIGHWAY 60
 MONETT MO 65708
 VOICE: 1-800-325-8828
 FAX: 417-354-2273

PLAYGROUND LAYOUT COMPLIANCE: