



Madison Metro Transit System



1101 East Washington Avenue
Madison, Wisconsin 53703
Administrative Office: 608 266 4904
Fax: 608 267 8778

March 8, 2006

TO: Plan Commission

FROM: Timothy Sobota, Transit Planner, Metro Transit

SUBJECT: **72 West Towne Mall – Granite City Food & Brewery**

Metro Transit has reviewed the subject development and has the following comments.

MAJOR OR NON-STANDARD REVIEW COMMENTS (Comments which are special to the project and/or may require additional work beyond a standard, more routine project.)

1. The developer shall install and maintain all infrastructure necessary to suitably relocate the existing West Towne Mall bus stop that would be displaced by the proposed expansion.
2. The new bus stop location must be situated in the area between the Mall Entrance and Gammon Road so as to maintain or ideally decrease the distance currently traveled through the parking lot and thereby avoiding impacts to the existing schedules.
3. The new bus stop infrastructure shall include the following items at a minimum:
 - Accessible pedestrian access from the Mall Entrance to a bus stop boarding island (i.e. curb ramps & crosswalks).
 - A concrete or other reinforced slab for a stopped bus, not blocking any travel lanes, measuring at least 10' wide by 80' long.
 - A passenger boarding zone, located adjacent the front door a stopped bus, clear of any landscape items and measuring 6' wide (parallel to travel lane) by 8' deep (from back of curb). The remaining passenger boarding island parallel to the bus slab must be clear at least 5' deep.
 - In the immediate vicinity of the passenger boarding zone: A trash receptacle, a shelter with enclosed bench (128 square feet or larger), additional benches or other seating amenity (10 people or more); and vertical separation between the passenger waiting area and any adjacent parking stalls (i.e. 18"-36" high wall or other landscaping elements) – for the length of the island.
4. The developer shall include the design and locations of the proposed elements of the new bus stop on the final documents filed with their permit application so that Metro Transit may review and approve the design.
5. An accessible bus stop must be maintained at all times during site construction work. Any required modifications to the location of the bus stop shall require 5 working days notice to Metro Transit.

GENERAL OR STANDARD REVIEW COMMENTS

In addition, we offer the following General or Standard Review Comments:

6. Metro Transit operates bus service seven days a week along the Gammon Road frontage of West Towne Mall, with a bus stop immediately north of the entrance corridor adjacent Sears. The developer currently maintains a bench at this location.

March 10, 2006

Page 2

7. Metro Transit serves three additional stops on the “ring road” surrounding the Mall (near the Chili’s, Blockbuster, and Toy R Us lots), as well as two stops on West Towne Way extended adjacent the Cub Foods and Kohl’s lots. The developer made accessibility improvements at these locations as part of the Toy R Us improvements.
8. The developer has proposed a site east of the Mall Entrance on the “ring road” for the relocated bus stop, as shown on the attached page.
9. Metro Transit requests to sign and review final documents submitted for this project.

Please contact Tim Sobota, Metro Transit at 261-4289
or by email at <tsobota@cityodmadison.com>
if you have questions regarding the above items.

CC: Project contact person, Carl Frey: cfrey@kainc.com (email)

Atch. Exhibit page “Proposed Site Plan” [02/28/2006]

SEARS
113,503 SF
ONE LEVEL

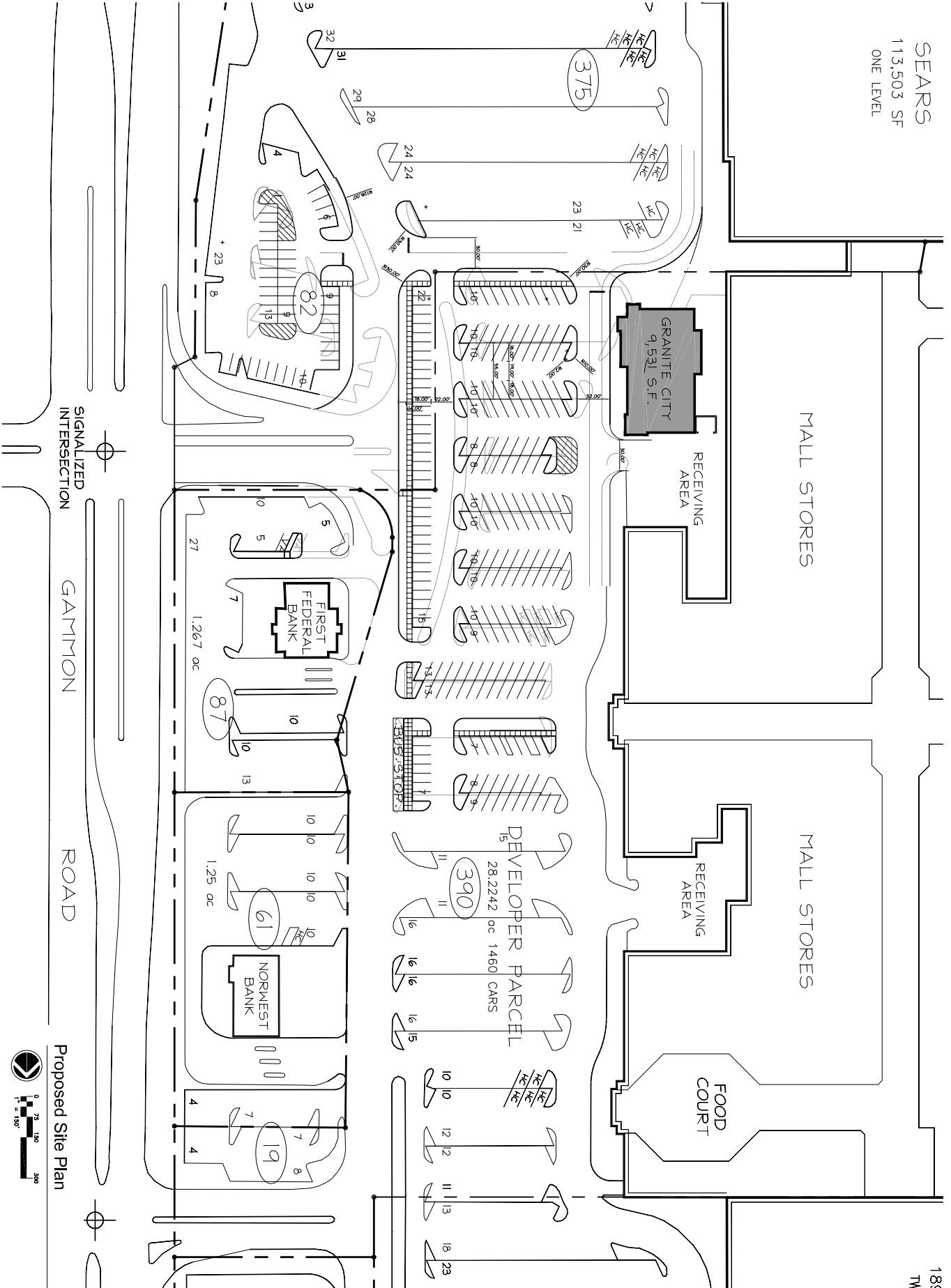

185
TW

SIGNALIZED
INTERSECTION

GAMMON

ROAD

Proposed Site Plan



1468 West 9 th Street, #100 Des Moines, Iowa 50314 216.781.9144 fax 216.781.6564 www.koehn.com	<p>The Architecture of Life</p>	West Towne Mall Madison, WI
		28 FEB 2006 Revisions: 28 FEB 2006 No. Description
28 FEB 2006 28 FEB 2006	Administered Use: <input checked="" type="checkbox"/> Design Development <input checked="" type="checkbox"/> Program <input checked="" type="checkbox"/> Siting <input checked="" type="checkbox"/> Utility & Permit <input checked="" type="checkbox"/> Construction	Sheet Description: Proposed Site Plan
Drawing # SP	Project # 02	Designer 02