

WISCONSIN INSTITUTE FOR DISCOVERY THE MORGRIDGE INSTITUTE FOR RESEARCH

UNIVERSITY OF WISCONSIN MADISON, WISCONSIN

SIP SUBMISSION

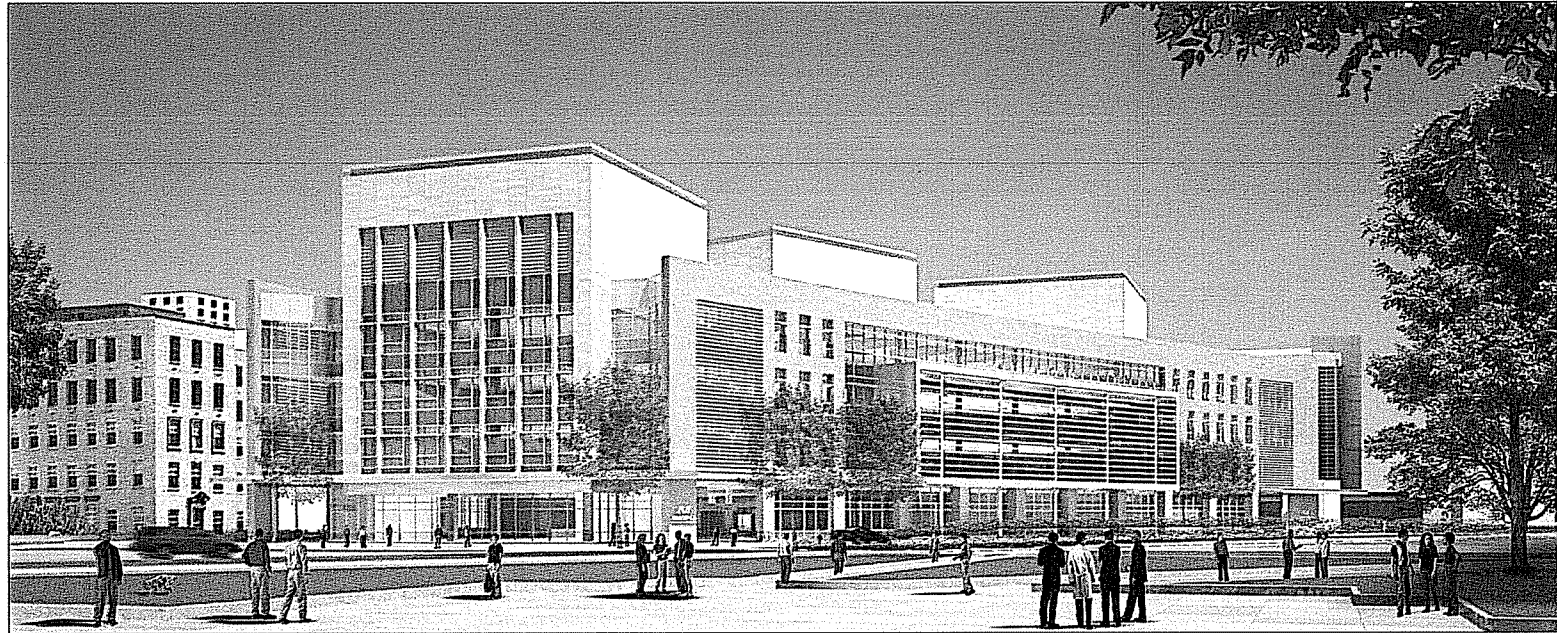

PERSPECTIVE VIEW FROM SOUTHWEST

GENERAL DRAWINGS

- 0001 COVER SHEET
- CIVIL DRAWINGS**
- C101 BOUNDARY AND TOPOGRAPHIC SURVEY - SHEET 1 OF 2
- C102 BOUNDARY AND TOPOGRAPHIC SURVEY - SHEET 2 OF 2
- C301 SITE DEMONSTRATION PLAN
- C302 SITE PLAN
- C303 GRADING DRAINAGE AND EROSION CONTROL PLAN
- C304 NORTH SCHEDULE PLAN

FIRE DEPARTMENT ACCESS

- F010 FIRE DEPARTMENT ACCESS SITE PLAN

LANDSCAPE DRAWINGS

- L101 MATERIALS PLAN
- L201 PLANTING PLAN-OVERALL TREES
- L202 PLANTING PLAN-ENLARGED UNDERSTORY PLAN
- L203 PLANTING PLAN-ENLARGED UNDERSTORY PLAN
- L204 PLANTING PLAN-ENLARGED UNDERSTORY PLAN
- L205 PLANTING SCHEDULE
- L301 SECTIONS
- L302 SECTIONS
- L401 SITE DETAILS
- L402 PLANTING SCHEDULE

ARCHITECTURAL DRAWINGS

- A100 LOWER LEVEL FLOOR PLAN
- A101 GROUND FLOOR PLAN
- A102 SECOND FLOOR PLAN
- A103 THIRD FLOOR PLAN
- A104 FOURTH FLOOR PLAN
- A105 PERIPHERAL FLOOR PLAN
- A106 ROOF PLAN
- A301 NORTH & SOUTH ELEVATIONS
- A302 EAST & WEST ELEVATIONS

ELECTRICAL DRAWINGS

- E3100 SITE LIGHTING PLAN
- E3101 SITE PHOTOGRAPHIC LIGHTING PLAN

SITE UTILIZATION DRAWINGS (DURING CONSTRUCTION)

- S0101 SITE FENCE PLAN
- S0102 FENCE DETAILS

DRAWING NUMBER

G001

SEAL

Key Plan

WISCONSIN INSTITUTE FOR DISCOVERY
Wisconsin Institute for Discovery
The Morgridge Institute for Research

Ballinger
ARCHITECTURAL ENGINEERING PLANNING INTERIOR DESIGN

UIHLEIN WILSON ARCHITECTS
UIHLEIN/WILSON ARCHITECTS
322 East Lakeside Drive
Madison, WI 53706
T. 608.271.8800 F. 608.271.8812

DATE: 08/11/11
PROJECT: WISCONSIN INSTITUTE FOR DISCOVERY
SHEET: G001 OF 001
SCALE: NOT TO SCALE
DRAWN BY: JAL
CHECKED BY: GDI
DATE: 08/02/10
SCALE: NTD

DRAWING ISSUE

DATE	BY	REVISION
08/02/10	GDI	NTD

ARCHITECTURE

DRAWING TITLE

DRAWING LIST, SYMBOLS & ABBREVIATIONS

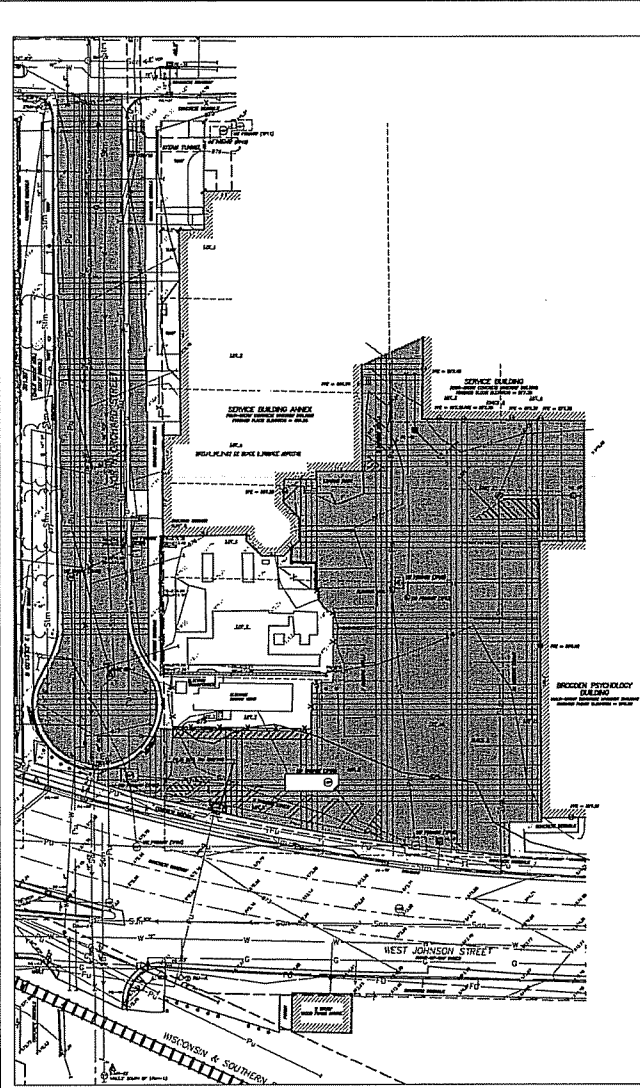

SUMMARY SEWER MANHOLES					STORM SEWER MANHOLES					STORM SEWER PILETS				
SEWER ID	HW ELEVATION	ANNECT	ELDV	TYPE	SEWER ID	HW ELEVATION	ANNECT	ELDV	TYPE	PILET ID	HW ELEVATION	ANNECT	ELDV	TYPE
SMW-1	874.17	SM	874.17	18"	STM-1	874.37	SM	874.37	18"	SM-1	874.11	SM	874.11	18"
SMW-2	874.27	SM	874.27	18"	STM-2	874.18	SM	874.18	18"	SM-2	874.11	SM	874.11	18"
SMW-3	874.37	SM	874.37	18"	STM-3	874.28	SM	874.28	18"	SM-3	874.11	SM	874.11	18"
SMW-4	874.47	SM	874.47	18"	STM-4	874.38	SM	874.38	18"	SM-4	874.11	SM	874.11	18"
SMW-5	874.57	SM	874.57	18"	STM-5	874.48	SM	874.48	18"	SM-5	874.11	SM	874.11	18"
SMW-6	874.67	SM	874.67	18"	STM-6	874.58	SM	874.58	18"	SM-6	874.11	SM	874.11	18"
SMW-7	874.77	SM	874.77	18"	STM-7	874.68	SM	874.68	18"	SM-7	874.11	SM	874.11	18"
SMW-8	874.87	SM	874.87	18"	STM-8	874.78	SM	874.78	18"	SM-8	874.11	SM	874.11	18"
SMW-9	874.97	SM	874.97	18"	STM-9	874.88	SM	874.88	18"	SM-9	874.11	SM	874.11	18"
SMW-10	875.07	SM	875.07	18"	STM-10	874.98	SM	874.98	18"	SM-10	874.11	SM	874.11	18"
SMW-11	875.17	SM	875.17	18"	STM-11	875.08	SM	875.08	18"	SM-11	874.11	SM	874.11	18"
SMW-12	875.27	SM	875.27	18"	STM-12	875.18	SM	875.18	18"	SM-12	874.11	SM	874.11	18"
SMW-13	875.37	SM	875.37	18"	STM-13	875.28	SM	875.28	18"	SM-13	874.11	SM	874.11	18"
SMW-14	875.47	SM	875.47	18"	STM-14	875.38	SM	875.38	18"	SM-14	874.11	SM	874.11	18"
SMW-15	875.57	SM	875.57	18"	STM-15	875.48	SM	875.48	18"	SM-15	874.11	SM	874.11	18"
SMW-16	875.67	SM	875.67	18"	STM-16	875.58	SM	875.58	18"	SM-16	874.11	SM	874.11	18"
SMW-17	875.77	SM	875.77	18"	STM-17	875.68	SM	875.68	18"	SM-17	874.11	SM	874.11	18"
SMW-18	875.87	SM	875.87	18"	STM-18	875.78	SM	875.78	18"	SM-18	874.11	SM	874.11	18"
SMW-19	875.97	SM	875.97	18"	STM-19	875.88	SM	875.88	18"	SM-19	874.11	SM	874.11	18"
SMW-20	876.07	SM	876.07	18"	STM-20	875.98	SM	875.98	18"	SM-20	874.11	SM	874.11	18"
SMW-21	876.17	SM	876.17	18"	STM-21	876.08	SM	876.08	18"	SM-21	874.11	SM	874.11	18"
SMW-22	876.27	SM	876.27	18"	STM-22	876.18	SM	876.18	18"	SM-22	874.11	SM	874.11	18"
SMW-23	876.37	SM	876.37	18"	STM-23	876.28	SM	876.28	18"	SM-23	874.11	SM	874.11	18"
SMW-24	876.47	SM	876.47	18"	STM-24	876.38	SM	876.38	18"	SM-24	874.11	SM	874.11	18"
SMW-25	876.57	SM	876.57	18"	STM-25	876.48	SM	876.48	18"	SM-25	874.11	SM	874.11	18"
SMW-26	876.67	SM	876.67	18"	STM-26	876.58	SM	876.58	18"	SM-26	874.11	SM	874.11	18"
SMW-27	876.77	SM	876.77	18"	STM-27	876.68	SM	876.68	18"	SM-27	874.11	SM	874.11	18"
SMW-28	876.87	SM	876.87	18"	STM-28	876.78	SM	876.78	18"	SM-28	874.11	SM	874.11	18"
SMW-29	876.97	SM	876.97	18"	STM-29	876.88	SM	876.88	18"	SM-29	874.11	SM	874.11	18"
SMW-30	877.07	SM	877.07	18"	STM-30	876.98	SM	876.98	18"	SM-30	874.11	SM	874.11	18"
SMW-31	877.17	SM	877.17	18"	STM-31	877.08	SM	877.08	18"	SM-31	874.11	SM	874.11	18"
SMW-32	877.27	SM	877.27	18"	STM-32	877.18	SM	877.18	18"	SM-32	874.11	SM	874.11	18"
SMW-33	877.37	SM	877.37	18"	STM-33	877.28	SM	877.28	18"	SM-33	874.11	SM	874.11	18"
SMW-34	877.47	SM	877.47	18"	STM-34	877.38	SM	877.38	18"	SM-34	874.11	SM	874.11	18"
SMW-35	877.57	SM	877.57	18"	STM-35	877.48	SM	877.48	18"	SM-35	874.11	SM	874.11	18"
SMW-36	877.67	SM	877.67	18"	STM-36	877.58	SM	877.58	18"	SM-36	874.11	SM	874.11	18"
SMW-37	877.77	SM	877.77	18"	STM-37	877.68	SM	877.68	18"	SM-37	874.11	SM	874.11	18"
SMW-38	877.87	SM	877.87	18"	STM-38	877.78	SM	877.78	18"	SM-38	874.11	SM	874.11	18"
SMW-39	877.97	SM	877.97	18"	STM-39	877.88	SM	877.88	18"	SM-39	874.11	SM	874.11	18"
SMW-40	878.07	SM	878.07	18"	STM-40	877.98	SM	877.98	18"	SM-40	874.11	SM	874.11	18"
SMW-41	878.17	SM	878.17	18"	STM-41	878.08	SM	878.08	18"	SM-41	874.11	SM	874.11	18"
SMW-42	878.27	SM	878.27	18"	STM-42	878.18	SM	878.18	18"	SM-42	874.11	SM	874.11	18"
SMW-43	878.37	SM	878.37	18"	STM-43	878.28	SM	878.28	18"	SM-43	874.11	SM	874.11	18"
SMW-44	878.47	SM	878.47	18"	STM-44	878.38	SM	878.38	18"	SM-44	874.11	SM	874.11	18"
SMW-45	878.57	SM	878.57	18"	STM-45	878.48	SM	878.48	18"	SM-45	874.11	SM	874.11	18"
SMW-46	878.67	SM	878.67	18"	STM-46	878.58	SM	878.58	18"	SM-46	874.11	SM	874.11	18"
SMW-47	878.77	SM	878.77	18"	STM-47	878.68	SM	878.68	18"	SM-47	874.11	SM	874.11	18"
SMW-48	878.87	SM	878.87	18"	STM-48	878.78	SM	878.78	18"	SM-48	874.11	SM	874.11	18"
SMW-49	878.97	SM	878.97	18"	STM-49	878.88	SM	878.88	18"	SM-49	874.11	SM	874.11	18"
SMW-50	879.07	SM	879.07	18"	STM-50	878.98	SM	878.98	18"	SM-50	874.11	SM	874.11	18"
SMW-51	879.17	SM	879.17	18"	STM-51	879.08	SM	879.08	18"	SM-51	874.11	SM	874.11	18"
SMW-52	879.27	SM	879.27	18"	STM-52	879.18	SM	879.18	18"	SM-52	874.11	SM	874.11	18"
SMW-53	879.37	SM	879.37	18"	STM-53	879.28	SM	879.28	18"	SM-53	874.11	SM	874.11	18"
SMW-54	879.47	SM	879.47	18"	STM-54	879.38	SM	879.38	18"	SM-54	874.11	SM	874.11	18"
SMW-55	879.57	SM	879.57	18"	STM-55	879.48	SM	879.48	18"	SM-55	874.11	SM	874.11	18"
SMW-56	879.67	SM	879.67	18"	STM-56	879.58	SM	879.58	18"	SM-56	874.11	SM	874.11	18"
SMW-57	879.77	SM	879.77	18"	STM-57	879.68	SM	879.68	18"	SM-57	874.11	SM	874.11	18"
SMW-58	879.87	SM	879.87	18"	STM-58	879.78	SM	879.78	18"	SM-58	874.11	SM	874.11	18"
SMW-59	879.97	SM	879.97	18"	STM-59	879.88	SM	879.88	18"	SM-59	874.11	SM	874.11	18"
SMW-60	880.07	SM	880.07	18"	STM-60	879.98	SM	879.98	18"	SM-60	874.11	SM	874.11	18"

LWP - PRIMARY STRUCTURES				BENCHMARKS			
WALL ID	LENGTH	START POINT	END POINT	MARK	ELEVATION	DESCRIPTION	REMARKS
W-1	100.00	874.17	875.17	BM-1	874.11	TOP CORNER OF CONCRETE OF	APPROX. 10' FROM CORNER OF
W-2	100.00	875.17	876.17	BM-2	875.11	TOP CORNER OF CONCRETE OF	APPROX. 10' FROM CORNER OF
W-3	100.00	876.17	877.17	BM-3	876.11	TOP CORNER OF CONCRETE OF	APPROX. 10' FROM CORNER OF
W-4	100.00	877.17	878.17	BM-4	877.11	TOP CORNER OF CONCRETE OF	APPROX. 10' FROM CORNER OF
W-5	100.00	878.17	879.17	BM-5	878.11	TOP CORNER OF CONCRETE OF	APPROX. 10' FROM CORNER OF
W-6	100.00	879.17	880.17	BM-6	879.11	TOP CORNER OF CONCRETE OF	APPROX. 10' FROM CORNER OF
W-7	100.00	880.17	881.17	BM-7	880.11	TOP CORNER OF CONCRETE OF	APPROX. 10' FROM CORNER OF
W-8	100.00	881.17	882.17	BM-8	881.11	TOP CORNER OF CONCRETE OF	APPROX. 10' FROM CORNER OF
W-9	100.00	882.17	883.17	BM-9	882.11	TOP CORNER OF CONCRETE OF	APPROX. 10' FROM CORNER OF
W-10	100.00	883.17	884.17	BM-10	883.11	TOP CORNER OF CONCRETE OF	APPROX. 10' FROM CORNER OF
W-11	100.00	884.17	885.17	BM-11	884.11	TOP CORNER OF CONCRETE OF	APPROX. 10' FROM CORNER OF
W-12	100.00	885.17	886.17	BM-12	885.11	TOP CORNER OF CONCRETE OF	APPROX. 10' FROM CORNER OF
W-13	100.00	886.17	887.17	BM-13	886.11	TOP CORNER OF CONCRETE OF	APPROX. 10' FROM CORNER OF
W-14	100.00	887.17	888.17	BM-14	887.11	TOP CORNER OF CONCRETE OF	APPROX. 10' FROM CORNER OF
W-15	100.00	888.17	889.17	BM-15	888.11	TOP CORNER OF CONCRETE OF	APPROX. 10' FROM CORNER OF
W-16	100.00	889.17	890.17	BM-16	889.11	TOP CORNER OF CONCRETE OF	APPROX. 10' FROM CORNER OF
W-17	100.00	890.17	891.17	BM-17	890.11	TOP CORNER OF CONCRETE OF	APPROX. 10' FROM CORNER OF
W-18	100.00	891.17	892.17	BM-18	891.11	TOP CORNER OF CONCRETE OF	APPROX. 10' FROM CORNER OF
W-19	100.00	892.17	893.17	BM-19	892.11	TOP CORNER OF CONCRETE OF	APPROX. 10' FROM CORNER OF
W-20	100.00	893.17	894.17	BM-20	893.11	TOP CORNER OF CONCRETE OF	APPROX. 10' FROM CORNER OF
W-21	100.00	894.17	895.17	BM-21	894.11	TOP CORNER OF CONCRETE OF	APPROX. 10' FROM CORNER OF
W-22	100.00	895.17	896.17	BM-22	895.11	TOP CORNER OF CONCRETE OF	APPROX. 10' FROM CORNER OF
W-23	100.00	896.17	897.17	BM-23	896.11	TOP CORNER OF CONCRETE OF	APPROX. 10' FROM CORNER OF
W-24	100.00	897.17	898.17	BM-24	897.11	TOP CORNER OF CONCRETE OF	APPROX. 10' FROM CORNER OF
W-25	100.00	898.17	899.17	BM-25	898.11	TOP CORNER OF CONCRETE OF	APPROX. 10' FROM CORNER OF
W-26	100.00	899.17	900.17	BM-26	899.11	TOP CORNER OF CONCRETE OF	APPROX. 10' FROM CORNER OF
W-27	100.00	900.17	901.17	BM-27	900.11	TOP CORNER OF CONCRETE OF	APPROX. 10' FROM CORNER OF
W-28	100.00	901.17	902.17	BM-28	901.11	TOP CORNER OF CONCRETE OF	APPROX. 10' FROM CORNER OF
W-29	100.00	902.17	903.17	BM-29	902.11	TOP CORNER OF CONCRETE OF	APPROX. 10' FROM CORNER OF
W-30	100.00	903.17	904.17	BM-30	903.11	TOP CORNER OF CONCRETE OF	APPROX. 10' FROM CORNER OF
W-31	100.00	904.17	905.17	BM-31	904.11	TOP CORNER OF CONCRETE OF	APPROX. 10' FROM CORNER OF
W-32	100.00	905.17	906.17	BM-32	905.11	TOP CORNER OF CONCRETE OF	APPROX. 10' FROM CORNER OF
W-33	100.00	906.17	907.17	BM-33	906.11	TOP CORNER OF CONCRETE OF	APPROX. 10' FROM CORNER OF
W-34	100.00	907.17	908.17	BM-34	907.11	TOP CORNER OF CONCRETE OF	APPROX. 10' FROM CORNER OF
W-35	100.00	908.17	909.17	BM-35	908.11	TOP CORNER OF CONCRETE OF	APPROX. 10' FROM CORNER OF
W-36	100.00	909.17	910.17	BM-36	909.11	TOP CORNER OF CONCRETE OF	APPROX. 10' FROM CORNER OF
W-37	100.00	910.17	911.17	BM-37	910.11	TOP CORNER OF CONCRETE OF	APPROX. 10' FROM CORNER OF
W-38	100.00	911.17	912.17	BM-38	91		

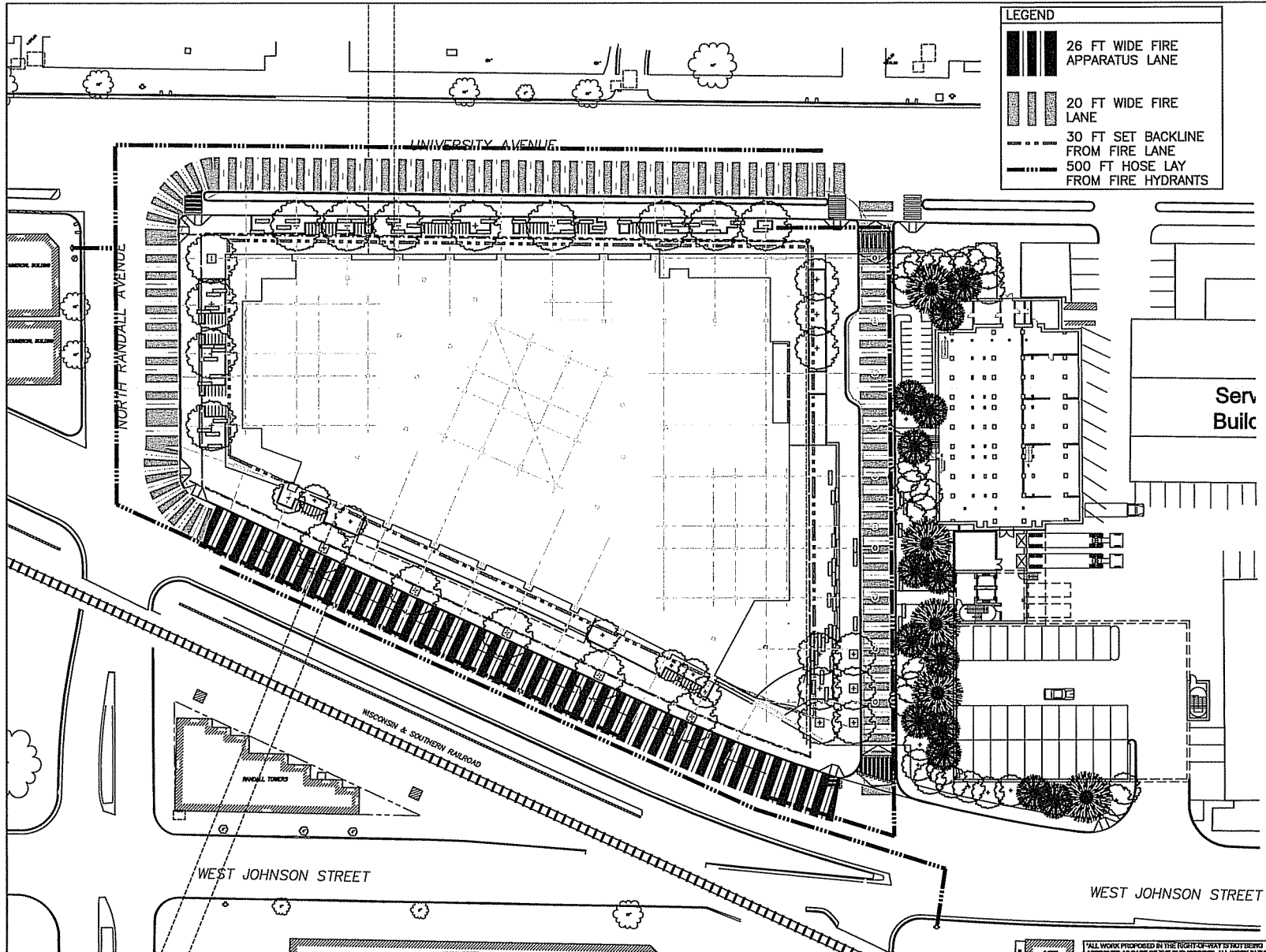

LEGEND

- 26 FT WIDE FIRE APPARATUS LANE
- 20 FT WIDE FIRE LANE
- 30 FT SET BACKLINE FROM FIRE LANE
- 500 FT HOSE LAY FROM FIRE HYDRANTS

DRAWING NUMBER
FD100

SEAL

Key Plan

DISCOVERY
 Wisconsin Institute for Discovery
 The Mayo Clinic Institute for Research

Ballinger
 Architecture, Planning, Interiors
 233 Chestnut Street
 Philadelphia, PA 19106
 Tel: 215-381-2000 Fax: 215-381-2001
 www.ballinger.com

UIHLEIN WILSON
 ARCHITECTS
 1040 Walnut Avenue
 333 East Lakeside Street
 Milwaukee, WI 53212
 V. 414.271.8899 F. 414.271.8840

NO.	DESCRIPTION	DATE
1	DCP Floorplan	8.18.07
2	Revised S	8.24.07
3	MEP Floorplan	11.28.07
4	MEP Floorplan	12.11.07

DRAWING ISSUE

ISSUED BY	DATE	ISSUED BY	DATE
RMW		RMW	
00002.00		00002.00	1" = 20'-0"

DRAWING TITLE
Fire Department Access Site Plan

ALL WORK PROPOSED IN THE RIGHT-OF-WAY IS NOT DESIGNATED AS PUBLIC WORK

DRAWING NUMBER

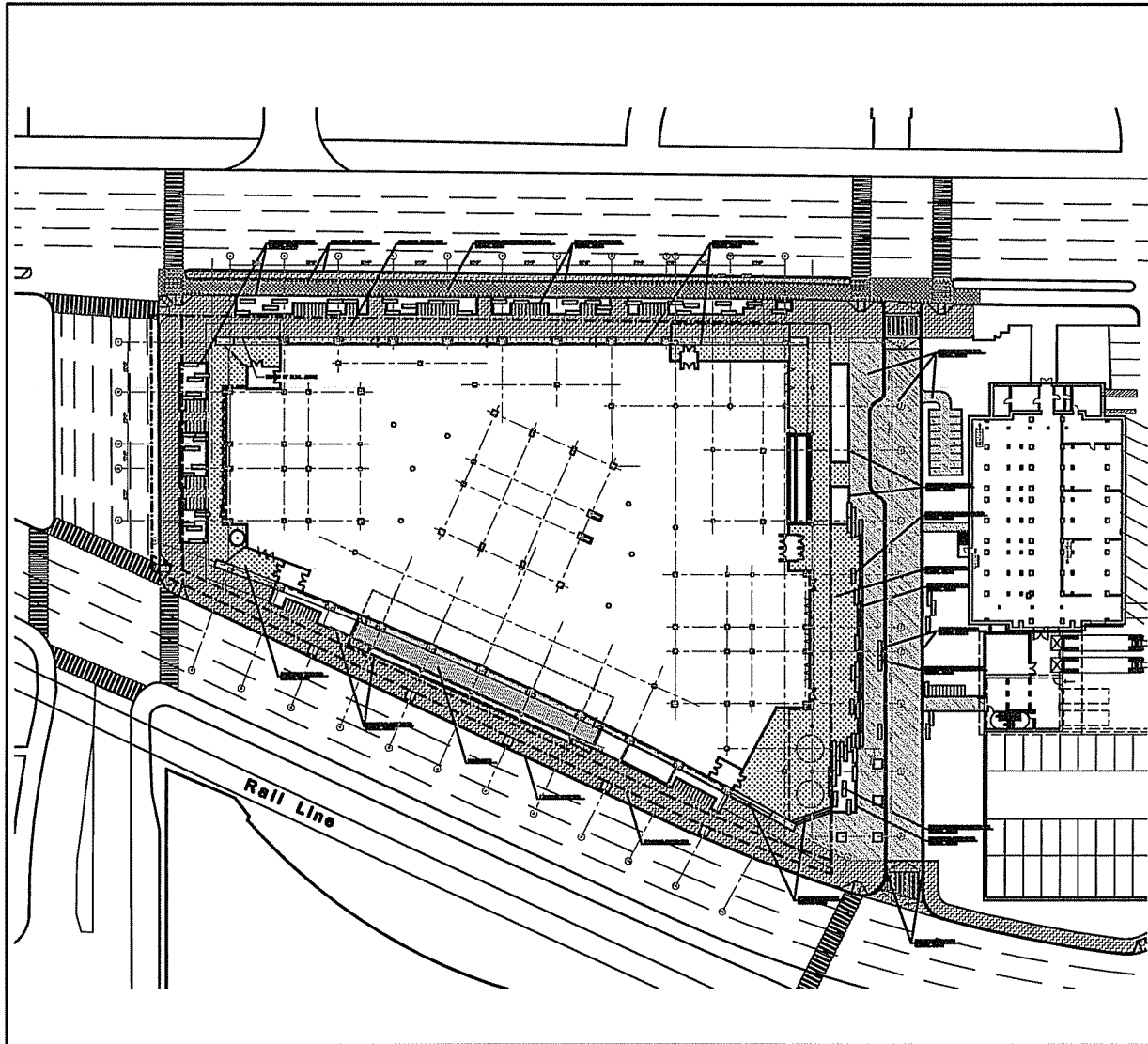

LEGEND

KEY	DESCRIPTION
[Symbol]	STONE BLOCK, MATERIAL VARIOUS
[Symbol]	GRANITE ROAD CURB
[Symbol]	ASPHALT PAVERS
[Symbol]	GRANITE PAVERS
[Symbol]	C.I.P. CONCRETE PAVING
[Symbol]	BENCH, WOOD WITH BR FRAME
[Symbol]	DECK, LOCAL CEDAR
[Symbol]	TYP. STAIRS, GRANITE
[Symbol]	TYP. C.I.P. CONCRETE CURB
[Symbol]	BITUMINOUS CONCRETE BIKE LANE
[Symbol]	BIKE PARKING, 101 TOTAL SPACES, STANDARD LINE PLACK
[Symbol]	MOPED PARKING, 18 TOTAL SPACES

ALL MATERIALS TO BE USED SHALL BE APPROVED BY THE ARCHITECT. ALL WORK SHALL BE DONE IN ACCORDANCE WITH THE SPECIFICATIONS AND THE CODES OF PRACTICE, SET BY THE BOARD OF SUPERVISORS.

L101
 RAIL
 Day Plan
 DISCOVERY
 Ballinger
 UHLEN WILSON
 MATERIALS PLAN
L101

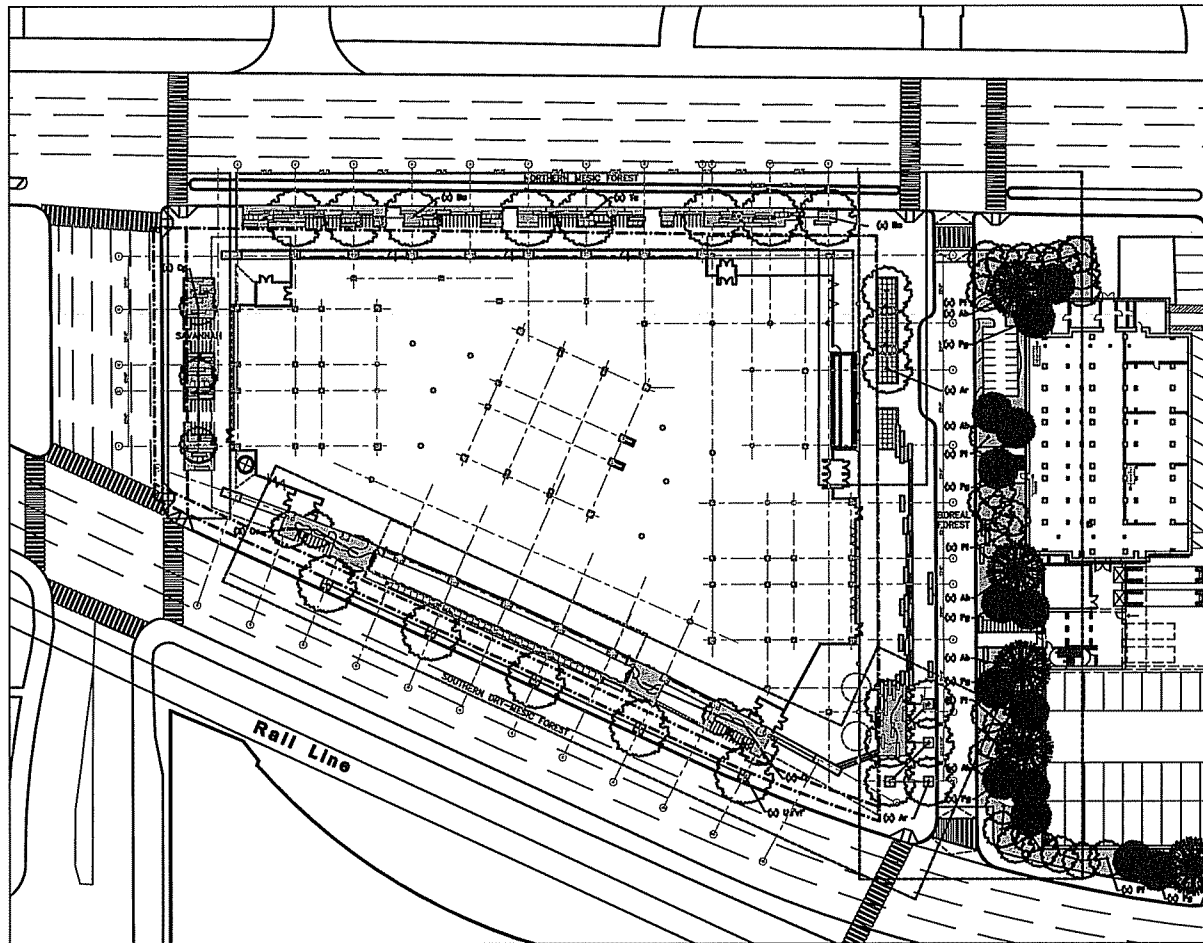

L201

BY PLAN

DISCOVERY
 Growth. Inhabits. Energy.
 The Mighty. Inhabits. Growth.

Bellinger
 Architecture & Interiors

**UHLER
 WILSON**
 ARCHITECTS

**PLANTING PLAN
 OVERALL
 THREE**

ALL RIGHTS RESERVED BY THE DESIGNER. NO PART OF THIS DOCUMENT IS TO BE REPRODUCED OR TRANSMITTED IN ANY FORM OR BY ANY MEANS, ELECTRONIC OR MECHANICAL, INCLUDING PHOTOCOPYING, RECORDING, OR BY ANY INFORMATION STORAGE AND RETRIEVAL SYSTEM.

L201

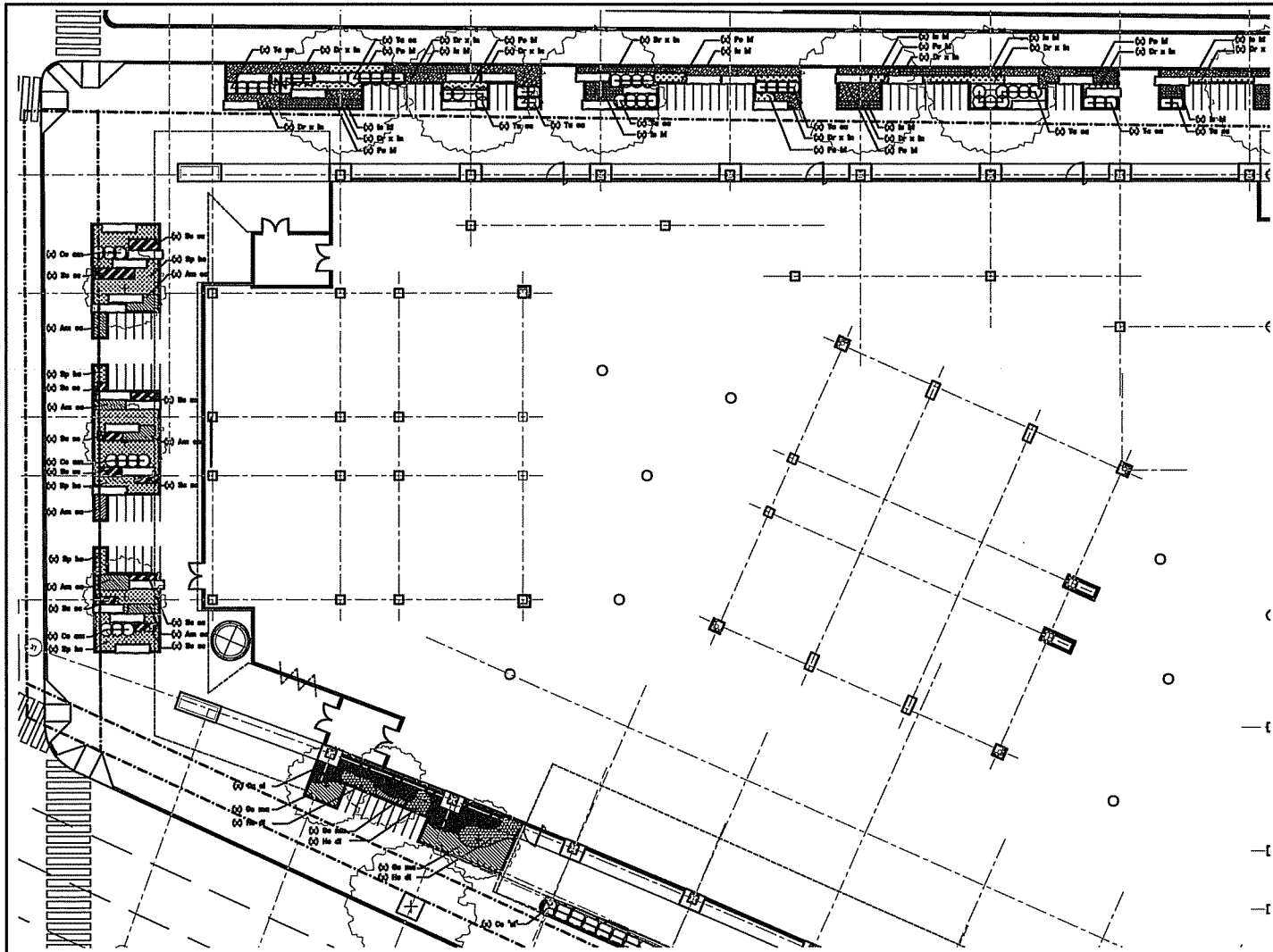

L202

SEAL

Site Plan

DISCOVERY
 DISCOVERY INSTITUTIONS AND
 DISCOVERY
 10000 Wilshire Boulevard
 Beverly Hills, California 90210

Ballinger
 ARCHITECTS
 1000 Wilshire Blvd
 Suite 3000
 Beverly Hills, CA 90210

**UHLERIN
 WILSON
 ARCHITECTS**
 100 Wilshire Blvd
 Suite 2000
 Beverly Hills, CA 90210

GREENLAND
 100 Wilshire Blvd
 Suite 2000
 Beverly Hills, CA 90210

**PLANTING PLAN
 ORLANDO
 UNIVERSITY**

L202

ALL INFORMATION CONTAINED HEREIN IS UNCLASSIFIED EXCEPT WHERE SHOWN OTHERWISE. DATE 03/05/2009 BY 60322 UCBAW/BJS/STP

SPACING FT.	ROW FT.	NO. OF PLANTS	AREA UNIT
2"	3.6"	18.4	1 SQ. FT.
4"	3.6"	10.4	
6"	5.5"	4.81	
6"	7.8"	2.29	
12"	10.4"	1.19	
18"	13.0"	7.39	10 SQ. FT.
18"	18.6"	5.12	
36"	30.8"	3.9	
36"	38.0"	1.85	
36"	30.0"	1.38	

1 Plant Spacing for Perennials, Ferns, Annuals, Bulbs
Note: See Planting Form for Complete Plant List

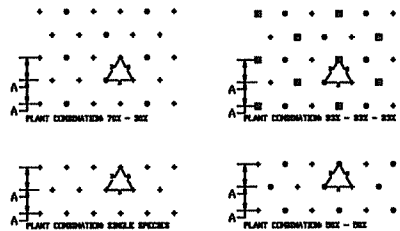

2 Plant Spacing Diagram for Perennials, Ferns, Annuals, Bulbs
Note: See Planting Form for Complete Plant List

SAVANNAH

RECOMMENDATION	QTY.	SY	RECOMMENDATION	QTY.	SY	RECOMMENDATION	QTY.	SY	RECOMMENDATION
0	0	0	0	0	0	0	0	0	0
0	0	0	0	0	0	0	0	0	0
0	0	0	0	0	0	0	0	0	0
0	0	0	0	0	0	0	0	0	0

SOUTHERN DRY-MESIC FOREST

RECOMMENDATION	QTY.	SY	RECOMMENDATION	QTY.	SY	RECOMMENDATION	QTY.	SY	RECOMMENDATION
0	0	0	0	0	0	0	0	0	0
0	0	0	0	0	0	0	0	0	0
0	0	0	0	0	0	0	0	0	0
0	0	0	0	0	0	0	0	0	0
0	0	0	0	0	0	0	0	0	0

NORTHERN MESIC FOREST

RECOMMENDATION	QTY.	SY	RECOMMENDATION	QTY.	SY	RECOMMENDATION	QTY.	SY	RECOMMENDATION
0	0	0	0	0	0	0	0	0	0
0	0	0	0	0	0	0	0	0	0
0	0	0	0	0	0	0	0	0	0
0	0	0	0	0	0	0	0	0	0
0	0	0	0	0	0	0	0	0	0

BOREAL FOREST

RECOMMENDATION	QTY.	SY	RECOMMENDATION	QTY.	SY	RECOMMENDATION	QTY.	SY	RECOMMENDATION
0	0	0	0	0	0	0	0	0	0
0	0	0	0	0	0	0	0	0	0
0	0	0	0	0	0	0	0	0	0
0	0	0	0	0	0	0	0	0	0
0	0	0	0	0	0	0	0	0	0

L205

SEA

By Plan

DISCOVERY
 WOODS BUILDING COMPANY
 THE HIGHTOP BUILDING COMPANY

Bellinger
 ARCHITECTS

WILHELM WILSON
 ARCHITECTS

CONSTRUCTION

LANDSCAPE

PLANTING SCHEDULE

L205

ALL RECOMMENDATIONS ARE BASED ON THE ASSUMPTION THAT THE PLANTS ARE BEING PLANTED IN A FULL SUN TO PART SHADY LOCATION. ALL RECOMMENDATIONS ARE BASED ON THE ASSUMPTION THAT THE PLANTS ARE BEING PLANTED IN A FULL SUN TO PART SHADY LOCATION.

