

TENANT :

The Cube Farm, LLC
58 Waubesa Street
Madison, WI 53704
Attn: Kevin Spaulding

LOWER LEVEL INFILL AT
1444 EAST WASHINGTON AVE.
MADISON, WISCONSIN 53703

GREEN DESIGN STUDIO
EDWARD KUHARSKI, ARCHITECT
405 SIDNEY STREET | MADISON, WI 53703 | 608.469.5963
EKUHARSKI@AOL.COM | REGISTERED ARCHITECT • WI #5587

DATE
09-10-14 - Draft Plan
10-31-14 - 2nd Draft
01-22-15 - 3rd Draft
05-12-15 - Cond. Use Submittal

SHEET NO.

A1

EXISTING
BASEMENT

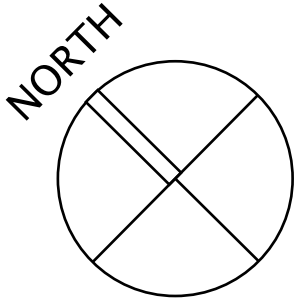

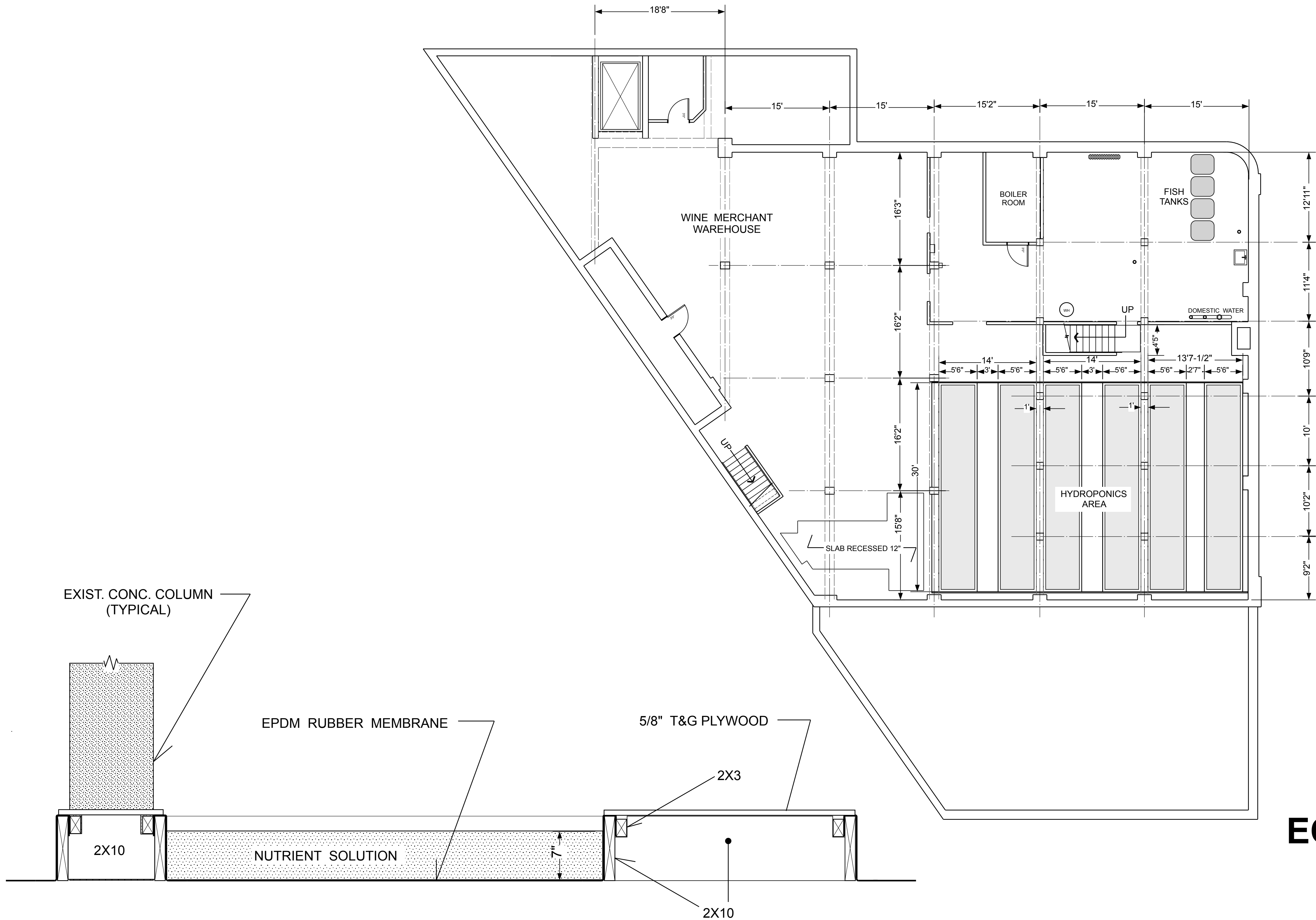

TENANT :

The Cube Farm, LLC
58 Waubesa Street
Madison, WI 53704
Attn: Kevin Spaulding

GREEN DESIGN STUDIO
EDWARD KUHARSKI, ARCHITECT
405 SIDNEY STREET | MADISON, WI 53703 | 608.469.5963
EKUHARSKI@AOL.COM | REGISTERED ARCHITECT • WI #5587

LOWER LEVEL INFILL AT
1444 EAST WASHINGTON AVE.
MADISON, WISCONSIN 53703

DATE
09-10-14 - Draft Plan
10-31-14 - 2nd Draft
01-22-15 - 3rd Draft
05-12-15 - Cond. Use Submittal

SHEET NO.

A2

EQUIPMENT PLAN

BASEMENT

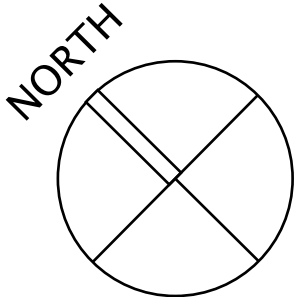

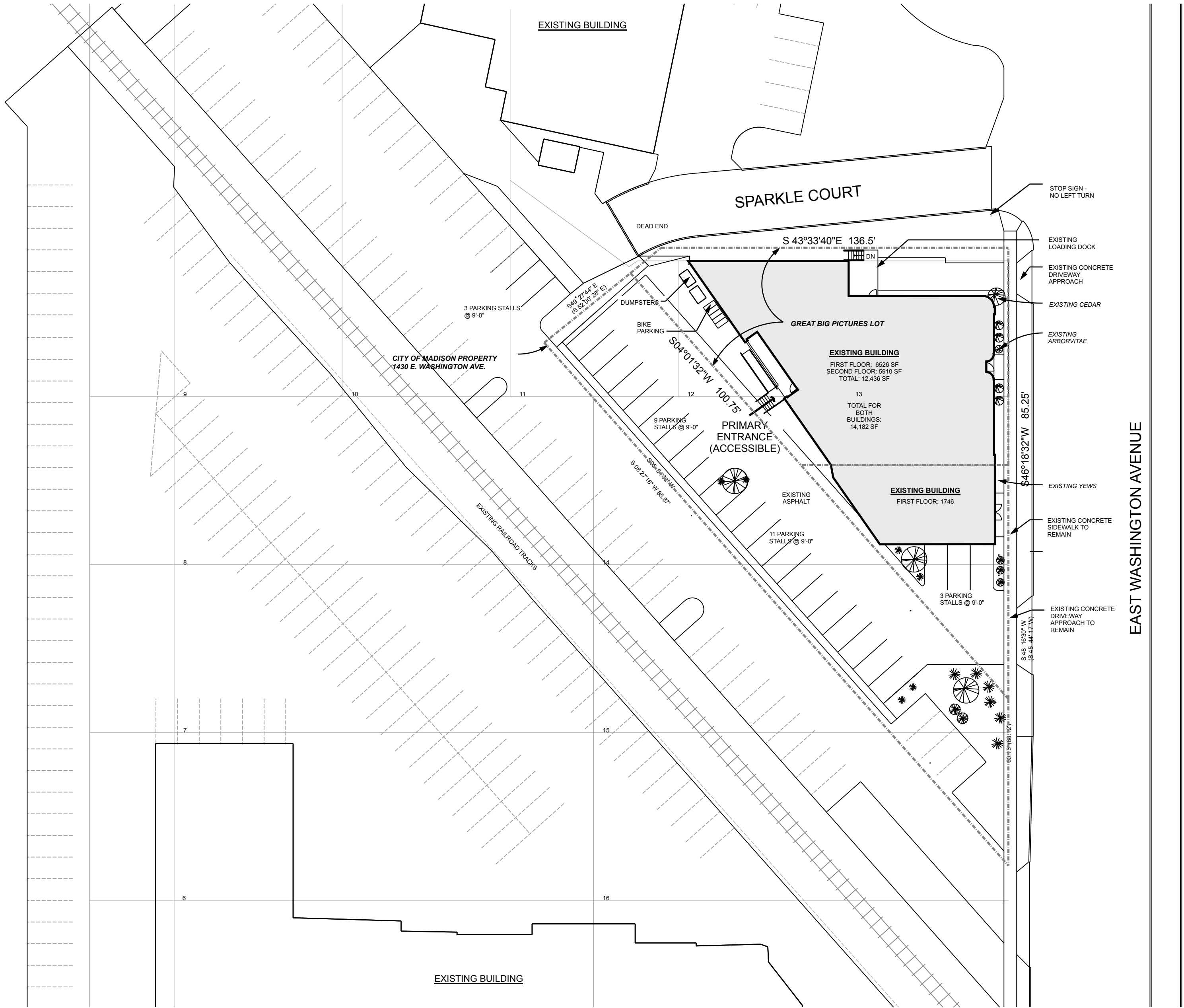

PROJECT NARRATIVE :

PROJECT CONSISTS OF VARIOUS TENANT IMPROVEMENTS TO EXISTING LOWER LEVEL SPACE TO SUPPORT AN AQUACULTURE OPERATION. THERE ARE TWO MAJOR PARTS TO THE SYSTEM: 1.) WATER TANKS FOR RAISINGFISH (TILAPIA) AND 2.) SHALLOW WATER-FILLED TRAYS (RAFTS) FOR GROWING VARIOUS MARKETABLE EDIBLE PLANTS.

TENANT:

The Cube Farm, LLC
58 Waubesa Street
Madison, WI 53704
Attn: Kevin Spaulding

OWNER:

CHANDLER PROPERTIES LLC
5701 MANUFACTURERS DR
MADISON, WI 53704-6277

COMBINED 1444 E. WASHINGTON AVE. PROPERTY & PORTION OF CITY OF MADISON PROPERTY. NO CROSS ACCESS WITH REMAINING PORTION OF CITY OF MADISON PROPERTY (PROPOSED MULLINS LEASE)

PROPERTY ADDRESS: 1444 E. WASHINGTON AVE.
PARCEL NUMBER: 071007210033

ORIGINAL PLAT, AKA FARWELLS REPLAT, BLK 223, THAT PRT OF LOTS 11, 12, 13, & 14 DESC AS FOLLOWS:

COMMENCING AT A PT ON NW LN OF E WASHINGTON AVE 180.3 FT SW FROM INTS OF SW LN OF N THORNTON AVE WITH NW LN OF E WASHINGTON AVE, THEN AT RT ANG TO E WASHINGTON AVE TO ELY LN OF RW OF C M ST P & P RR CO, TH N 4 DEG 44 MIN E ALG SD R/W TO PT WHICH IS 146.3 FT FROM NW LN OF E WASHINGTON AVE, TH S 43 DEG 42 MIN E 146.3 FT TO NW LN OF E WASHINGTON AVE, TH S 46 DEG 18 MIN W ALG SD NWLY LN OF E WASHINGTON AVE 80.3 FT TO POB.

EXCEPT THAT PART FOR STREET ROW IN DOCUMENT #4073509 & 4233945.

EXISTING SITE PLAN



LOWER LEVEL TENANT IMPROVEMENTS AT:
1444 EAST WASHINGTON AVE.
MADISON, WISCONSIN 53703

GREEN DESIGN STUDIO
EDWARD KUHARSKI, ARCHITECT
405 SIDNEY STREET | MADISON, WI 53703 | 608.469.5963
EKUHARSKI@AOL.COM | REGISTERED ARCHITECT • WI #5587

DATE
09-10-14 - Draft Plan
01-22-15 - 2nd Draft
05-12-15 - Cond. Use Submittal

SHEET NO.

S1