

North

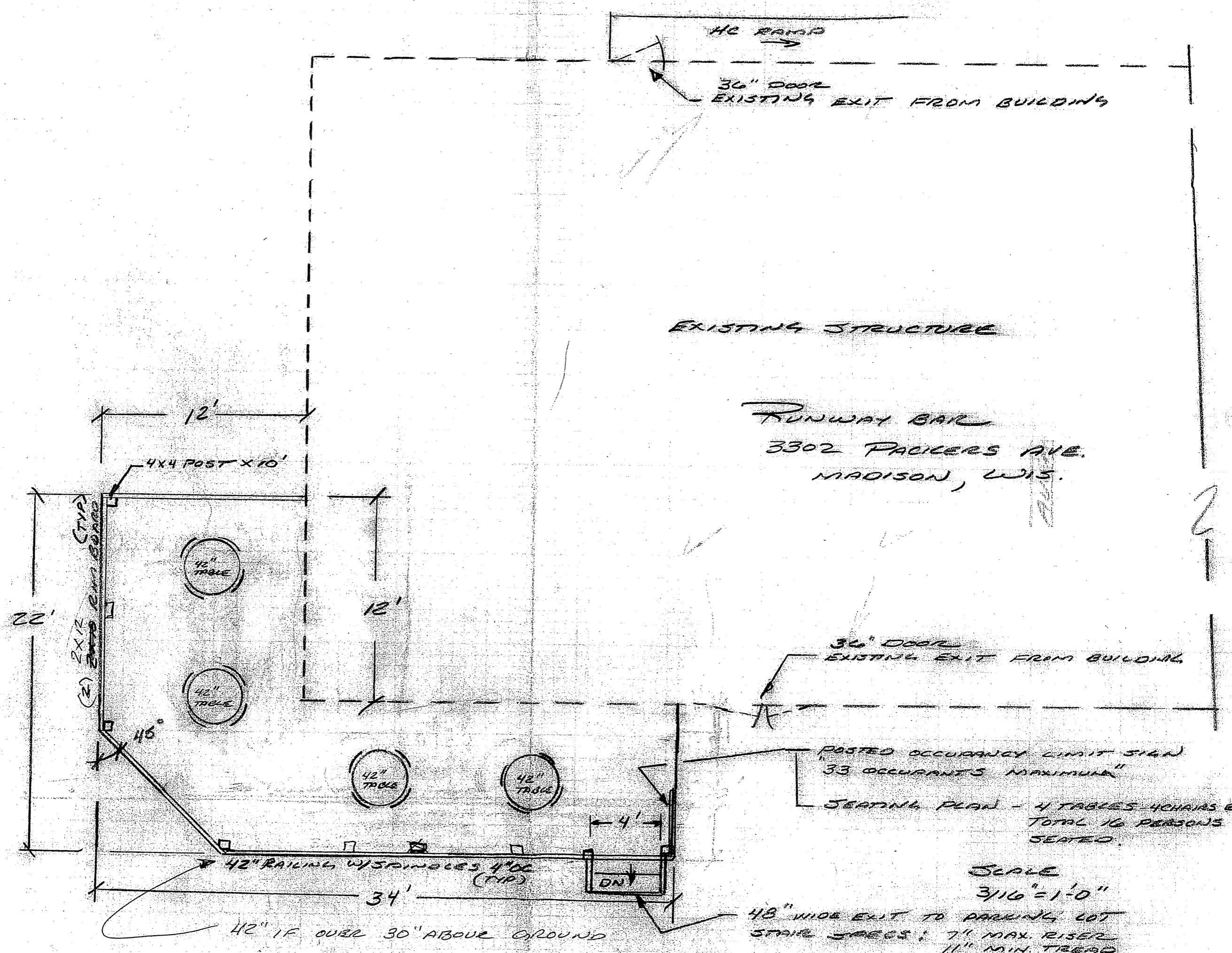

EXISTING STRUCTURE

RUNWAY BAR
3302 PACIFERS AVE.
MADISON, WIS.

36" DOOR
EXISTING EXIT FROM BUILDING

POSTED OCCUPANCY LIMIT SIGN
"33 OCCUPANTS MAXIMUM"

SEATING PLAN - 4 TABLES 4 CHAIRS EA.
TOTAL 16 PERSONS
SEATED

SCALE
3/16" = 1'-0"

48" WIDE EXIT TO PARKING LOT
STAIR SIZES: 7" MAX RISER
11" MIN TREAD

42" IF OVER 30" ABOVE GROUND

PACIFERS AVENUE

2

North

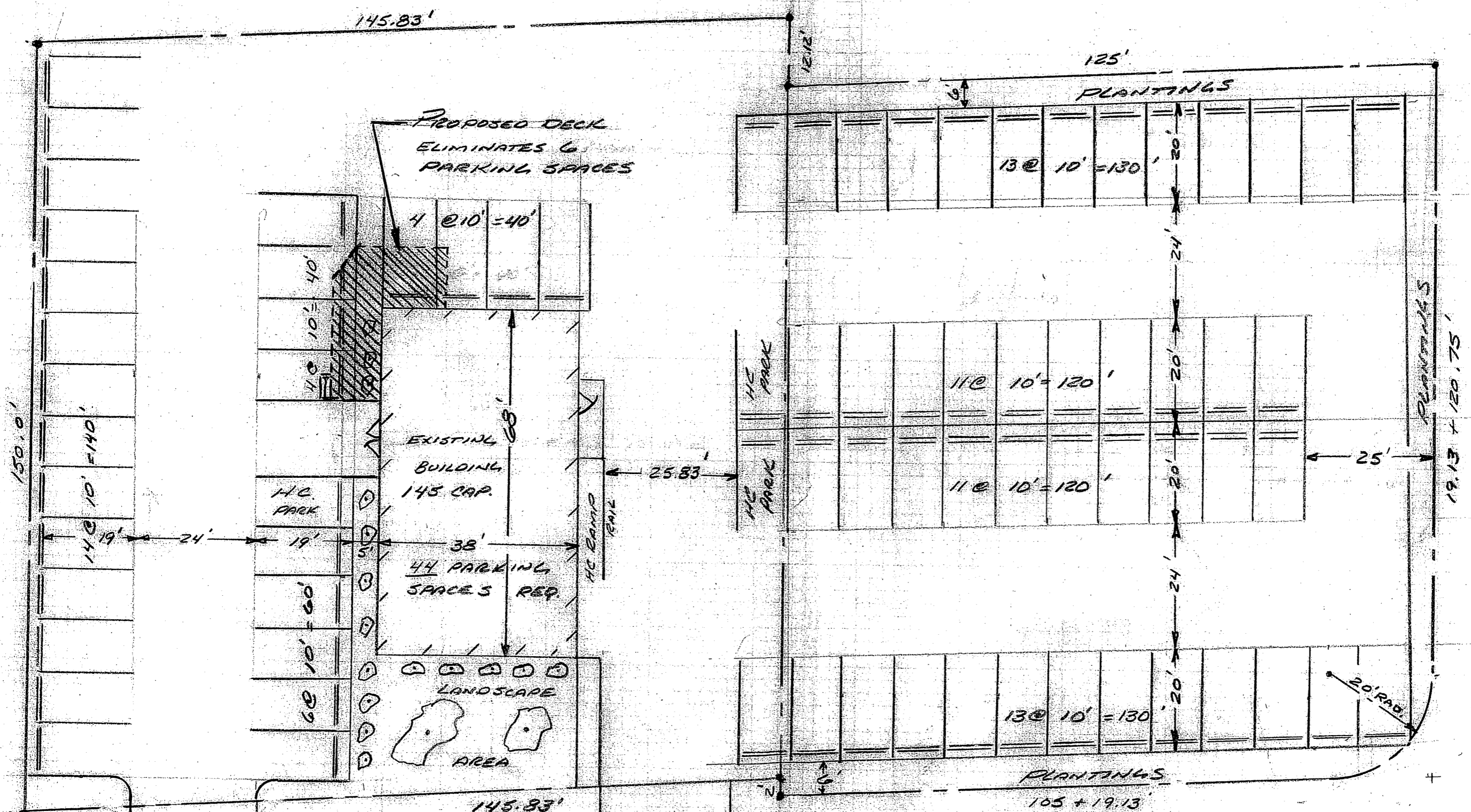

76 - PARKING SPACES
 - 6 - PROPOSED DECK AREA / RUNWAY BAR
 = 70 PARKING SPACES

PARKING LOT / LANDSCAPE PLAN
 3302 PACKERS AVENUE
 MADISON, WIS.

PROPERTY OWNER
 DENNIS JAX
 MONONA, WIS.

SCALE: 1" = 20'