

H:\C300\311\12041-01\PRELIMINARY\CIVIL-EROSION CONTROL PLANS-ELDERBERRY-22X34.DWG

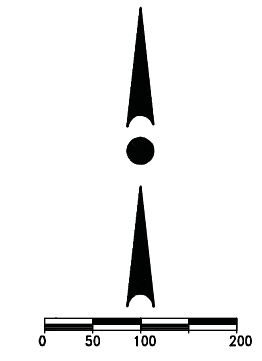

- EROSION CONTROL NOTES:**
- THE CONTRACTOR SHALL TAKE ALL MEASURES NECESSARY TO MINIMIZE EROSION, WATER POLLUTION AND SILTATION CAUSED BY CONSTRUCTION OF THIS PROJECT. EROSION CONTROL MEASURES SHALL BE IN ACCORDANCE WITH WISCONSIN DEPARTMENT OF NATURAL RESOURCES TECHNICAL STANDARDS.
  - EROSION CONTROL PLAN: PRIOR TO BEGINNING WORK, THE CONTRACTOR MAY BE REQUIRED TO SUBMIT AN EROSION AND SEDIMENT CONTROL PLAN, DETAILING SPECIFIC MEASURES THAT WILL BE USED IN THE VARIOUS STAGES OF CONSTRUCTION FOR APPROVAL BY THE ENGINEER.
  - IMPLEMENTATION: THE CONTRACTOR SHALL NOT BEGIN WORK UNTIL AFTER INITIAL EROSION AND SEDIMENT CONTROL DEVICES ARE IN PLACE AND APPROVED BY THE ENGINEER.
  - EROSION CONTROL MEASURES SHALL INCLUDE, BUT NOT BE LIMITED TO THE FOLLOWING:
    - DIVERT UPSTREAM RUNOFF FROM FLOWING THROUGH THE CONSTRUCTION SITE.
    - PROTECT DOWNSTREAM OR ADJACENT DRAINAGEWAYS WITH SILT FENCE AND/OR STONE DITCH CHECKS.
    - DELAY STRIPPING TOPSOIL UNTIL REQUIRED FOR CONSTRUCTION.
    - PLACE SILT FENCE OR EROSION CONTROL BALES IN DITCHES AND OTHER DRAINAGE WAYS TO COLLECT SEDIMENT AND TO SLOW THE VELOCITY OF RUNOFF.
    - MAINTAIN SEDIMENT BASIN AS DICTATED BY SITE CONDITIONS.
    - PROTECT STORM SEWER INLETS AND THE UPSTREAM END OF CULVERTS WITH SILT FENCE OR EROSION CONTROL BALES.
    - PROMPT REMOVAL OF EXCAVATED MATERIAL.
    - PROPER STORAGE OF BACKFILL AND BEDDING MATERIALS INCLUDING PLACING SILT FENCE OR EROSION CONTROL BALES ON THE DOWNSLOPE SIDES OF SPOIL PILES.
    - CONSTRUCTION OF TRACKING PAD TO CONSTRUCTION SITE TO PREVENT SEDIMENT FROM BEING TRACKED ONTO ROADWAYS.
    - PROMPT (SAME DAY) CLEANUP OF MATERIAL TRACKED ONTO ADJACENT STREETS.
    - TIMELY RESTORATION OF DAMAGE SURFACE AREAS.
    - ALL AREAS THAT WILL REMAIN DISTURBED AFTER OCTOBER 15, MUST BE TEMPORARY SEEDING AS OF THAT DATE.
  - TEMPORARY EROSION CONTROL MEASURES.
    - THE CONTRACTOR SHALL CONSTRUCT TEMPORARY EROSION CONTROL MEASURES, WHERE EROSION IS LIKELY TO BE A PROBLEM, PRIOR TO BEGINNING WORK ON THOSE SECTION(S) OF THE PROJECT. TEMPORARY EROSION CONTROL MEASURES SHALL BE MAINTAINED UNTIL AFTER PERMANENT EROSION CONTROL, SUCH AS SEEDING OR SODDING, HAS BEEN ESTABLISHED.
    - IN THE EVENT THE PERMANENT EROSION CONTROL MEASURES ARE NOT FULLY IMPLEMENTED IN CURRENT CONSTRUCTION SEASON, THE CONTRACTOR SHALL BE RESPONSIBLE FOR MAINTAINING ALL NECESSARY TEMPORARY EROSION CONTROL MEASURES UNTIL AFTER PERMANENT MEASURES HAVE BEEN COMPLETED IN THE FOLLOWING YEAR.
  - ALL DISTURBANCE AREAS THAT REMAIN INACTIVE FOR SEVEN DAYS OR LONGER SHALL RECEIVE TEMPORARY SEEDING.
  - TRENCH DEWATERING SHALL BE IN ACCORDANCE WITH WDNR TECHNICAL STANDARDS.
  - INSTALL SILT FENCE IN ACCORDANCE WITH WDNR TECHNICAL STANDARD DETAILS
  - ALL RIP RAP AT PIPE OUTLETS SHALL BE 3"x5" MEDIUM RIP RAP OVER TYPE R FABRIC PER WDOT SPECIFICATIONS UNLESS OTHERWISE DESIGNATED.
  - EROSION CONTROL INSPECTION AND MAINTENANCE
    - INSPECT EROSION CONTROL MEASURES WEEKLY AND AFTER SITE RECEIVES 0.5" OF RAIN IN A 24-HOUR PERIOD DURING CONSTRUCTION.
    - REPAIR OR REPLACE EROSION CONTROLS THAT ARE DAMAGED OR FAILING.
  - ALL AREAS TO BE SEEDING AND MULCHED SHALL USE WDOT SEED MIXTURE NO. 20. MULCH SHALL APPLIED PER WDOT SPECIFICATIONS USING METHOD B FOR PLACEMENT.

- WISCONSIN DEPARTMENT OF NATURAL RESOURCES, CONSERVATION PRACTICE STANDARD:**
- 1052 - NON-CHANNEL EROSION MAT
  - 1055 - SEDIMENT BALE BARRIER (NON-CHANNEL)
  - 1056 - SILT FENCE
  - 1060 - STORM DRAIN INLET PROTECTION FOR CONSTRUCTION SITES
  - 1062 - DITCH CHECK
  - 1057 - STONE TRACKING PAD AND TIRE WASHING
  - 1058 - MULCHING FOR CONSTRUCTION SITES
  - 1059 - TEMPORARY SEEDING
  - 1061 - DE-WATERING (NOT ANTICIPATED PER SOIL BORINGS)
  - 1064 - SEDIMENT BASIN

CONTRACTOR IS REQUIRED TO CONTACT DIGGERS HOTLINE TOLL FREE TO OBTAIN LOCATION OF UNDERGROUND UTILITIES PRIOR TO COMMENCING THE WORK. WISCONSIN STATUTE 182.0715 REQUIRES MIN. OF 3 WORK DAYS NOTICE BEFORE YOU EXCAVATE  
**CALL DIGGERS HOTLINE 1-800-242-8511**

**NOTE:** EXISTING UNDERGROUND UTILITY INFORMATION WAS OBTAINED FROM AVAILABLE RECORDS. THE ENGINEER MAKES NO GUARANTEE AS TO THE ACCURACY OF THIS INFORMATION. VERIFICATION TO THE SATISFACTION OF THE CONTRACTOR OF ALL UNDERGROUND UTILITIES, WHETHER OR NOT SHOWN ON THE PLANS, SHALL BE ASSUMED AS A CONDITION OF THE CONTRACT. THE CONTRACTOR SHALL NOTIFY THE ENGINEER OF ANY DISCREPANCIES BETWEEN LOCATION OF UTILITIES IN THE FIELD AND LOCATIONS SHOWN ON THE PLANS.

WISCONSIN  
JOSHUA D. PUDELKO  
E-39420  
WAUWATOSA, WI  
PROFESSIONAL ENGINEER

---

DESIGN • LAND SURVEYING  
**TRIO**  
CIVIL ENGINEERING

17700 W. CAPITOL DRIVE  
BROOKFIELD, WI 53045  
PHONE: (262) 790-1480  
FAX: (262) 790-1481  
EMAIL: jpuedelko@trioeng.com

**PROJECT:**  
**HIGHLANDS COMMUNITY**  
ELDERBERRY NEIGHBORHOOD  
CITY OF MADISON, WI

**BY:** United Financial Group, Inc.  
660 W. Ridgeway Drive  
Appleton, WI 54911

REVISION HISTORY	
DATE	DESCRIPTION

**DATE:**  
MARCH 6, 2013

**JOB NUMBER:**  
12041

**DESCRIPTION:**  
**OVERALL  
EROSION  
CONTROL PLAN**  
**SHEET**

C4.0

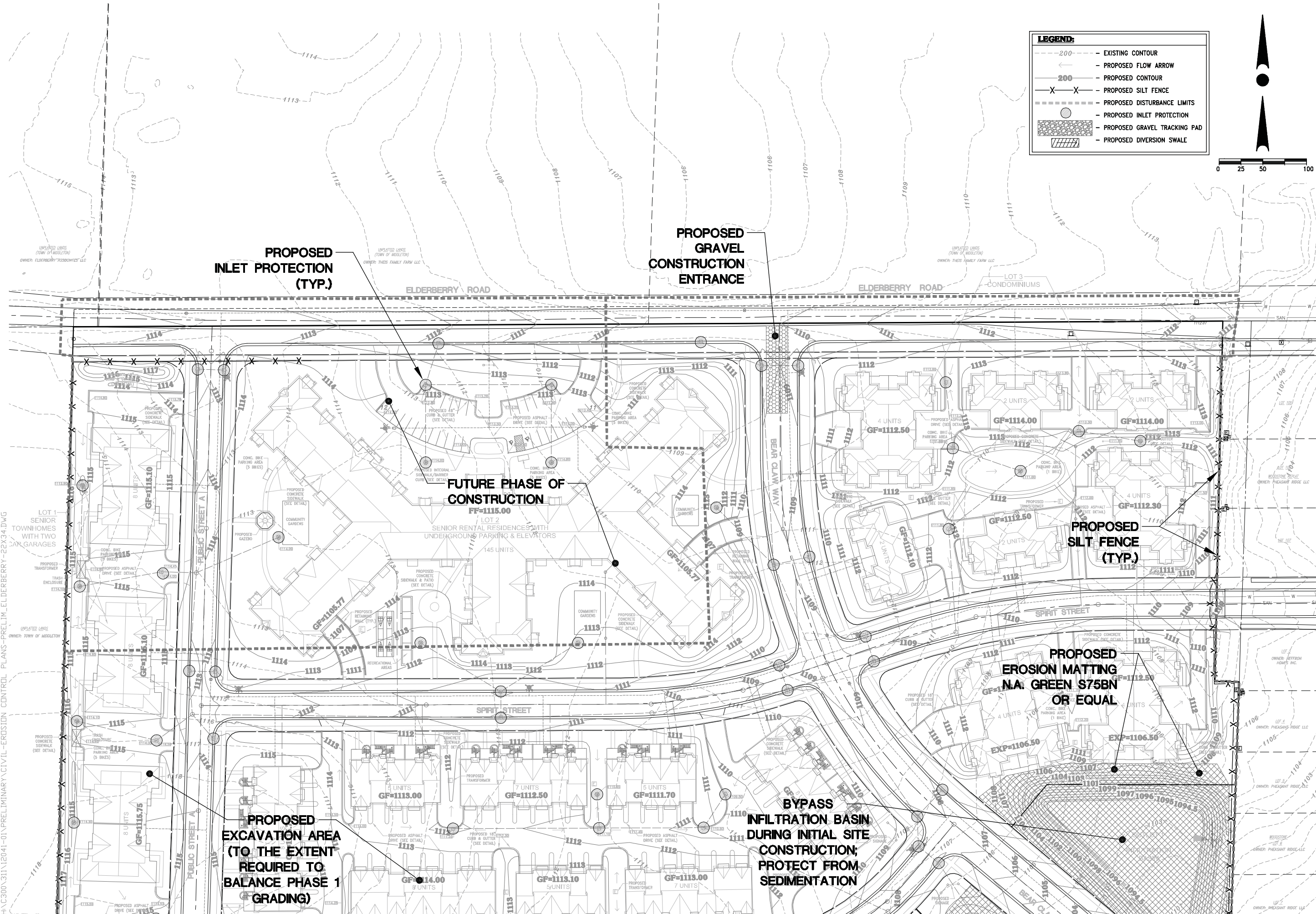

17700 W. CAPITOL DRIVE  
BROOKFIELD, WI 53045  
PHONE: (262) 790-1480  
FAX: (262) 790-1481  
EMAIL: j.pudelko@trioeng.com

**PROJECT:**  
**HIGHLANDS COMMUNITY**  
ELDERBERRY NEIGHBORHOOD  
CITY OF MADISON, WI

**BY:** United Financial Group, Inc.  
660 W. Ridgeway Drive  
Appleton, WI 54911

REVISION HISTORY	
DATE	DESCRIPTION

**DATE:**  
MARCH 6, 2013

**JOB NUMBER:**  
12041

**DESCRIPTION:**  
EROSION CONTROL PLAN

**SHEET**

**C4.1**

H:\C300\311\12041-01\PRELIMINARY\CIVIL-EROSION CONTROL PLANS\PRELIM\_ELDERBERRY-22X34.DWG

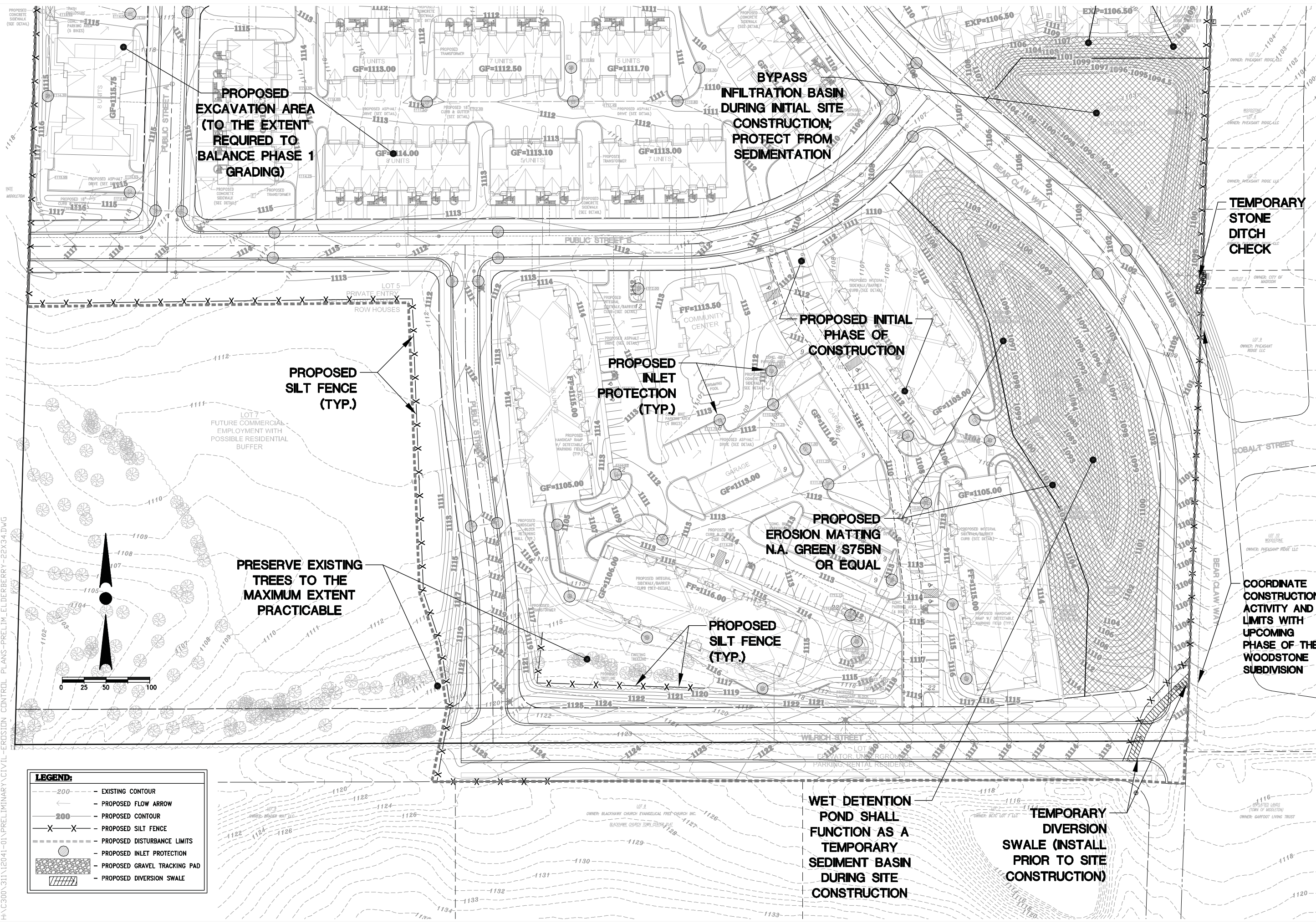

**PROPOSED EXCAVATION AREA (TO THE EXTENT REQUIRED TO BALANCE PHASE 1 GRADING)**

**BYPASS INFILTRATION BASIN DURING INITIAL SITE CONSTRUCTION; PROTECT FROM SEDIMENTATION**

**TEMPORARY STONE DITCH CHECK**

**PROPOSED SILT FENCE (TYP.)**

**PROPOSED INLET PROTECTION (TYP.)**

**PROPOSED INITIAL PHASE OF CONSTRUCTION**

**PROPOSED EROSION MATTING N.A. GREEN S75BN OR EQUAL**

**PRESERVE EXISTING TREES TO THE MAXIMUM EXTENT PRACTICABLE**

**PROPOSED SILT FENCE (TYP.)**

**COORDINATE CONSTRUCTION ACTIVITY AND LIMITS WITH UPCOMING PHASE OF THE WOODSTONE SUBDIVISION**

**WET DETENTION POND SHALL FUNCTION AS A TEMPORARY SEDIMENT BASIN DURING SITE CONSTRUCTION**

**TEMPORARY DIVERSION SWALE (INSTALL PRIOR TO SITE CONSTRUCTION)**

**LEGEND:**

- - - - - EXISTING CONTOUR
- - - - - PROPOSED FLOW ARROW
- 200** - - - - - PROPOSED CONTOUR
- X X - - - - - PROPOSED SILT FENCE
- - - - - PROPOSED DISTURBANCE LIMITS
- - - - - PROPOSED INLET PROTECTION
- [Hatched Box] - PROPOSED GRAVEL TRACKING PAD
- [Diagonal Lines Box] - PROPOSED DIVERSION SWALE



17700 W. CAPITOL DRIVE  
BROOKFIELD, WI 53045  
PHONE: (262) 790-1480  
FAX: (262) 790-1481  
EMAIL: jpuudelko@trioeng.com

**PROJECT:**  
**HIGHLANDS COMMUNITY**  
ELDERBERRY NEIGHBORHOOD  
CITY OF MADISON, WI

**BY:** United Financial Group, Inc.  
660 W. Ridgeway Drive  
Appleton, WI 54911

**REVISION HISTORY**

DATE	DESCRIPTION

**DATE:**  
MARCH 6, 2013

**JOB NUMBER:**  
12041

**DESCRIPTION:**  
EROSION CONTROL PLAN

**SHEET**

**C4.2**

H:\C300\311\12041-01\PRELIMINARY\CIVIL-EROSION CONTROL PLANS\PRELIM\_ELDERBERRY-22X34.DWG