

James Madison Park Master Plan and Shelter Design

Public Meeting #3 – Design Concepts Workshop Notes

6:00 – 7:30 PM, May 14, 2018

Gates of Heaven, 302 E. Gorham St.

Total participants: 44 signed in / 49 counted

Meeting Format

The meeting began with a presentation of the project background and three preliminary design concepts for the master plan and park shelter. Participants then worked in small groups to review each concept and identify areas of unanimous like/agreement, mixed-reception, and unanimous dislike/concern. Participants were not asked to choose one concept over the others, as the expectation is that the final master plan will include elements from each concept.

Presentation Q&A Notes

Design Concept A:

- The vendor in the lower level of the proposed shelter would likely be paddle sport rentals.

Design Concept B:

- The proposed shelter would be a four-season building.
- Basketball courts could potentially be used for temporary parking during events.
- If the new shelter is constructed with Option B, the existing towers and roof gardens would be demolished. The new building would then include a green roof with space for new gardens.
- This option shows a grassy area for amphitheater seating in the current shelter location.
- It would also be possible to have an ice skating rink in the current shelter location in this option.
- There will be fully accessible restrooms in the shelter.

Design Concept C:

- Changes to the shoreline allow for variety of water sport options and cleaner water.
- The shared dockage should accommodate boats docking as well as launching, but there will likely be further tweaks to the set up as the design team completes research on the leasing of boats, necessary lengths of slips, etc.

General Comments and Questions:

- Final plans for including waste water filtration will be decided with the final conceptual design.
- Community gardens are not included in the current design concepts. The team's reasoning is that James Madison Park is a community park with many users, and the ratio of required square footage to number of users for community gardens is not as efficient/flexible as other uses.
- A sand beach is something that the design team is vetting with the DNR. It is unsure whether they will allow for direct entry into the lake due to a laundry list of variables. A sand beach may have to be located above the high-water mark. The design team is aware that Dane County recently had a sand beach approved, and is working with the DNR to see what may be possible in this location.
- The final preferred plan will likely not be one of the concepts presented here in full; it will take the most favored aspects of each concept, balanced with budget and additional regulatory agency input, and then integrated into a final plan that will go through the city approval process.

- Public comments and additional feedback may be sent to Alder Zellers or the Parks Division project contact, Sarah Lerner. All public input collected throughout this planning process will influence the final design and be shared with relevant agencies.

Small Group Report-Out

After working together in small groups (6 total), each group reported its top results to the rest of the participants. Major takeaways reported by each small group to the larger group are shared below.

Each ★ = the additional number of small groups that made the same comment during the report-out.

Features liked by all members of the group (green dots):

- Park shelter in current location, with food/café option (Design Concept A and C) as is (better than central location) ★★★★★
- Natural stormwater filtration exhibit (Concept A) ★★★★★
- Parking relocated to Gorham ★★★
- Park shelter with commercial space/paddle rental vendor ★
- Large open spaces ★
- Relocation of Gates of Heaven to east side of the park (Concept C) ★
- A designated swimming area
- Filtered swimming area (Concept C)
- Basketball and volleyball courts located in close proximity to each other
- Playground and basketball in west side of the park (Concept C)
- Sunset/lake over look by the bed and breakfast (Concepts B and C)
- Retain the park shelter silos

Features liked by some members of the group/unsure/need more info (yellow dots):

- Issues with the energy usage and maintenance required by a swimming area filtration system, but want to see some kind of protected swimming area
- Likes idea of cleaner swimming area, but not if it takes away too much park space
- Concerns about expanding the shelter around the boathouse – need to retain access to repair bay (Concepts A and C)
- Interest in having bathrooms on west end of the park
- Interest in having bathrooms on west end of the park, closer to rec activities, but unsure of central shelter location (Concept B)
- Unsure of best placement for basketball courts
- Interest in more plantings and shrubbery around the park
- Some enjoyed natural landscaping, others thought it took away usable space

Features disliked by all members of the group (red dots):

- Against relocation of Gates of Heaven (Design Concept C) ★
- Concerns about long term costs and maintenance of natural stormwater filtration (Concept A)
- Concerns about long term costs and maintenance of a filtered swimming area (Concept C)
- Prefer sand beaches that go into the water vs. a perched beach
- Concerns with shoreline changes that increase distance between boathouse & water (Concept C)
- Concerns about a lack of access for boating
- Group would like to see an option with courtesy docking at the east side of the park

Small Group Dot Voting Results and Written Notes

The following are combined dot votes and notes made by small groups on the printed plans.

Design Concept A

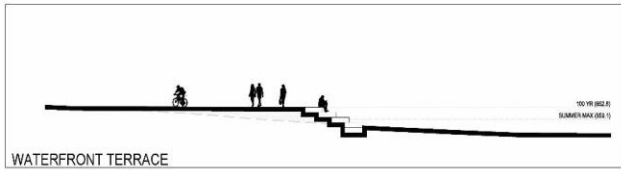
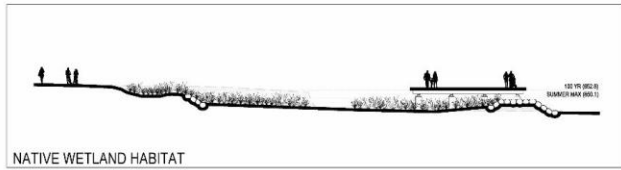
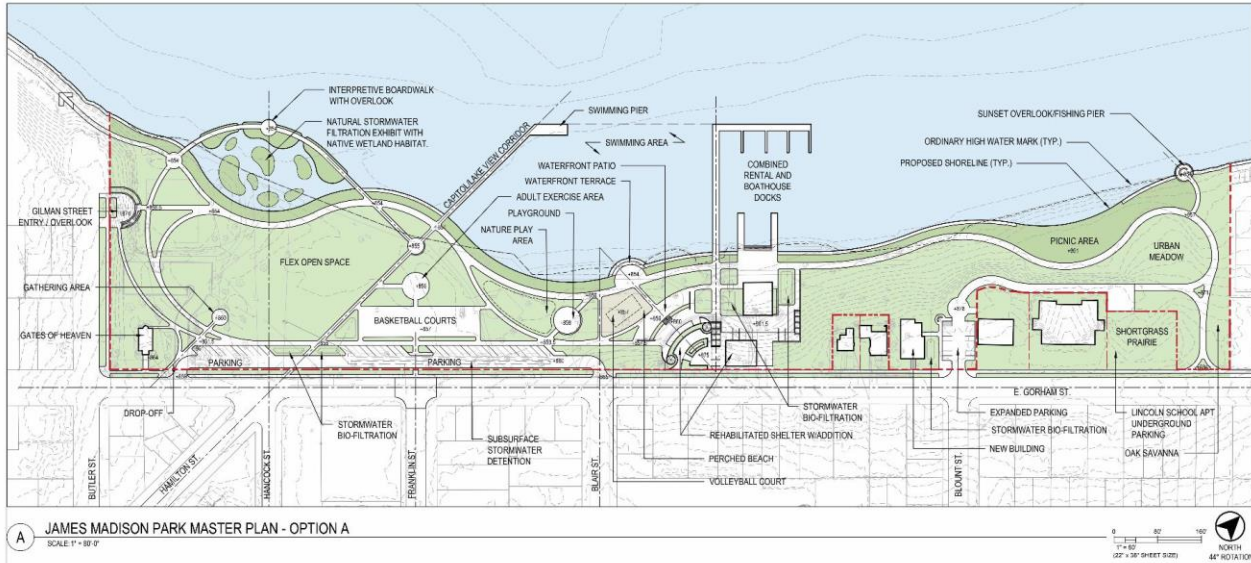

Design Feature	Green Dots	Yellow Dots	Red Dots
Connection to path behind Verex Plaza	1		
Natural stormwater filtration exhibit w/ native wetland habitat	6	1	
Gilman Street entry/overlook	2		
Gates of Heaven in current location	1	1	
Flex open space	2		
Parking	3		
Capitol lake view corridor swimming pier	3		1
Basketball courts	2	3	
Swimming area		1	
Combined rental and boathouse docks		1	1
Rehabilitated shelter addition	2		
Boathouse surroundings			1
New building on Gorham next to smaller lot	1		
<ul style="list-style-type: none"> • Don't like perched beach – prefer natural sand beach to water • Extra paths [between Gates of Heaven and Gilman Street entry] cut off green space? • No: boathouse function diminished – access to second floor for boat repair • Like: Gates of Heaven has appropriate context, outdoor gathering space ★ • ?: adult exercise area sounds dirty • Like: dock, possible dark sky area for observing stars 			

- Like: extra space for Frisbee and football
- Like: placeholder for historic building
- No: rowing boats have a hard time with current dock configuration

Design Concept B

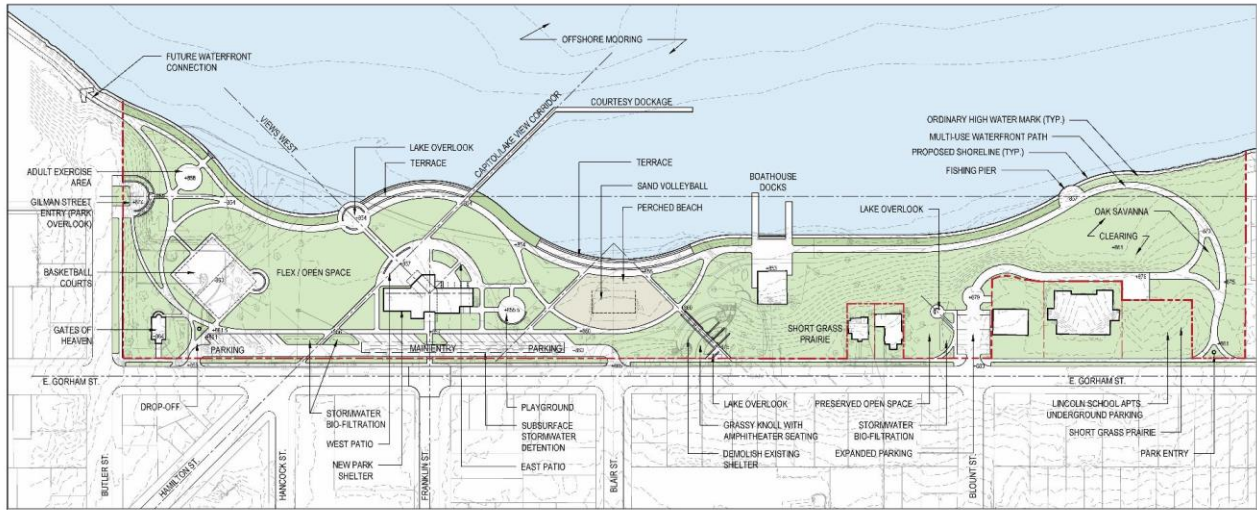

B JAMES MADISON PARK MASTER PLAN - OPTION B
 SCALE: 1" = 80'-0"
 0' 50' 100' 150'
 1" = 80' (SHEET SIZE)
 NORTH
 44° ROTATION

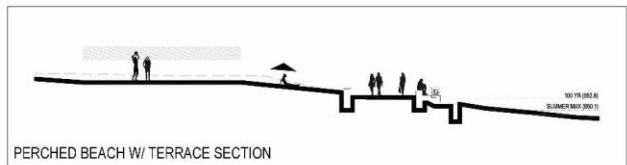
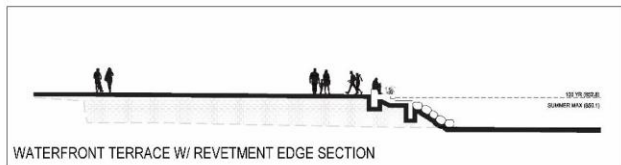

Design Feature	Green Dots	Yellow Dots	Red Dots
Gilman Street entry/overlook	1		
Gates of Heaven in current location	2		
Basketball courts	1		
Parking	4		
Capitol view corridor (pier w/ courtesy dockage)	2		
New park shelter		1	2
Sand volleyball	1		
Perched beach			1
Overlook/grassy knoll/amphitheater seating in current shelter location		1	1
Short grass prairie		1	
Preserved open space next to smaller lot		1	
Lake overlook	1		
Clearing [at east side of park]	1		
Fishing pier		1	1

- Perched beach seems awkward – prefer natural sand beach to water
- Do not like location of shelter
- No designated swimming area
- Main shelter location permits centralization of public activity away from rowing club

- Like location of Gates of Heaven
- Like central location of restrooms ★

Design Concept C

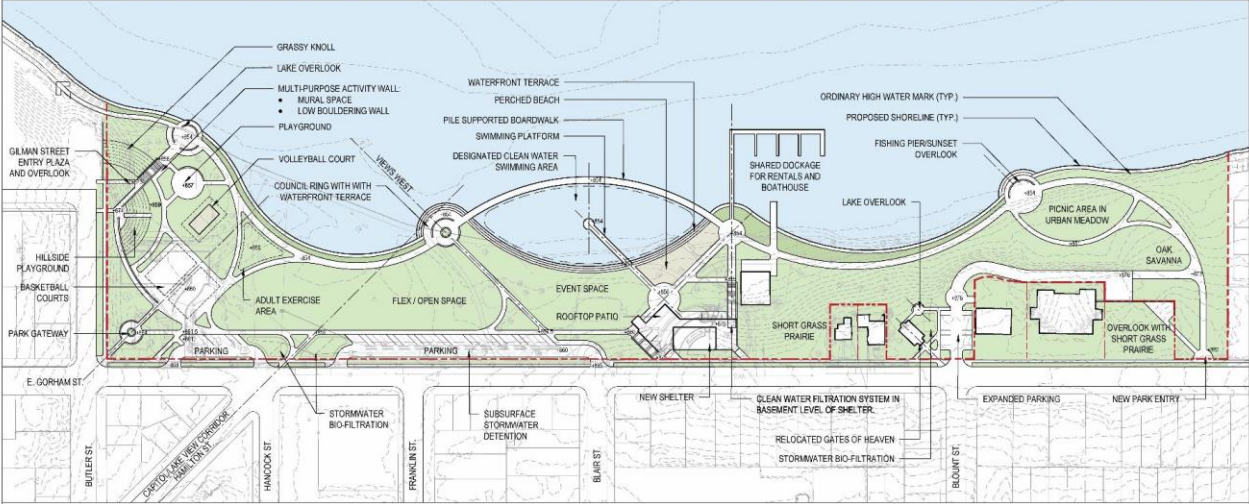

C JAMES MADISON PARK MASTER PLAN - OPTION C
SCALE: 1" = 80'
1" = 10' (22" x 36" SHEET SIZE) 44" ROTATION

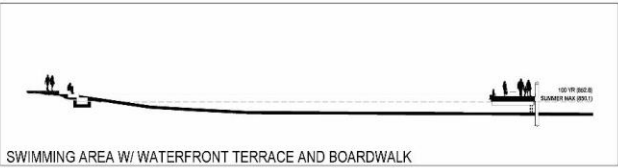
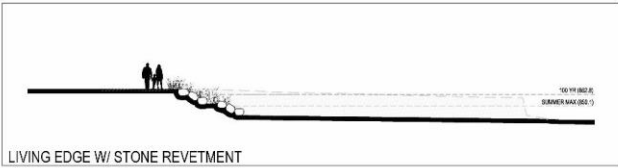

Design Feature	Green Dots	Yellow Dots	Red Dots
Gilman Street entry plaza and overlook	1		
Playground		1	
Volleyball court	1	1	
Basketball courts	1		
Cluster of recreation activities on east end		1	
Parking	6		
Designated clean water swimming area	1	3	
New shelter	2	1	
Rooftop patio	1		
Clean water filtration system in basement of shelter			1
Shared dockage for rentals and boathouse		2	
Relocated Gates of Heaven	1	1	2
Picnic area in urban meadow	2		

- Don't like perched beach – prefer natural sand beach to water
- Concern about playground being separate from picnic area
- 62-foot boats needs to be able to land at the boathouse dock
- Placement of shelter is favorite
- Don't like extended shoreline in front of boathouse

- Add bathroom in 'active area' [west side of the park]
- Like the idea of cleaner water but not for too high a price tag at the expense of others
- Access to boathouse is not doable in this concept
- Community gardens- high interest from adjoining neighbors and perhaps the only possible space to put them
- Terrace behind city houses, Collins and other 2 homes
- Move Gates of Heaven
- Not sure about this location [for volleyball court] – move closer to beach?
- Concerned about moving shoreline away from the boat house (please consider UW boathouse)
- Concerned about awkward docking for shells
- Don't like basketball courts in this location, prefer option B
- Would prefer public docks or mooring to provide access from lake to park
- We like shelter [and opportunity for] café and rentals
- Like: parking adjacent to street
- Like: cluster recreation
- No: moving Gates of Heaven
- Like: passive recreation on east side
- No: losing too much open space
- No: approach to boat house is not functional as shown for rowing club
- Like: café in park shelter
- Thought: grade transitions exterior to building, not just elevators inside