

MILLER AVENUE

ATWOOD AVENUE

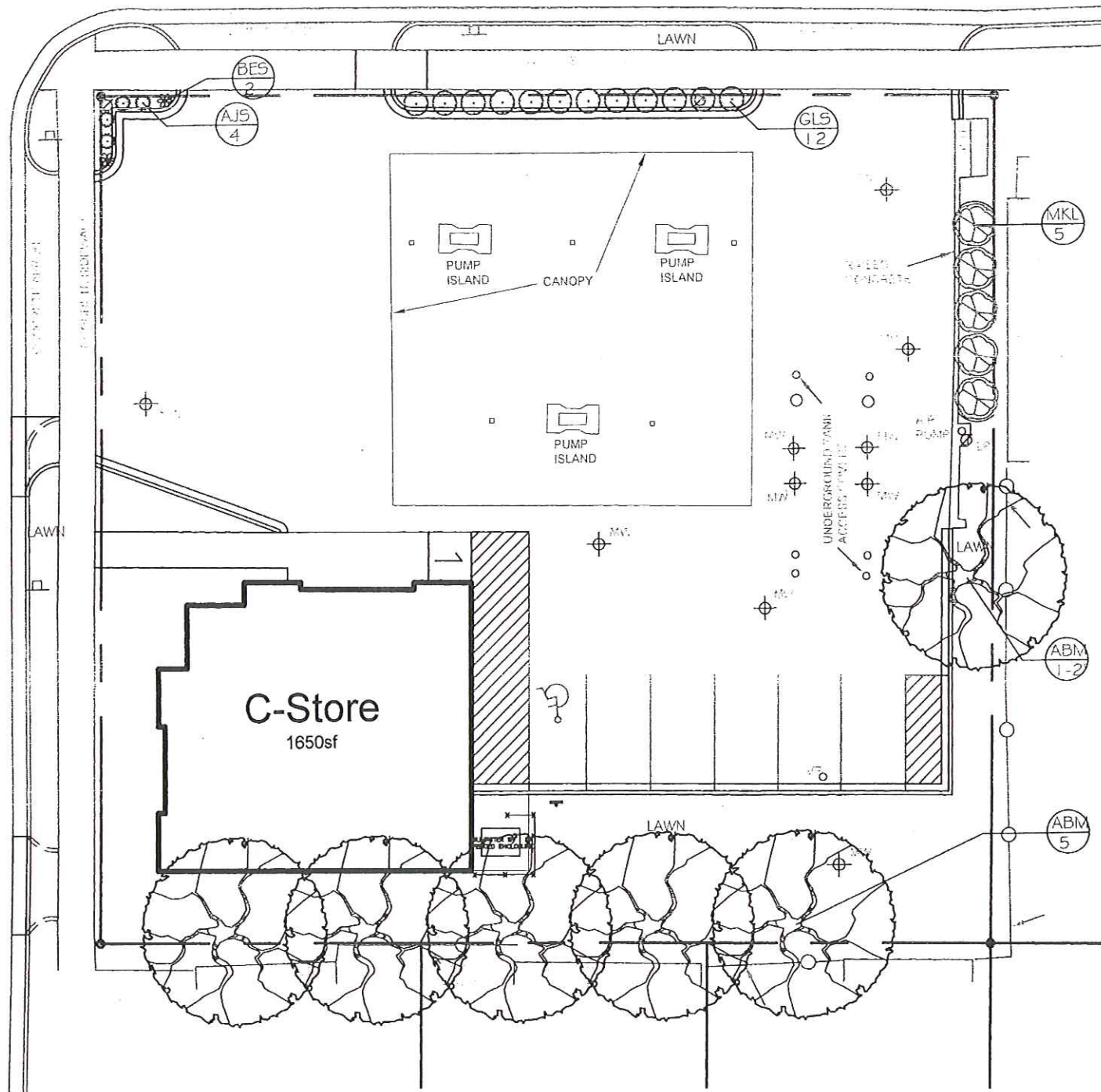

PLAN NOTES:

ALL TOPSOIL TO BE IN PLACE TO WITHIN 1" OF FINAL GRADE BEFORE DECORATIVE LANDSCAPING STARTS

BEDS SHALL HAVE BORDER OF DIMEX PRO LANDSCAPE EDGING EXCEPT THOSE WITHIN CONCRETE BORDERS.

ALL OUTER PLANTS TO RECEIVE 3' RING OF 3" DEPTH SHREDDED BARK MULCH. BEDS TO RECEIVE BARK MULCH, TYPAR, EDGING.

LAWN: SHALL BE FINE GRADED, FERTULIZED, SEEDED AND MULCHED

PLANTS SHALL BE MAINTAINED AT A MAX. HT. OF 2' NEAR DRIVE OPENINGS.

PLANT LIST

TREES		QUANTITY		SIZE	ROOT
ABM	ACER X FREEMANII 'JEFFERSRED'	5	1 1/2"	BB	
ABM	ACER X FREEMANII 'JEFFERSRED'	1	2"	BB	
SHRUBS					
GLS	RHUS AROMATICA 'GRO-LOW'	12	#2	CG	
MKL	SYRINGA PATULA 'MISS KIM'	5	#7	CG	
EVERGREEN					
PERENNIALS					
AJS	SEDUM 'AUTUMN JOY'	4	#1	CG	
BES	RUDBECKIA 'GOLDSTRUM'	2	#1	CG	

The owner retains the property of the information contained herein. The contractor shall be responsible for obtaining all necessary permits and for compliance with all applicable laws, codes, and regulations. The contractor shall be responsible for the accuracy of the information provided herein. The contractor shall be responsible for the accuracy of the information provided herein. CALL YOUR LOCAL UTILITY

McKAY NURSERY COMPANY
 800 BOY AVE. 750 S. MONROE ST. WATERLOO, WI 53094
 608-798-2121 WWW.MCKAYNURSERY.COM
 REP: MCKAY NURSERY CO REPRESENTATIVE

LANDSCAPE PLAN
 BP ATWOOD AVE / SUPREME STRUCTURES
 2801 ATWOOD AVE. MADISON, WI

S. DEVALET
 187-07
 5/07
 1" = 20'
 ATWOOD SUPREME 200M